

www.teknikoffice.co.uk

Teknik

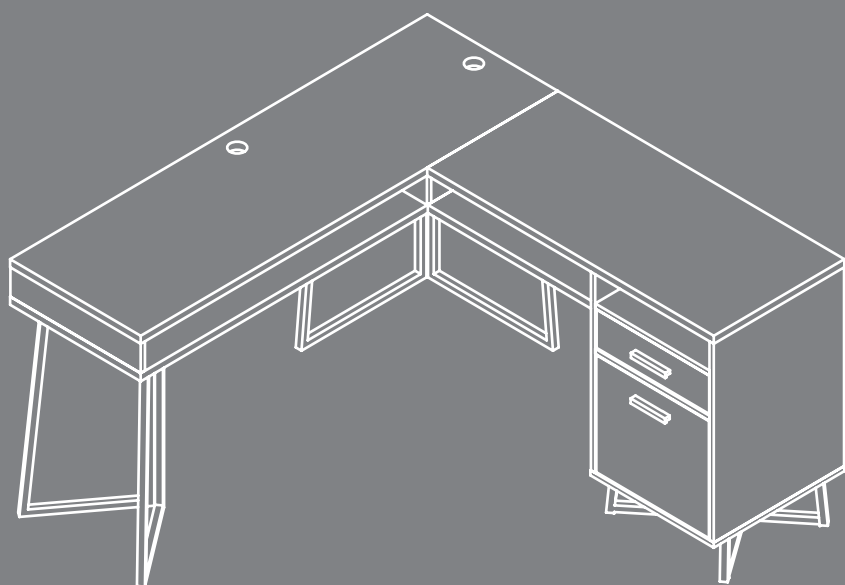

For **all** your
newfangled **gadgetry**.

Canyon Lane L-Shaped Desk

Model 5431209

NOTE: THIS INSTRUCTION
BOOKLET CONTAINS **IMPORTANT**
SAFETY INFORMATION.

PLEASE READ AND KEEP FOR
FUTURE REFERENCE.

Lot # **575155**

Purchased: _____

12/13/21

Table of Contents

Assembly Tools Required

Part Identification	2-3
Hardware Identification	4-5
Hardware Usage Guide	6
Assembly Steps	6-44
Français	45-50
Español	51-56
Safety	57-58
Warranty	59

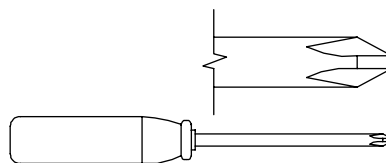

No. 2 Phillips Screwdriver
Tip Shown Actual Size

Part Identification

† While not all parts are labeled, some of the parts will have a label or an inked letter on the edge to help distinguish similar parts from each other. Use this part identification to help identify similar parts.

A	LARGE TOP (1)	M	FIXED SHELF (1)	Z	RIGHT DRAWER SIDE (1)
B	SMALL TOP (1)	N	BACK (1)	AA	LARGE DRAWER BOTTOM (1)
C	LARGE SHELF (1)	O	FILE DRAWER FRONT (1)	BB	CORNER LEG (1)
D	SMALL SHELF (1)	P	FILE DRAWER BACK (1)	CC	LEFT LEG (1)
E	LEFT UPRIGHT (1)	Q	FILE LEFT DRAWER SIDE (1)	DD	FOOT BRACE (1)
F	RIGHT UPRIGHT (1)	R	FILE RIGHT DRAWER SIDE (1)	EE	FOOT (4)
G	LONG BACK (1)	S	FILE DRAWER BOX FRONT (1)	FF	LEG BRACKET (2)
H	SHORT BACK (1)	V	SMALL DRAWER BOTTOM (1)	GG	LEG BRACE (1)
J	LEFT END (1)	W	DRAWER FRONT (1)	HH	LONG BRACE (1)
K	RIGHT END (1)	X	DRAWER BACK (1)	JJ	SHORT BRACE (1)
L	BOTTOM (1)	Y	LEFT DRAWER SIDE (1)	KK	SHELF (1)

Part Identification

Now you know
our ABCs.

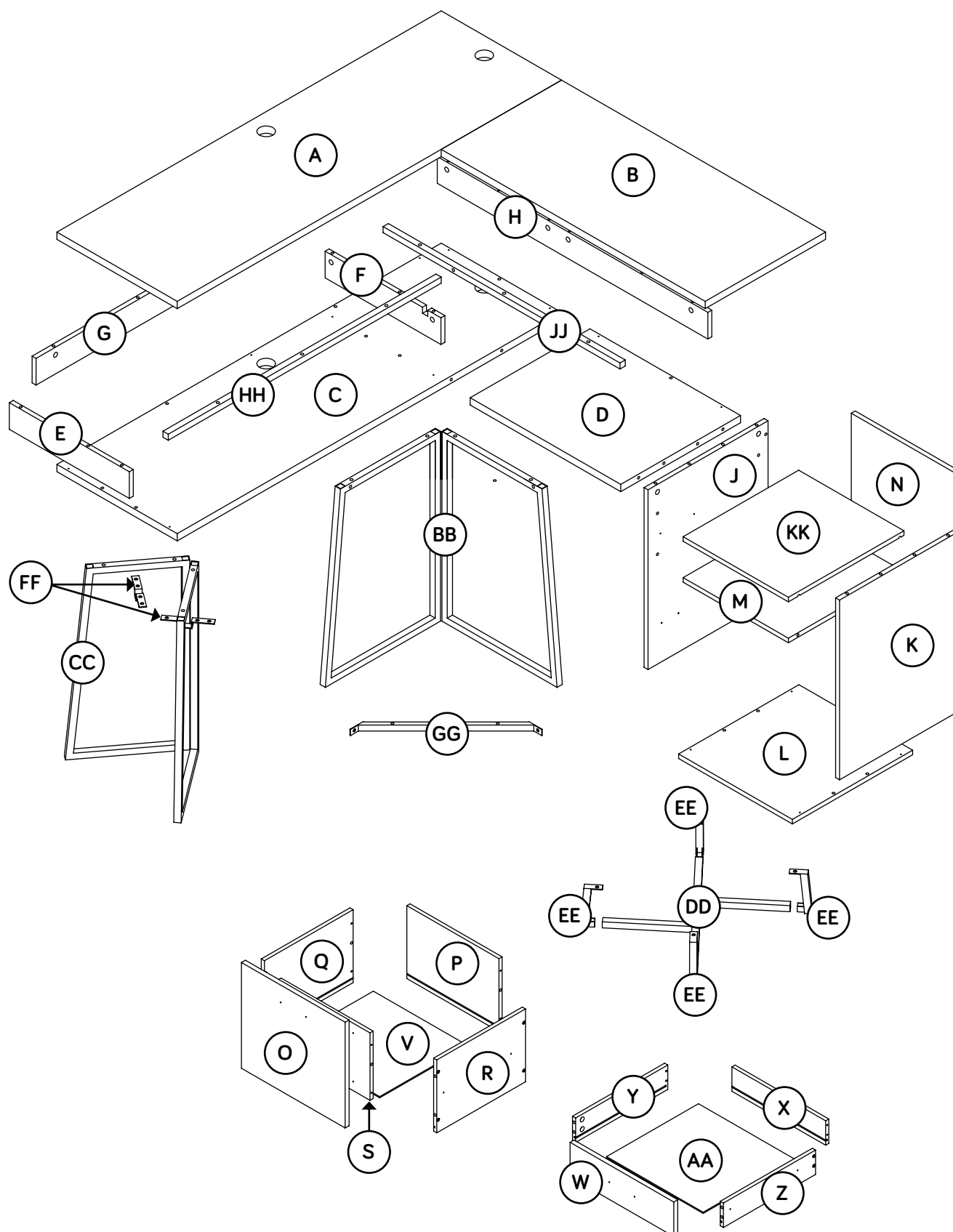
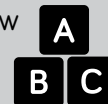

Hardware Identification

⚠ Screws are shown actual size. You may receive extra hardware with your unit.

(EXTENSION SET SHOWN SEPARATED)

1 WIDE EXTENSION
RAIL - 2

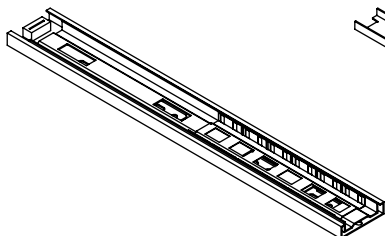

2 WIDE EXTENSION
SLIDE - 2

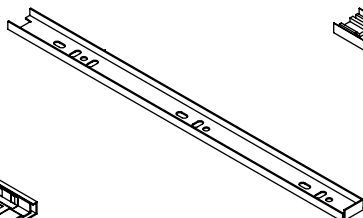

(EXTENSION SET SHOWN SEPARATED)

3 NARROW EXTENSION
RAIL - 2

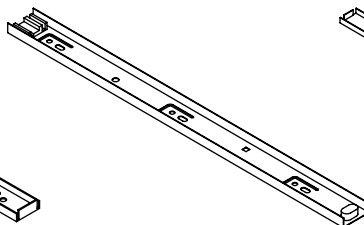

4 NARROW EXTENSION
SLIDE - 2

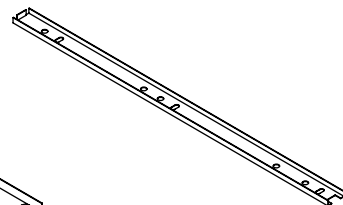

5 HIDDEN CAM - 25

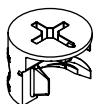

6 CAM SCREW - 25

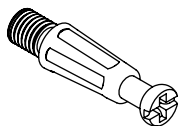

7 LARGE WOOD
DOWEL - 40

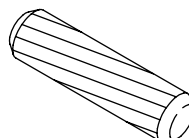

8 SMALL WOOD
DOWEL - 8

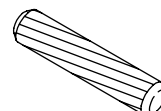

9 FILE GLIDE - 2

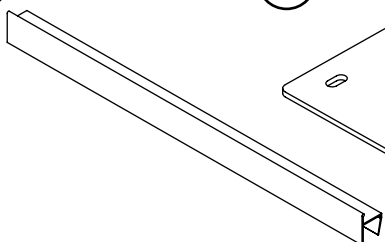

10 PLATE - 1

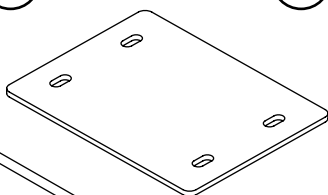

11 PULL - 2

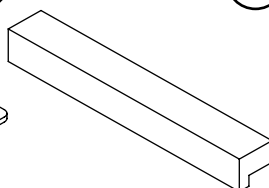

12 GROMMET - 2

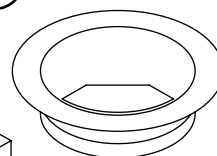

13 CORD CLIP - 2

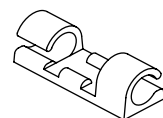

14 APPLIQUE
CARD - 2

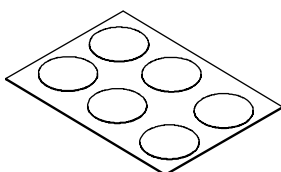

15 L-WRENCH - 1

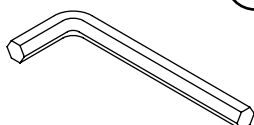

24 SHELF PIN - 4

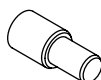

HIDDEN WIRELESS Qi COMPATIBLE
CHARGER by EGGTRONIC - Item 425905
(sold separately)

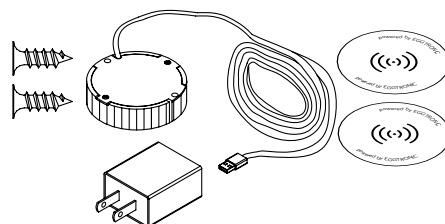

Hardware Identification

† Screws are shown actual size. You may receive extra hardware with your unit.

16 2" PAN HEAD SCREW - 15

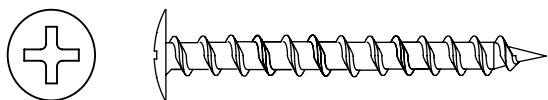

17 1-3/16" HEX HEAD SCREW - 17

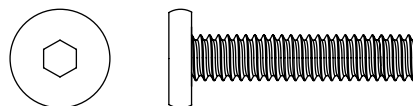

18 1-3/16" FLAT HEAD SCREW - 12



19 7/8" PAN HEAD SCREW - 4

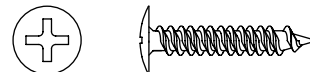

20 13/16" MACHINE SCREW - 4

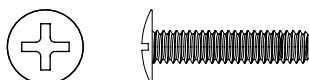

21 1/2" HEX HEAD SCREW - 18

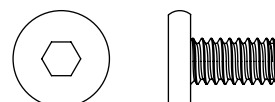

22 1/2" FLAT HEAD SCREW - 24

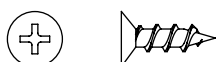

23 1/2" PAN HEAD SCREW - 4



Hardware Usage Guide

HOW TO USE A HIDDEN CAM & CAM SCREW OR CAM DOWEL

1. NOTE: Various CAM SCREWS or a CAM DOWEL may be used.

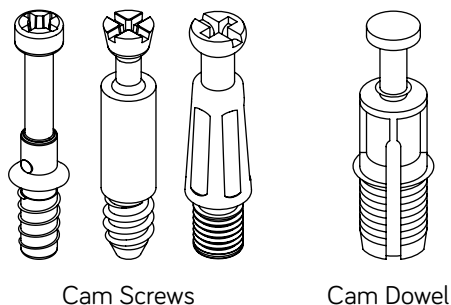

Turn the CAM SCREW or gently tap the CAM DOWEL until the shoulder is against the surface of the part.

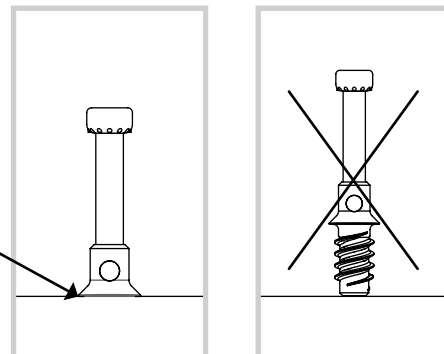

- 2.

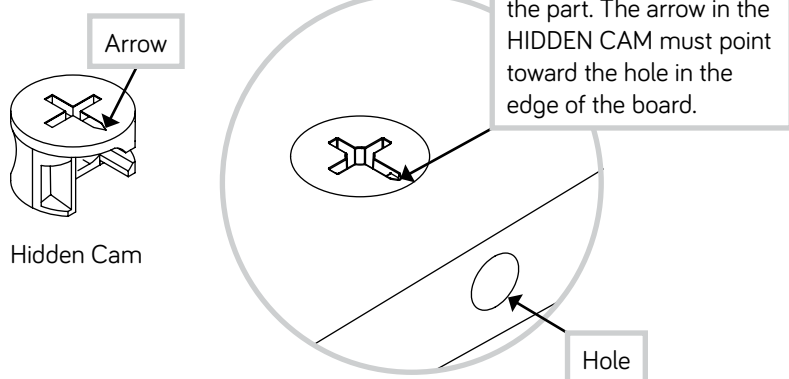

- 3.

Insert the CAM SCREW or CAM DOWEL into the HIDDEN CAM. Tighten the HIDDEN CAM.

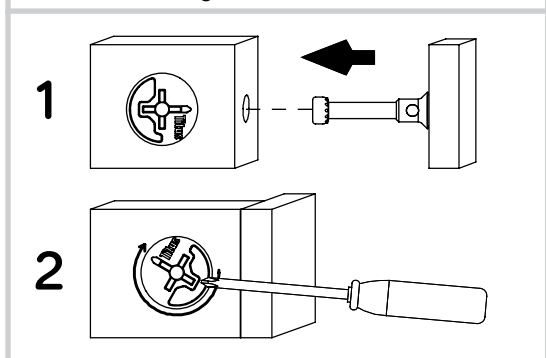

Step 1

- ✚ Assemble your unit on a carpeted floor or on the empty carton to avoid scratching your unit or the floor.
- ✚ Turn two CAM SCREWS (6) into the LEFT END (J).
- ✚ Carefully flip the LEFT END (J) over.
- ✚ Turn two CAM SCREWS (6) into this surface of the LEFT END (J).
- ✚ Push two HIDDEN CAMS (5) into the LEFT END (J).



Some assembly
(and snacks) required.

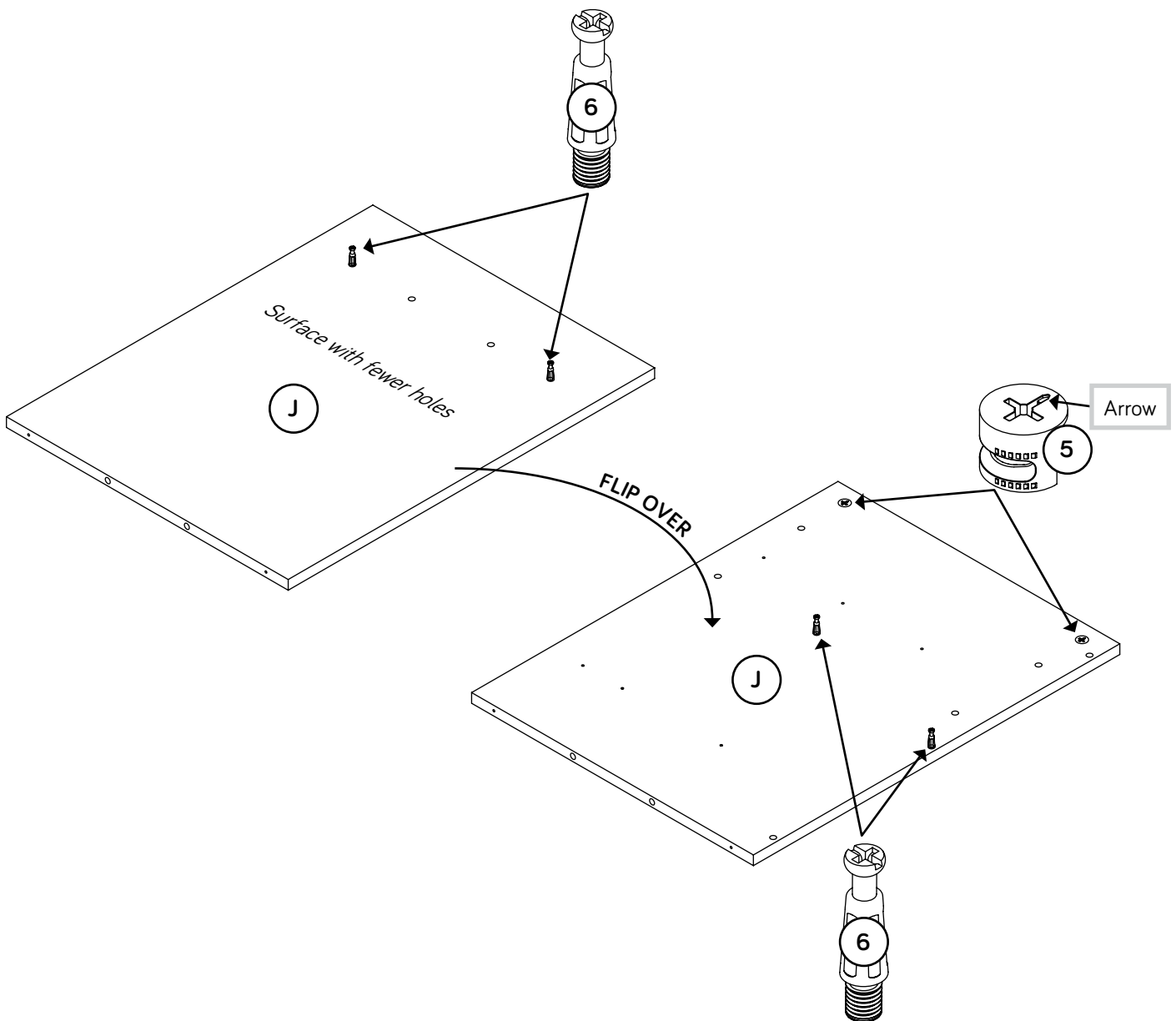

Step 2

- ✚ Separate the NARROW EXTENSION SLIDES (4) from the NARROW EXTENSION RAILS (3) as shown in the upper diagram below. Be prepared, the parts are greasy.
- ✚ Fasten one NARROW EXTENSION RAIL (3) to the LEFT END (J). Use three 1/2" FLAT HEAD SCREWS (22).
- ✚ **NOTE:** For the EXTENSION RAIL, turn a SCREW into the hole shown in the enlarged diagram. Then, slide the inner cartridge of the EXTENSION RAIL in to find the other holes that line up with the holes in the END. Turn a SCREW into these holes.
- ✚ **NOTE:** The NARROW EXTENSION SLIDES will be used later for the DRAWER.

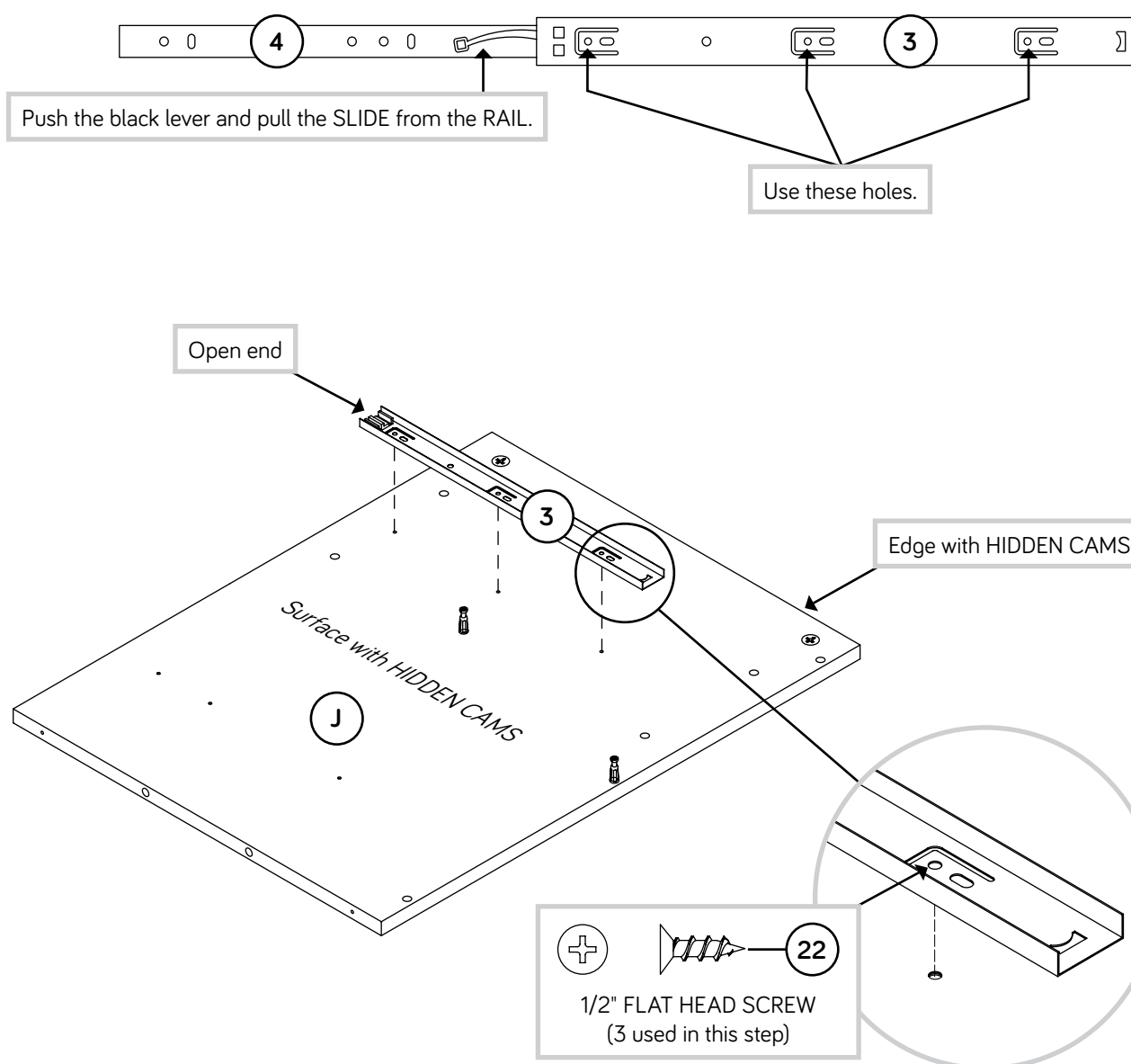

Step 3

- ✚ Separate the WIDE EXTENSION SLIDES (2) from the WIDE EXTENSION RAILS (1) as shown in the upper diagram below. Be prepared, the parts are greasy.
- ✚ Fasten one WIDE EXTENSION RAIL (1) to the LEFT END (J). Use three 1/2" FLAT HEAD SCREWS (22).
- ✚ NOTE: For the EXTENSION RAIL, turn a SCREW into the hole shown in the enlarged diagram. Then, slide the inner cartridge of the EXTENSION RAIL in to find the other holes that line up with the holes in the END. Turn a SCREW into these holes.
- ✚ NOTE: The WIDE EXTENSION SLIDES will be used later for the FILE DRAWER.

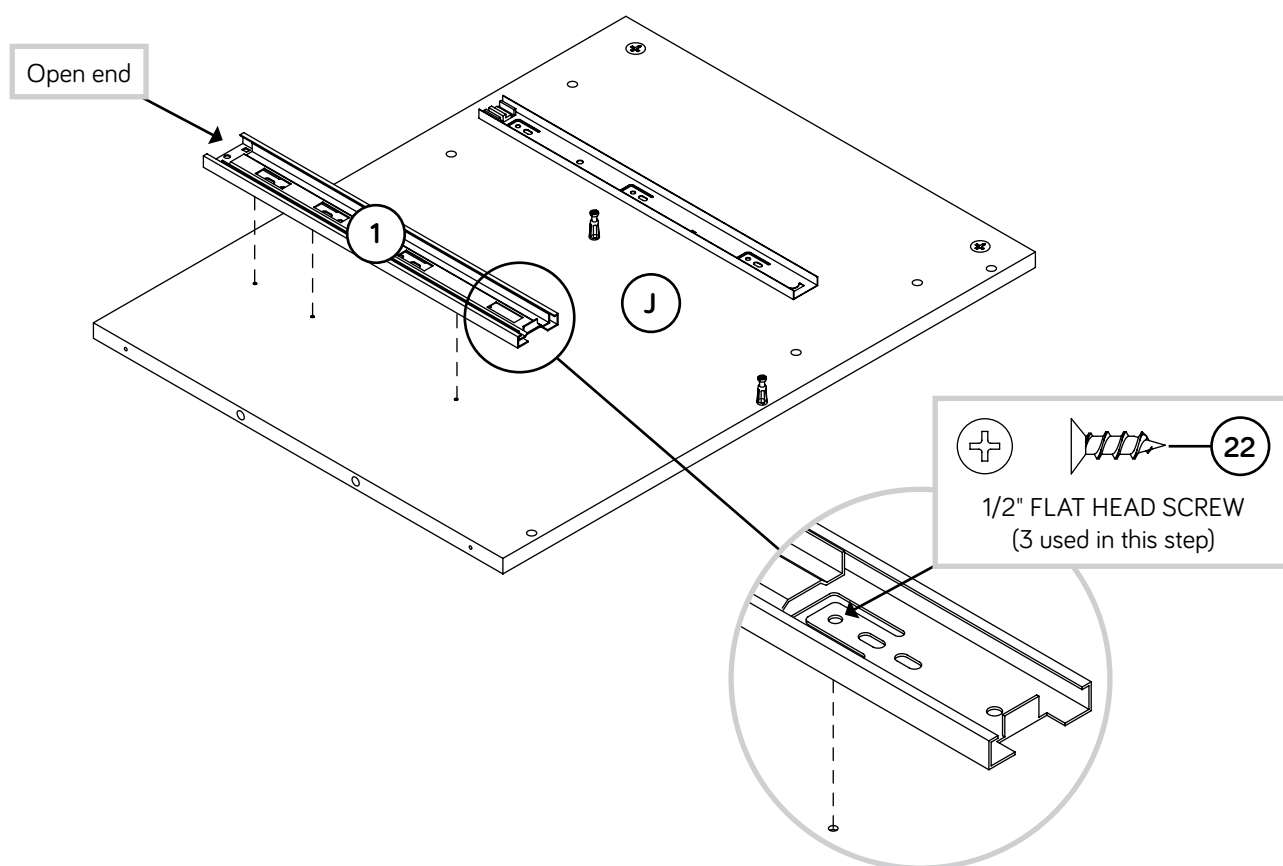
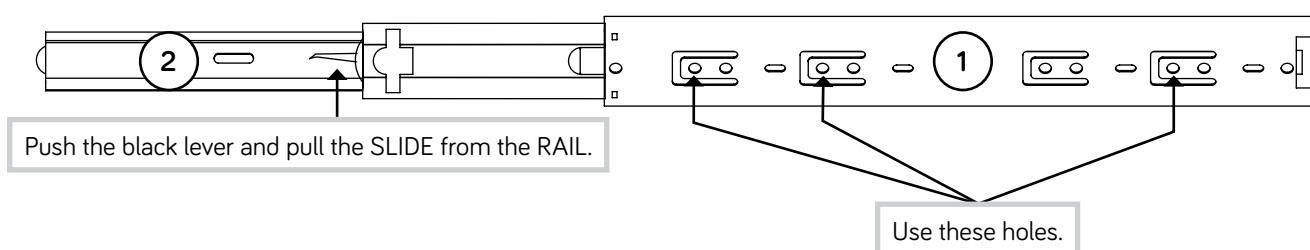

Step 4

- ✚ Push two HIDDEN CAMS (5) into the BACK (N).
- ✚ Insert two LARGE WOOD DOWELS (7) into the LEFT END (J).
- ✚ Fasten the BACK (N) to the LEFT END (J). Tighten one HIDDEN CAM.
- ✚ **NOTE:** Be sure the WOOD DOWELS in the END insert into the BACK.

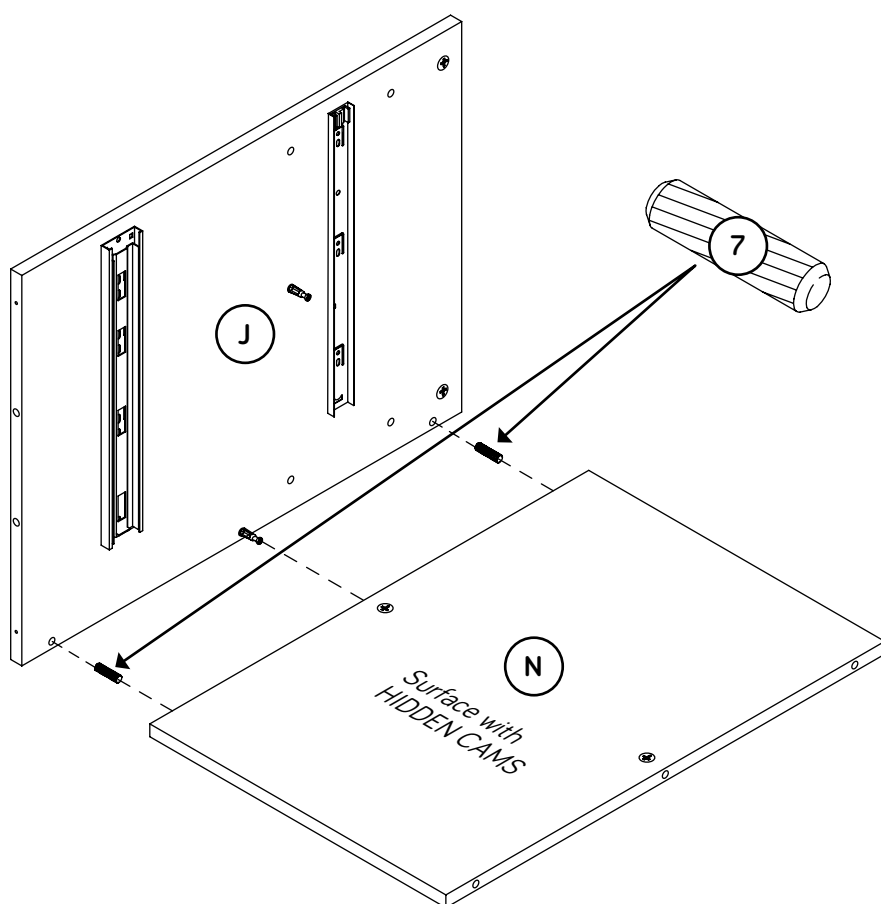
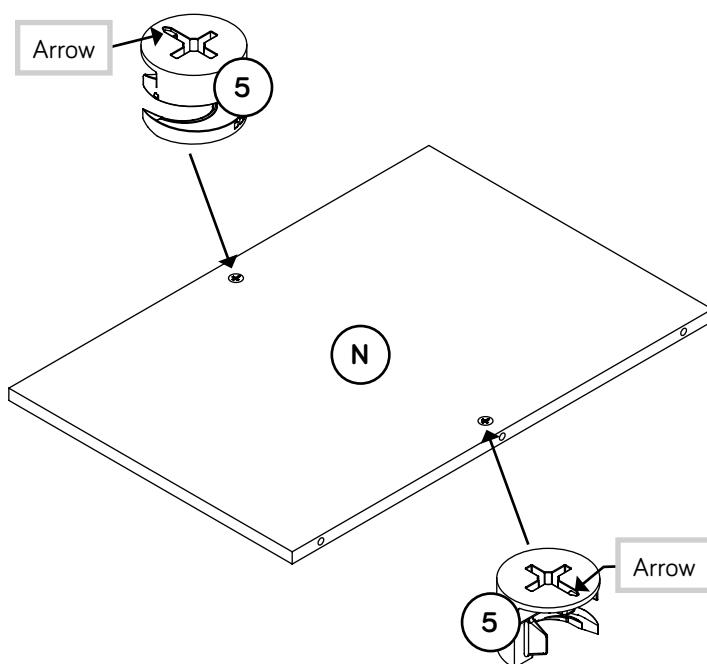

Step 5

- ✚ Push two HIDDEN CAMS (5) into the FIXED SHELF (M).
- ✚ Insert two LARGE WOOD DOWELS (7) into the LEFT END (J).
- ✚ Fasten the FIXED SHELF (M) to the LEFT END (J). Tighten one HIDDEN CAM.
- ✚ NOTE: Be sure the WOOD DOWELS in the END insert into the SHELF.

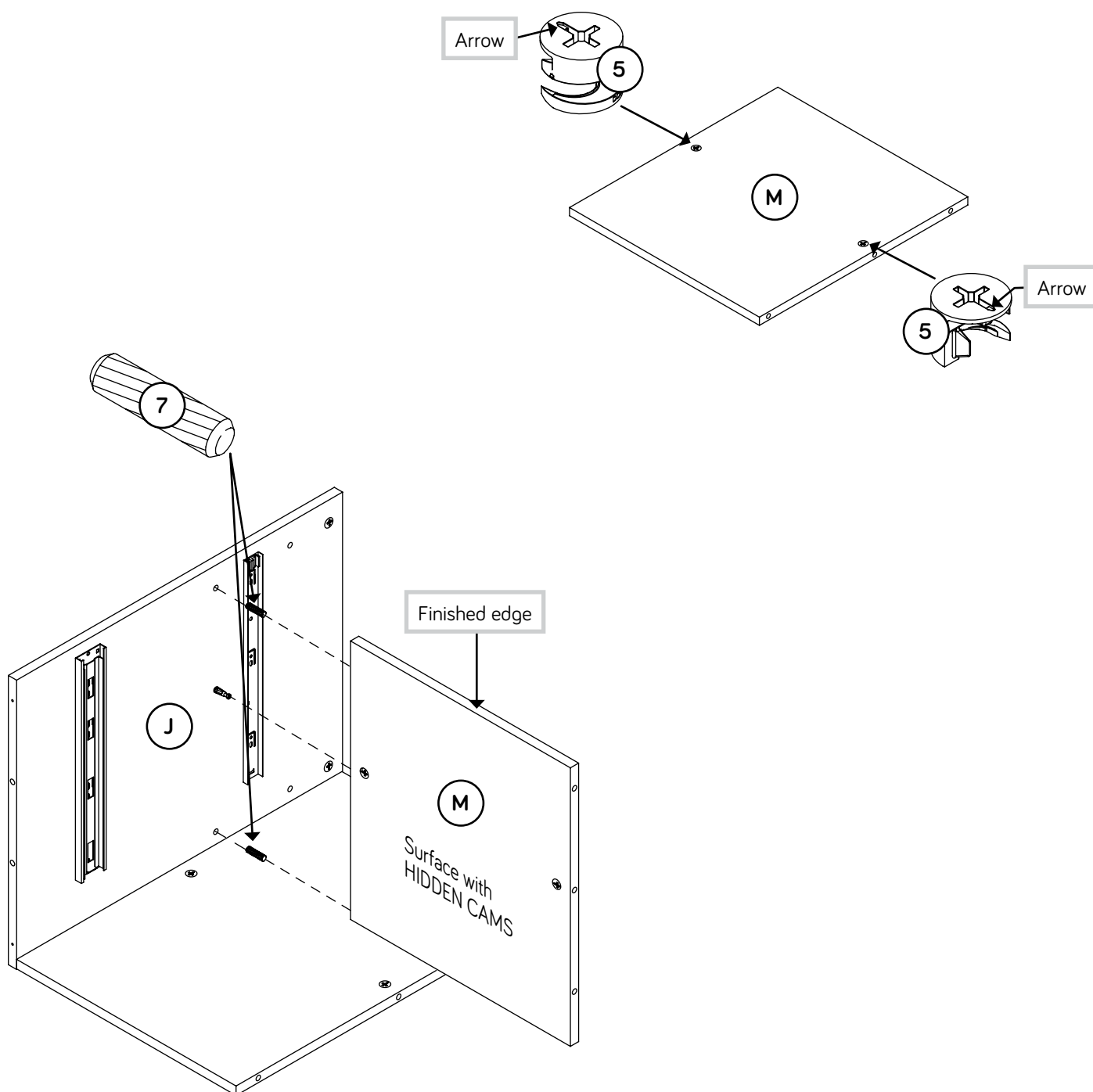

Step 6

- ✚ Turn two CAM SCREWS (6) into the RIGHT END (K).
- ✚ Push two HIDDEN CAMS (5) into the RIGHT END (K).

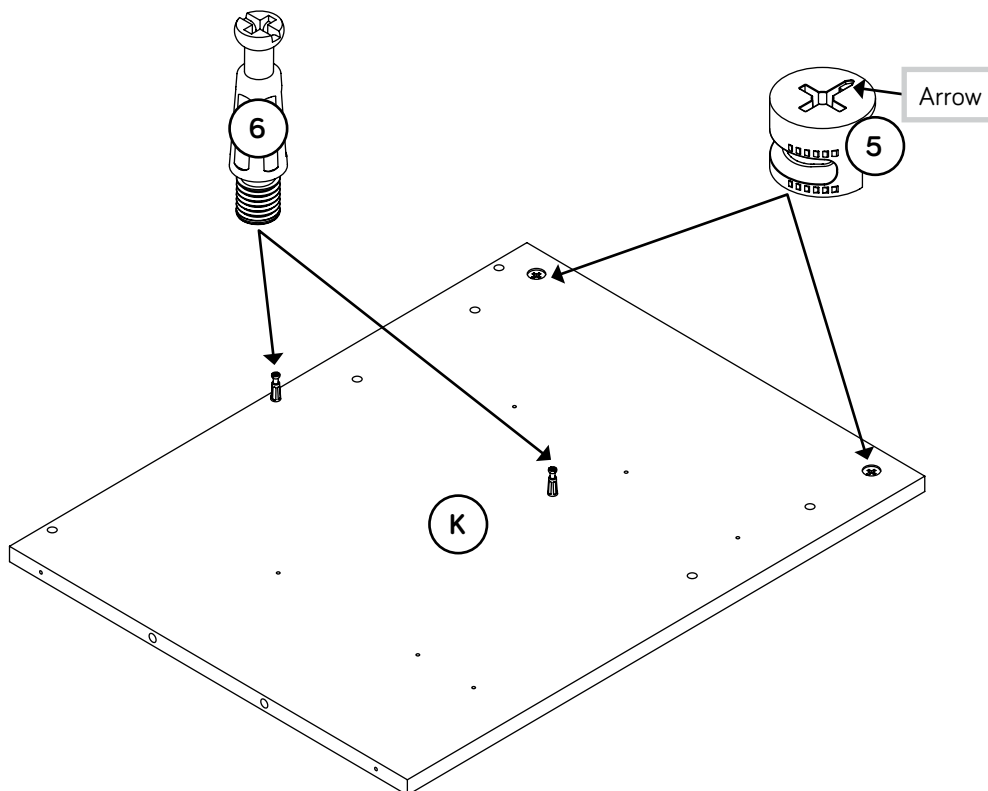

Step 7

- Fasten one NARROW EXTENSION RAIL (3) to the RIGHT END (K). Use three 1/2" FLAT HEAD SCREWS (22).

- NOTE:** For the EXTENSION RAIL, turn a SCREW into the hole shown in the enlarged diagram. Then, slide the inner cartridge of the EXTENSION RAIL in to find the other holes that line up with the holes in the END. Turn a SCREW into these holes.

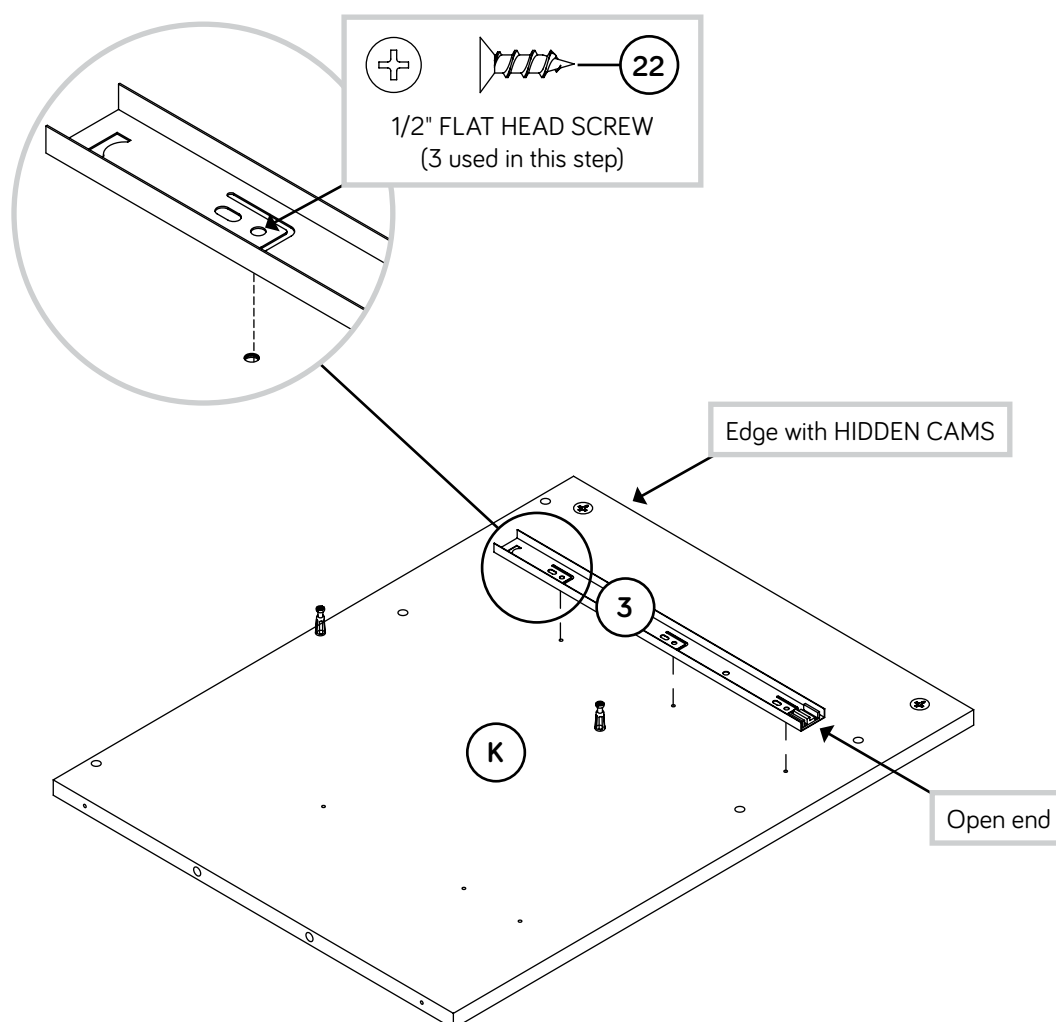

Step 8

- Fasten one WIDE EXTENSION RAIL (1) to the RIGHT END (K).
Use three 1/2" FLAT HEAD SCREWS (22).

NOTE: For the EXTENSION RAIL, turn a SCREW into the hole shown in the enlarged diagram. Then, slide the inner cartridge of the EXTENSION RAIL in to find the other holes that line up with the holes in the END. Turn a SCREW into these holes.

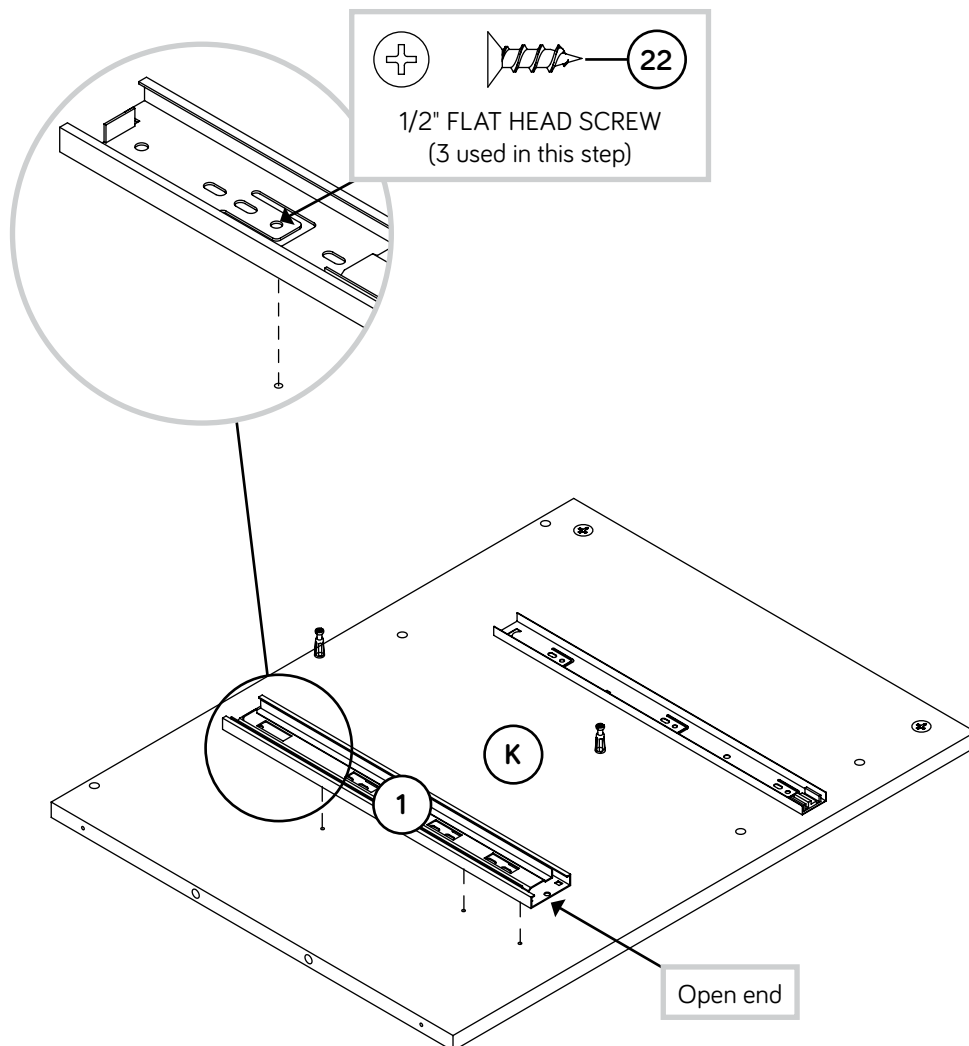

Step 9

- ✚ Insert four LARGE WOOD DOWELS (7) into the RIGHT END (K).
- ✚ Fasten the RIGHT END (K) to the FIXED SHELF (M) and BACK (N).
Tighten two HIDDEN CAMS.
- ✚ **NOTE:** Be sure the WOOD DOWELS in the END insert into the SHELF and BACK.

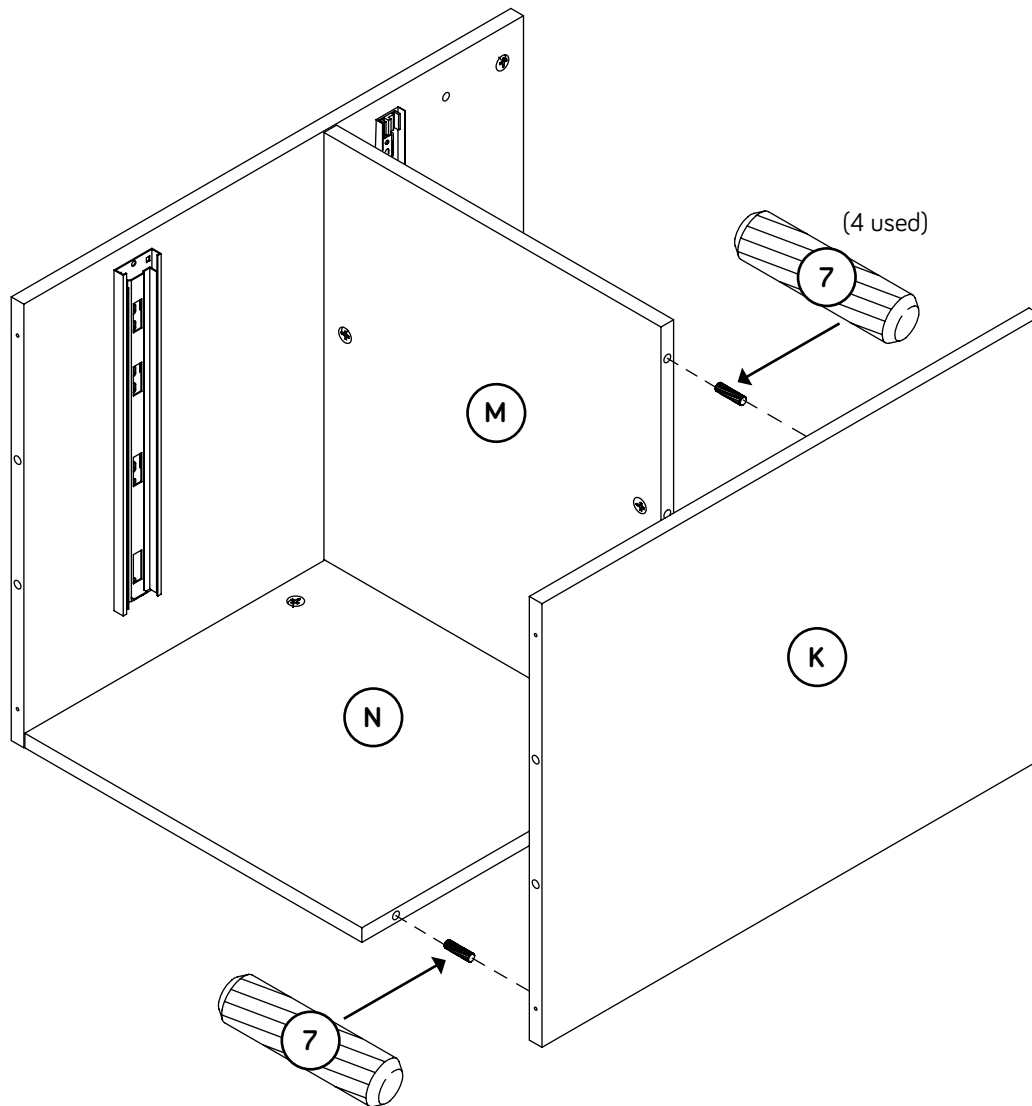

Step 10

- ✚ Insert four LARGE WOOD DOWELS (7) into the BOTTOM (L).
- ✚ Fasten the BOTTOM (L) to the ENDS (J and K). Use four 2" PAN HEAD SCREWS (16).
- ✚ NOTE: You should start each SCREW a few turns before completely tightening any of them.
- ✚ NOTE: Be sure the WOOD DOWELS in the BOTTOM insert into the ENDS.

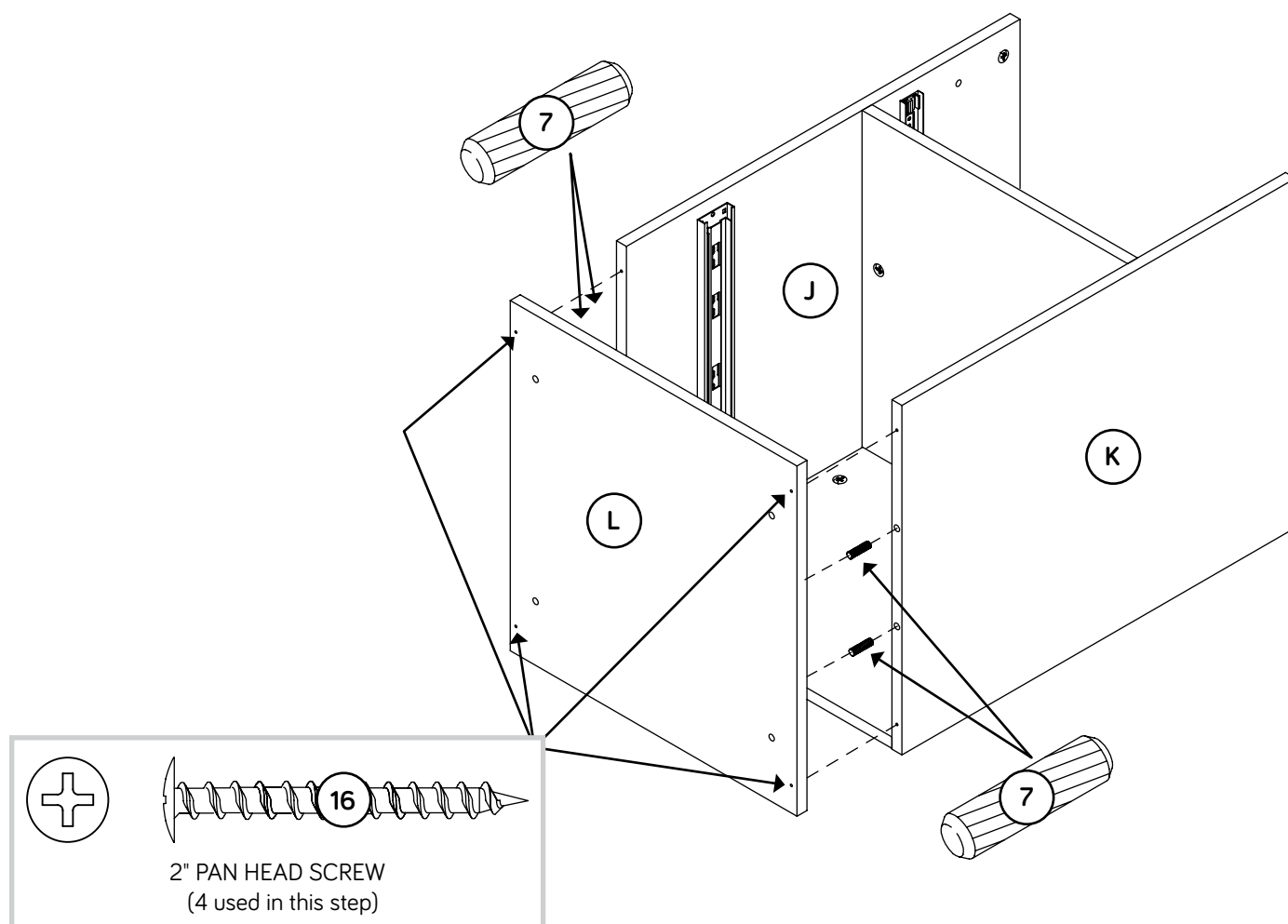

Step 11

- ✚ Insert three LARGE WOOD DOWELS (7) into the SMALL TOP (B).
- ✚ Push the LARGE TOP (A) onto the WOOD DOWELS in the SMALL TOP (B).
- ✚ Turn fifteen CAM SCREWS (6) into the TOPS (A and B).

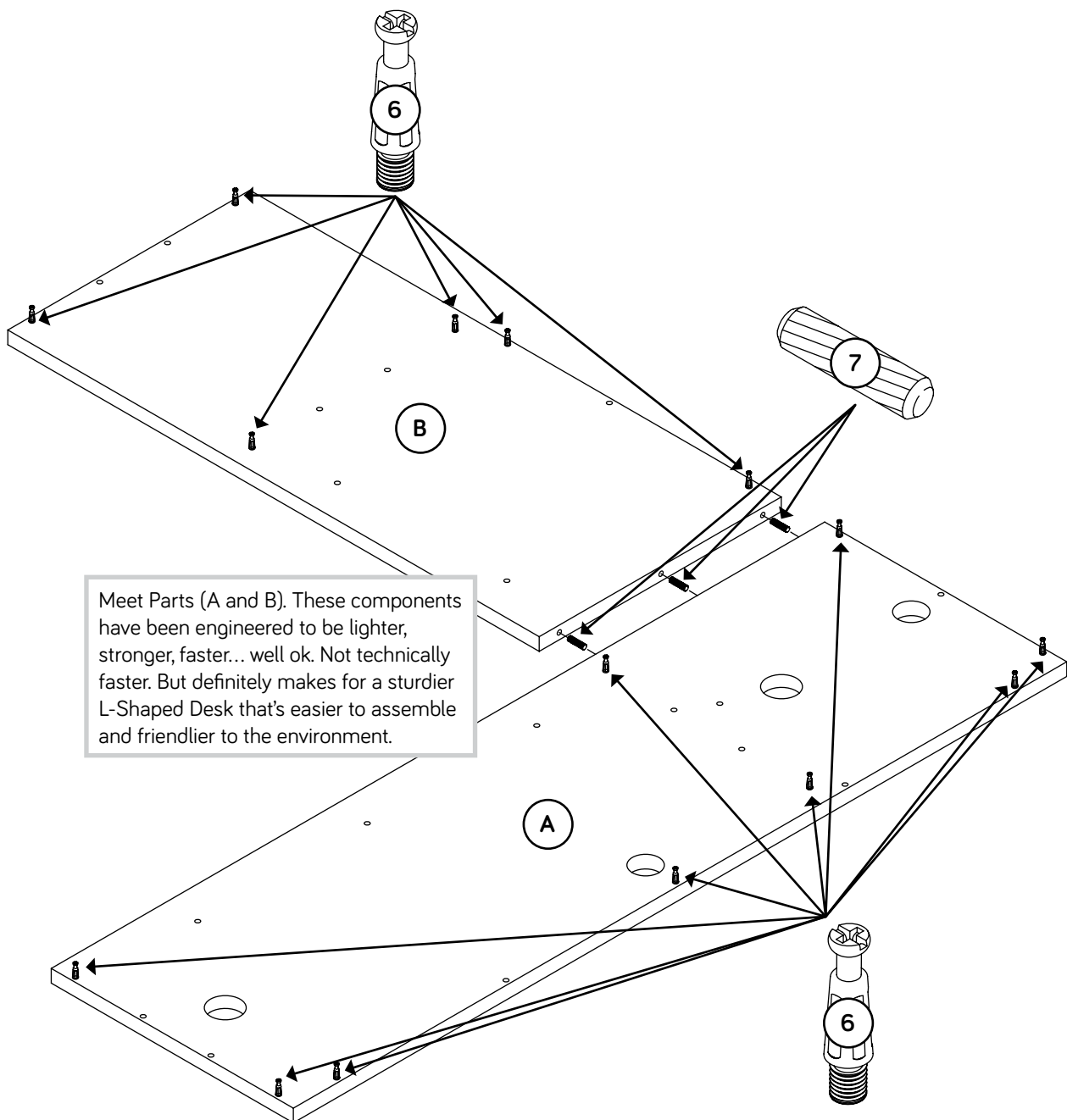

Step 12

- ⚠ NOTE: Do not completely tighten the SCREWS in this step.
- ⚠ Fasten the LONG BRACE (HH) to the LARGE TOP (A).
Tighten three 1-3/16" HEX HEAD SCREWS (17) using the L-WRENCH (15).
- ⚠ NOTE: You should start each SCREW a few turns to help line up the holes.

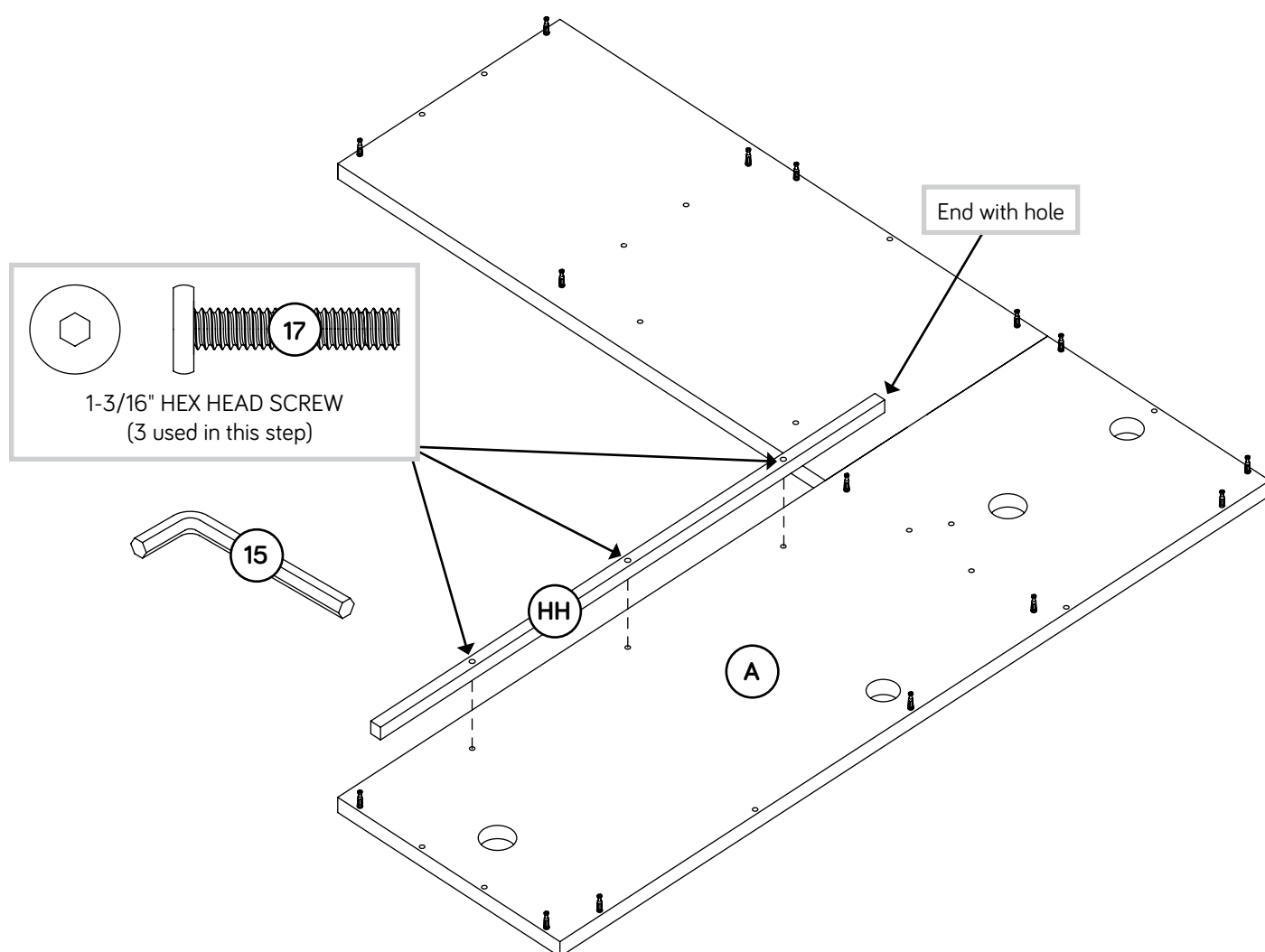

Step 13

- ✚ Fasten the SHORT BRACE (JJ) to the LONG BRACE (HH). Tighten one 1-3/16" HEX HEAD SCREW (17) using the L-WRENCH (15).
- ✚ Fasten the SHORT BRACE (JJ) to the TOPS (A and B). Tighten three 1-3/16" HEX HEAD SCREWS (17) using the L-WRENCH (15).
- ✚ NOTE: You should start each SCREW a few turns to help line up the holes.
- ✚ Completely tighten the SCREWS in the BRACES (HH and JJ).

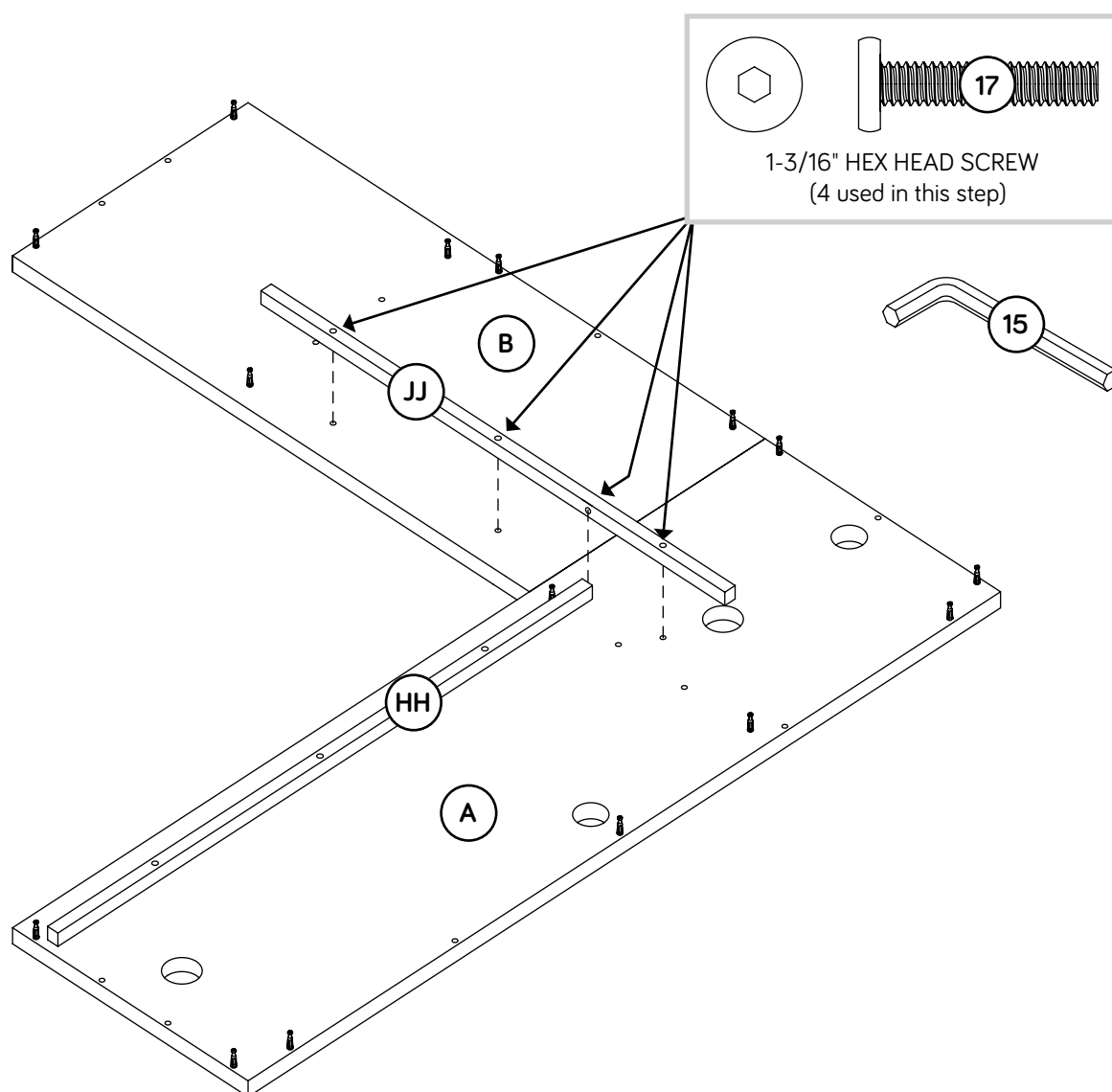

Step 14

- Push eleven HIDDEN CAMS (5) into the UPRIGHTS (E and F) and BACKS (G and H).

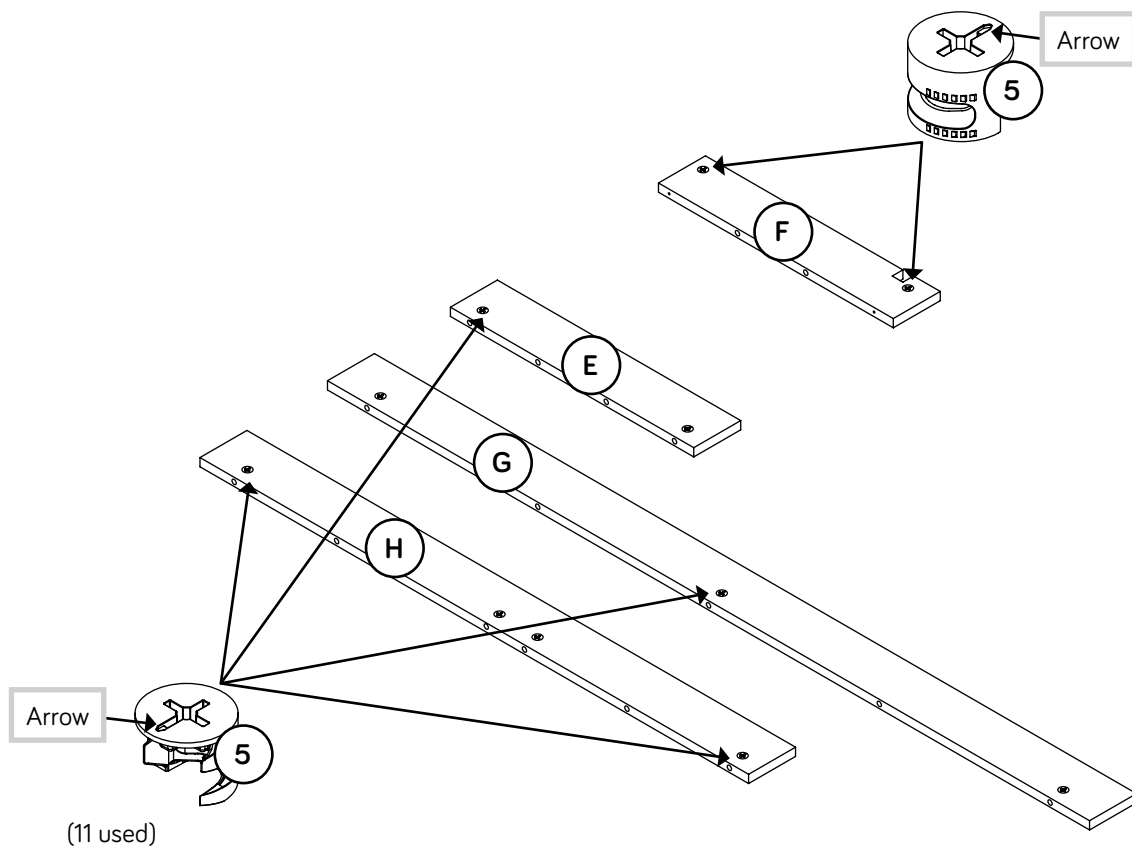



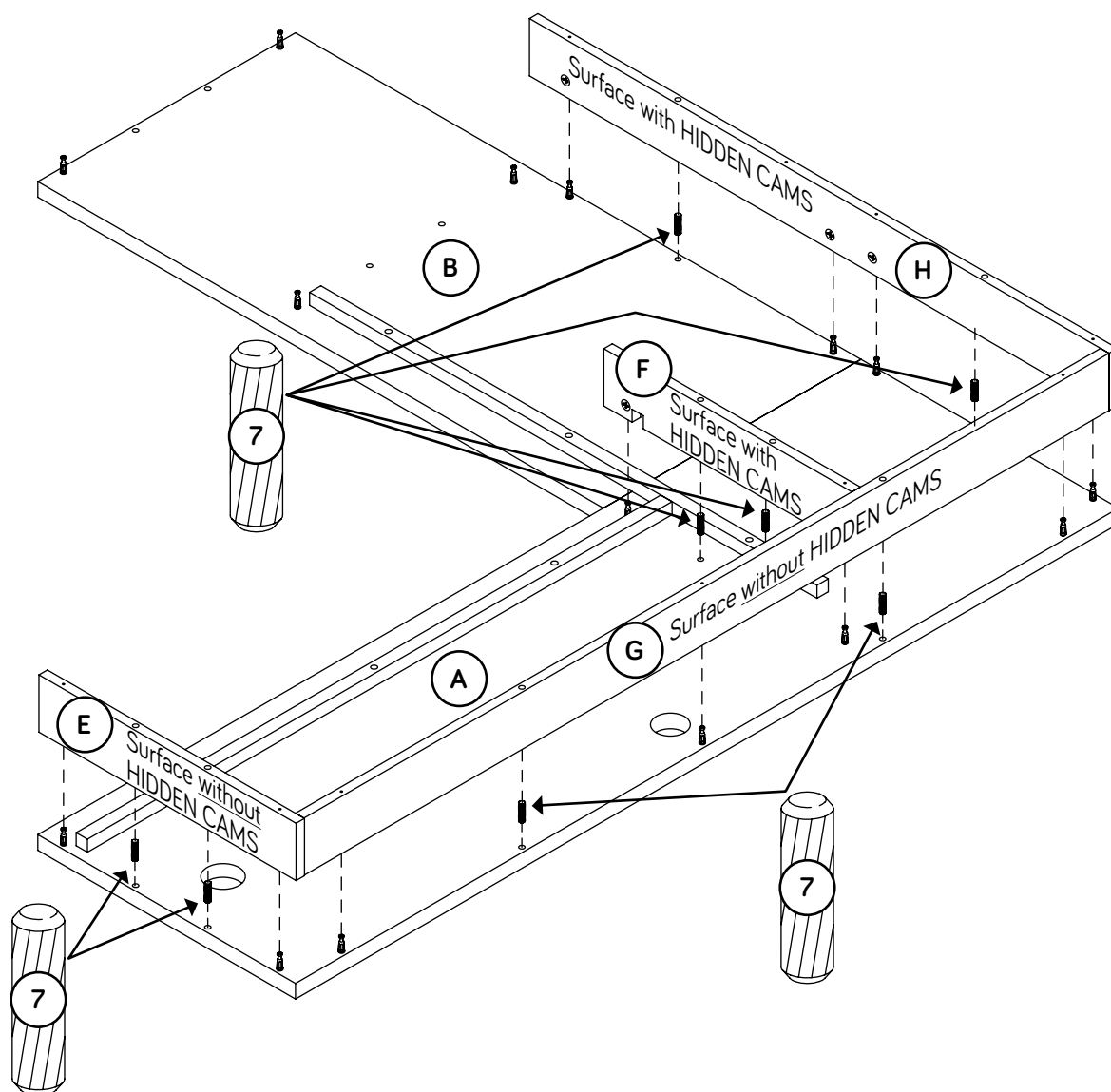

Step 15

- ✚ Insert eight LARGE WOOD DOWELS (7) into the TOPS (A and B).
- ✚ Fasten the UPRIGHTS (E and F) and LONG BACK (G) to the LARGE TOP (A). Tighten seven HIDDEN CAMS.
- ✚ Fasten the SHORT BACK (H) to the TOPS (A and B). Tighten four HIDDEN CAMS.
- ✚ NOTE: Be sure the WOOD DOWELS in the TOPS insert into the UPRIGHTS and BACKS.



Step 16

-  Insert four LARGE WOOD DOWELS (7) into the SMALL TOP (B).
-  Fasten the ENDS (J and K) to the SMALL TOP (B). Tighten four HIDDEN CAMS.
-  NOTE: Be sure the WOOD DOWELS in the TOP insert into the ENDS.
-  Insert eight LARGE WOOD DOWELS (7) into the UPRIGHTS (E and F) and BACKS (G and H).

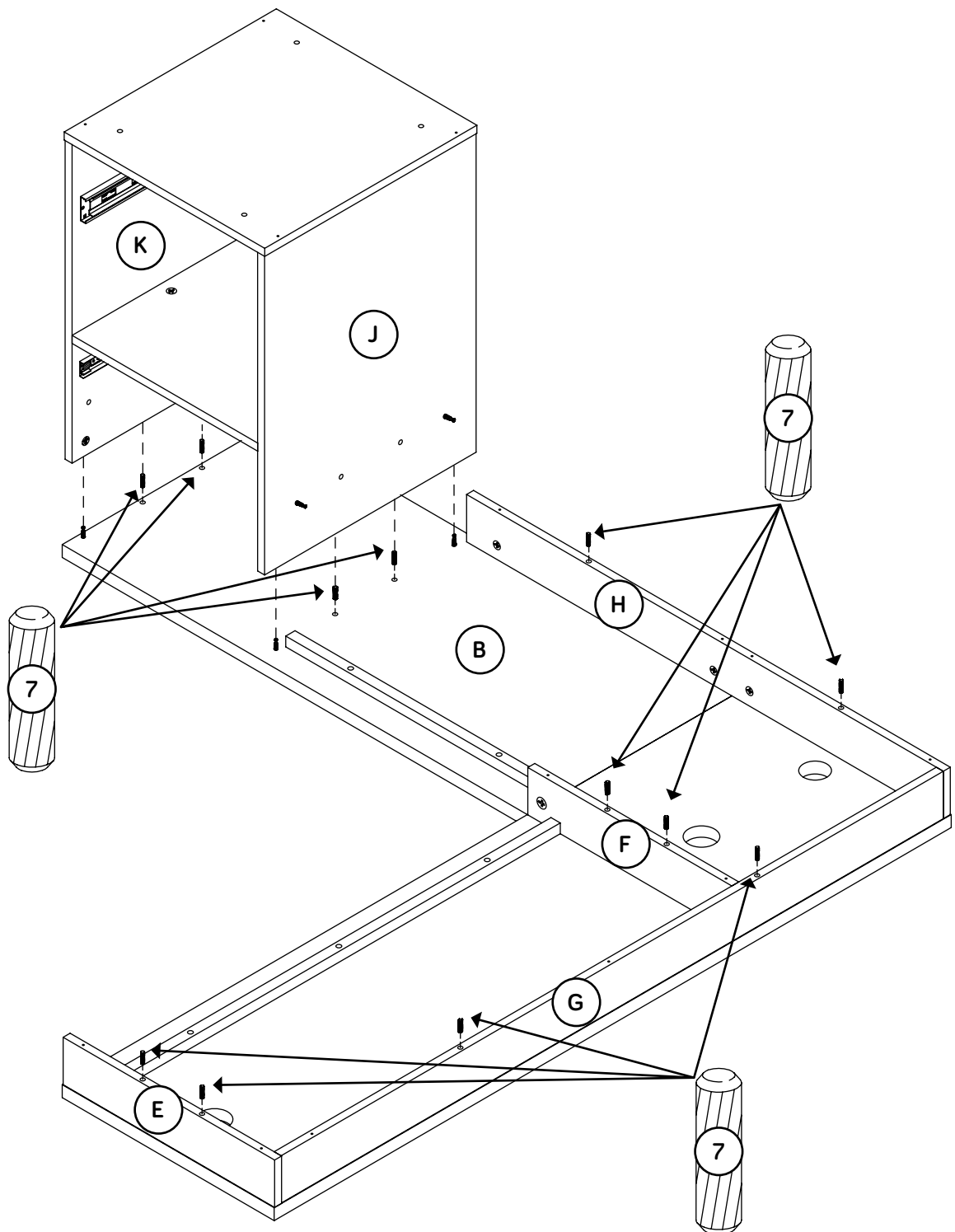

Step 17

- ✚ Push two HIDDEN CAMS (5) into the SMALL SHELF (D).
- ✚ Insert two LARGE WOOD DOWELS (7) into the LEFT END (J).
- ✚ Fasten the SMALL SHELF (D) to the LEFT END (J). Tighten two HIDDEN CAMS.
- ✚ NOTE: Be sure the WOOD DOWELS in the END insert into the SHELF.

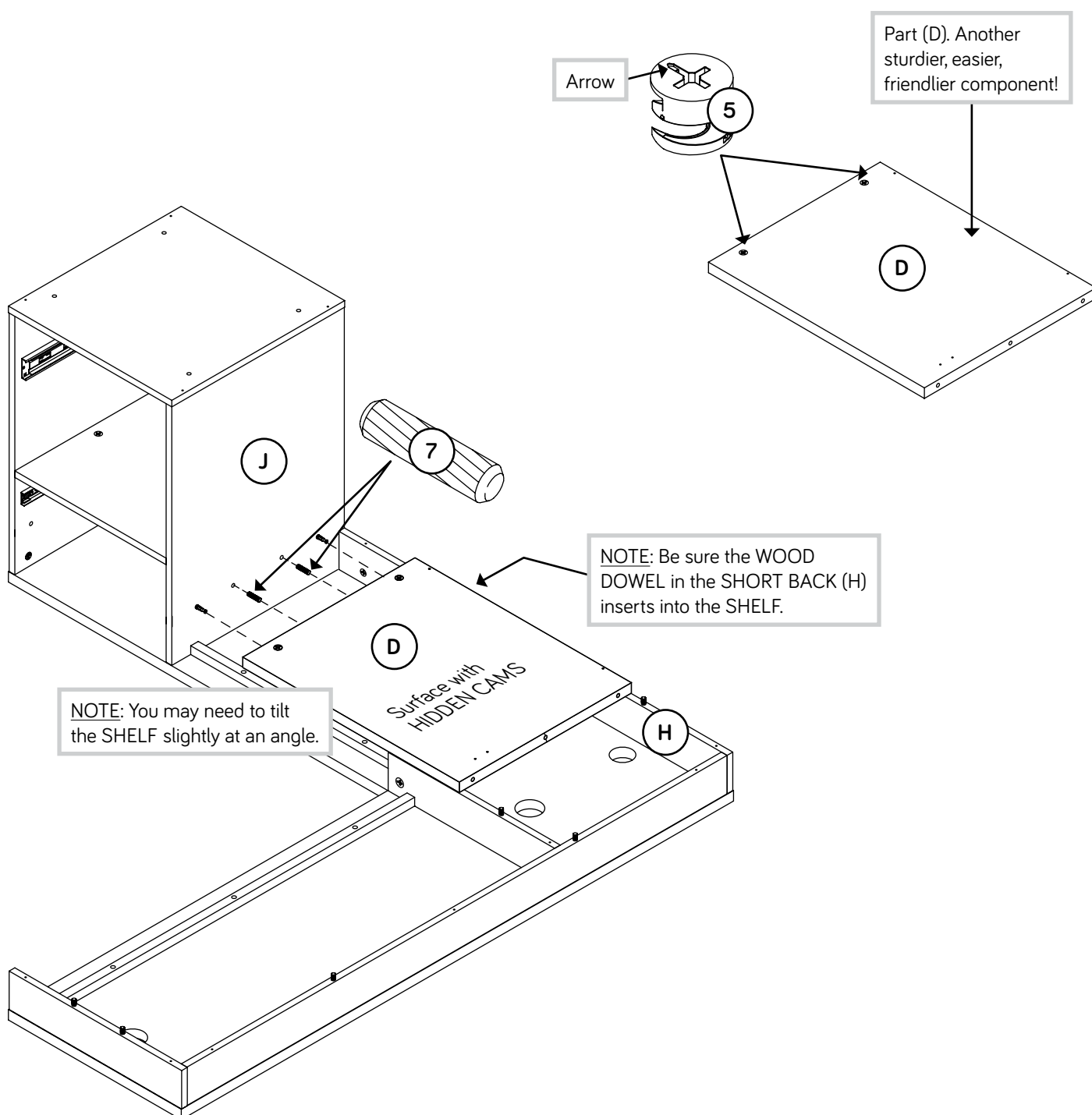

Step 18

- ✚ Insert three LARGE WOOD DOWELS (7) into the SMALL SHELF (D).
- ✚ Push the LARGE SHELF (C) onto the WOOD DOWELS in the SMALL SHELF (D).
- ✚ NOTE: Be sure the WOOD DOWELS in the UPRIGHTS and BACKS insert into the LARGE SHELF.
- ✚ Fasten the LARGE SHELF (C) to the UPRIGHTS (E and F) and BACKS (G and H). Use nine 2" PAN HEAD SCREWS (16).
- ✚ NOTE: You should start each SCREW a few turns before completely tightening any of them.
- ✚ Fasten the SMALL SHELF (D) to the SHORT BACK (H). Use two 2" PAN HEAD SCREWS (16).

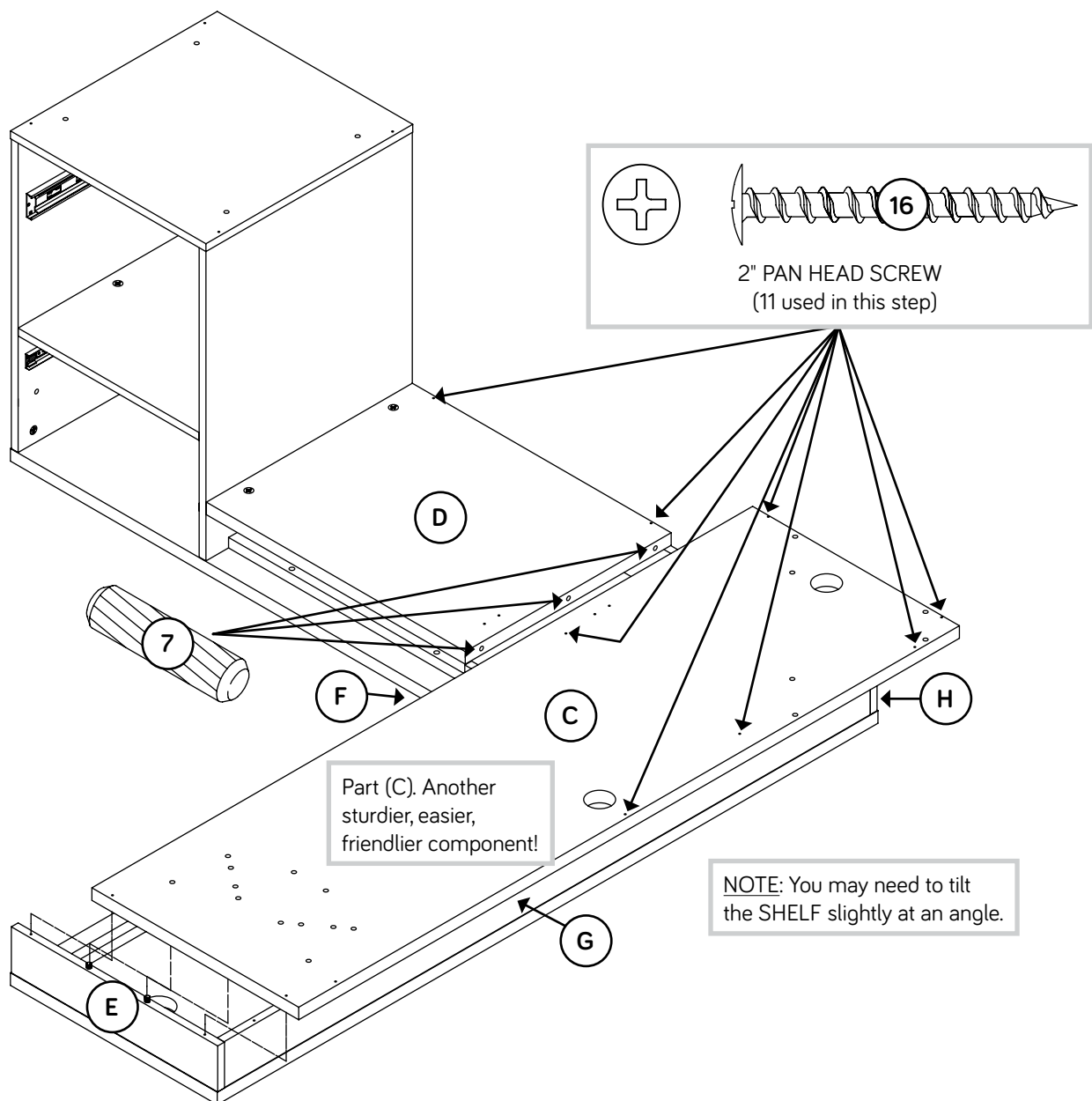

Step 19

- ✚ Fasten the PLATE (10) to the SHELVES (C and D). Use four 1/2" PAN HEAD SCREWS (23).
- ✚ NOTE: You should start each SCREW a few turns before completely tightening any of them.



If you're doing this to help a friend, don't leave without a bite.

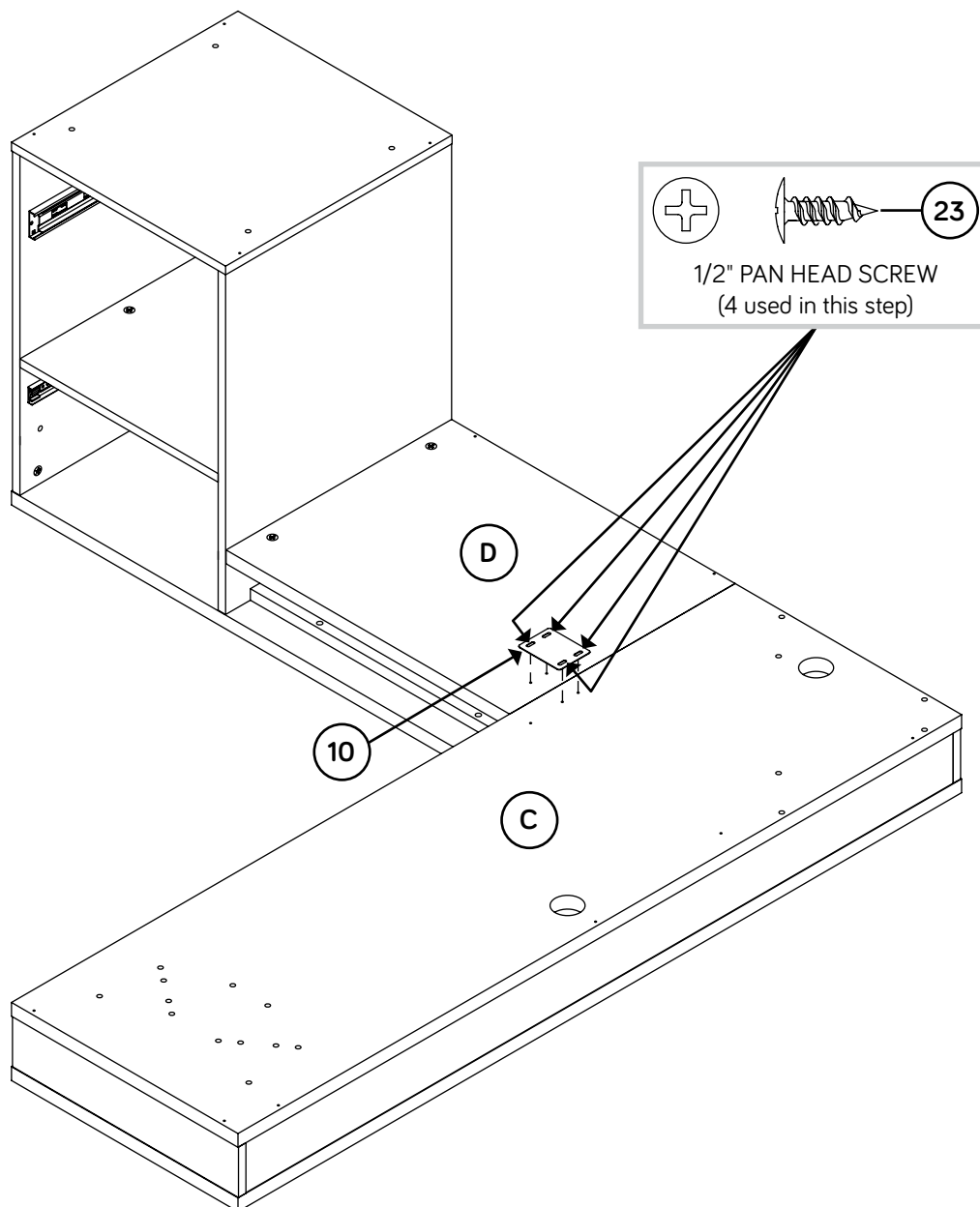

Step 20

- ✚ **NOTE:** Start each SCREW in this step a few turns before completely tightening any of them.
- ✚ Fasten the LEFT LEG (CC) to the LARGE SHELF (C). Tighten four 1-3/16" HEX HEAD SCREWS (17) using the L-WRENCH (15).
- ✚ Fasten two LEG BRACKETS (FF) to the LARGE SHELF (C). Tighten eight 1/2" HEX HEAD SCREWS (21) using the L-WRENCH (15).

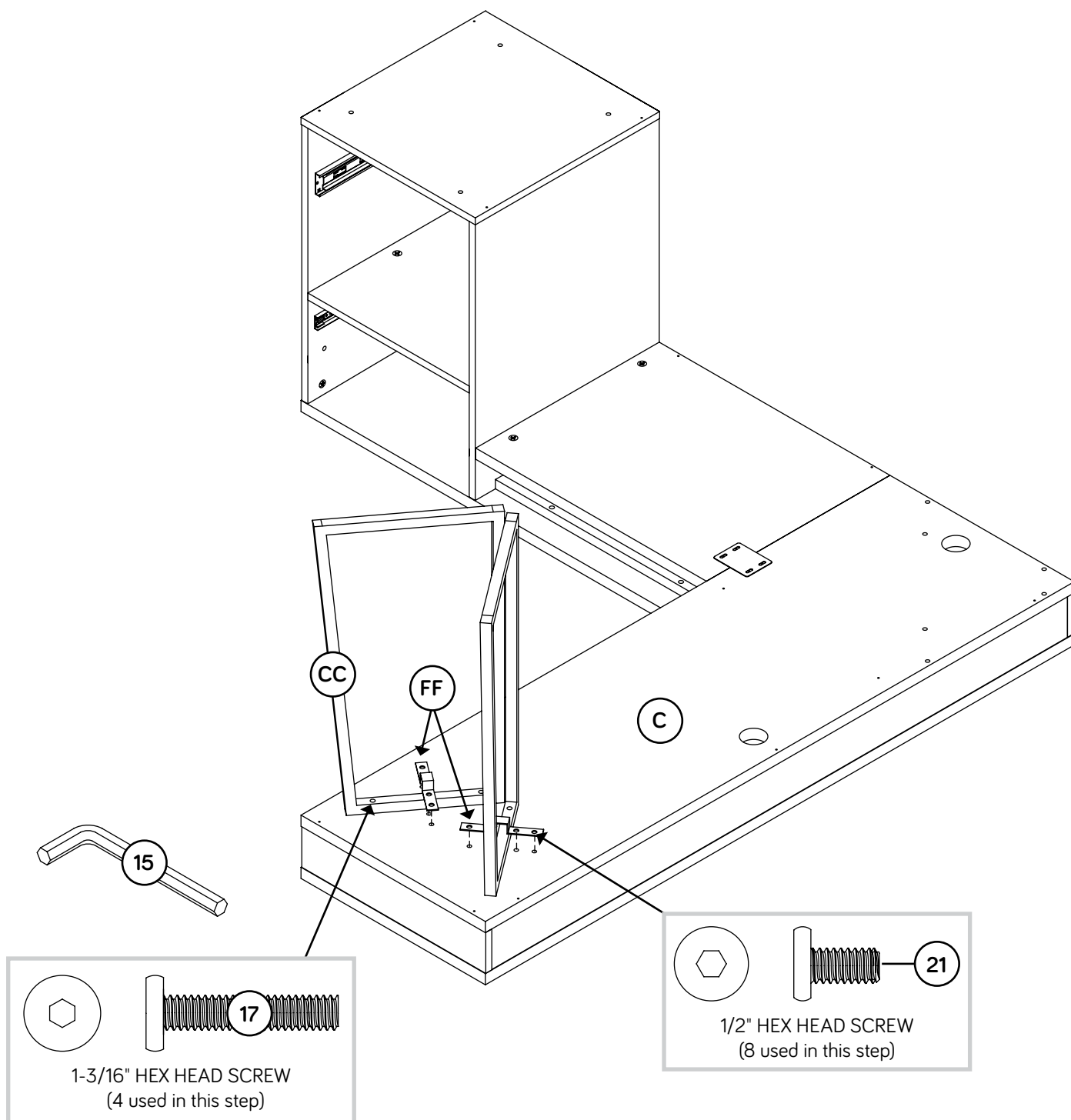

Step 21

- ⚠ **NOTE:** Do not completely tighten the SCREWS in this step.
- ⚠ Fasten the LEG BRACE (GG) to the CORNER LEG (BB). Tighten two 1/2" HEX HEAD SCREWS (21) using the L-WRENCH (15).

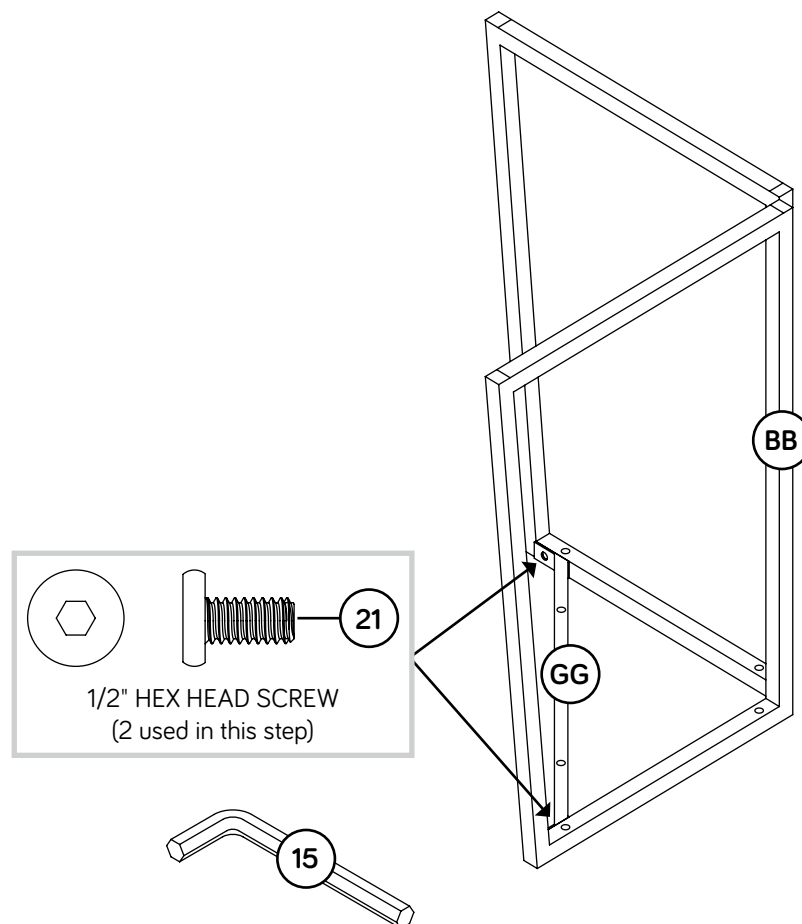

Step 22

- ✚ Fasten the CORNER LEG (BB) and LEG BRACE (GG) to the LARGE SHELF (C). Tighten six 1-3/16" HEX HEAD SCREWS (17) using the L-WRENCH (15).
- ✚ **NOTE:** Start each SCREW in this step a few turns before completely tightening any of them.
- ✚ Completely tighten the SCREWS in the LEG BRACE (GG) into the CORNER LEG (BB).

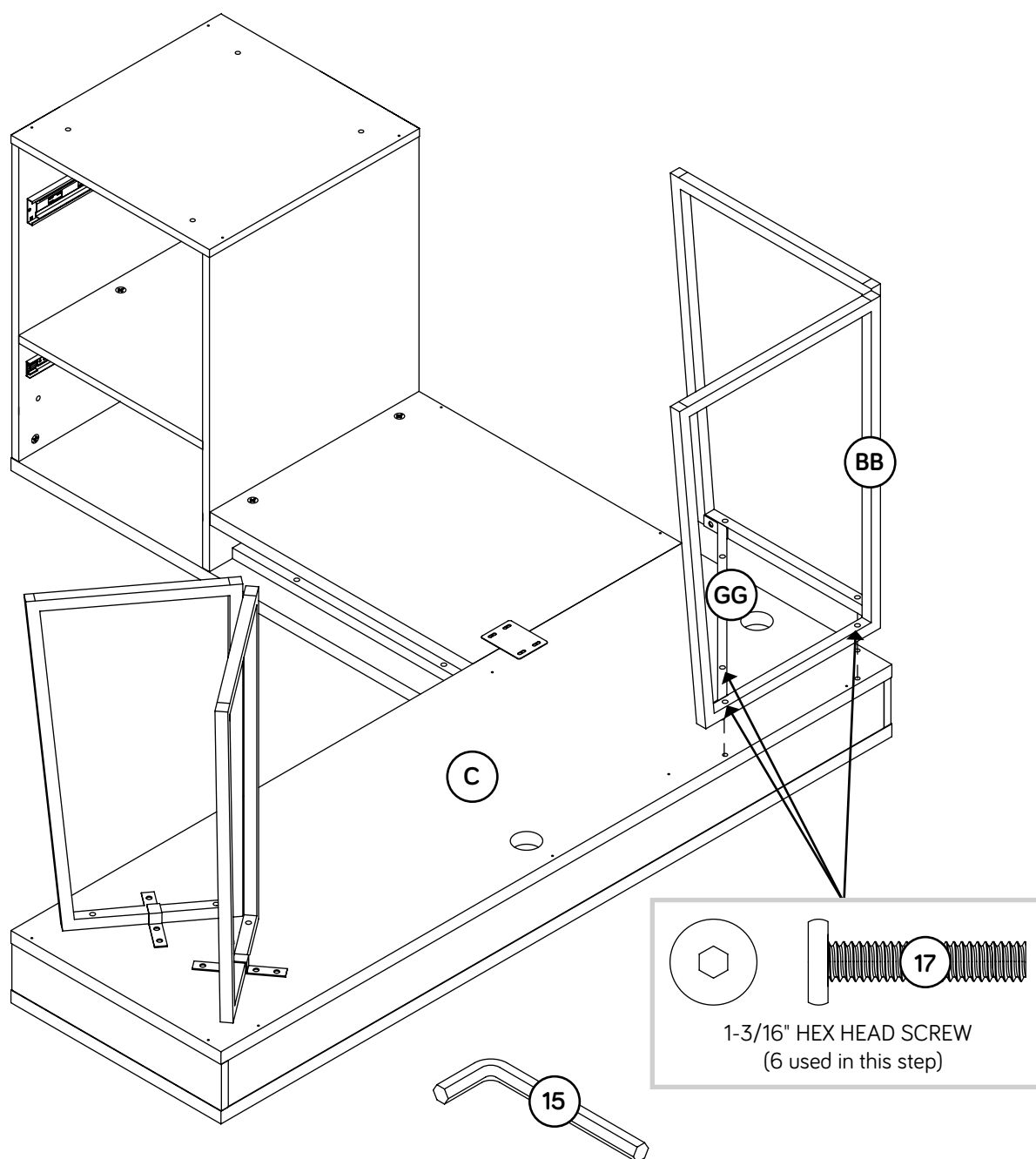

Step 23

- Fasten the FOOT BRACE (DD) to the FEET (EE).
Tighten four 1/2" HEX HEAD SCREWS (21) using
the L-WRENCH (15).

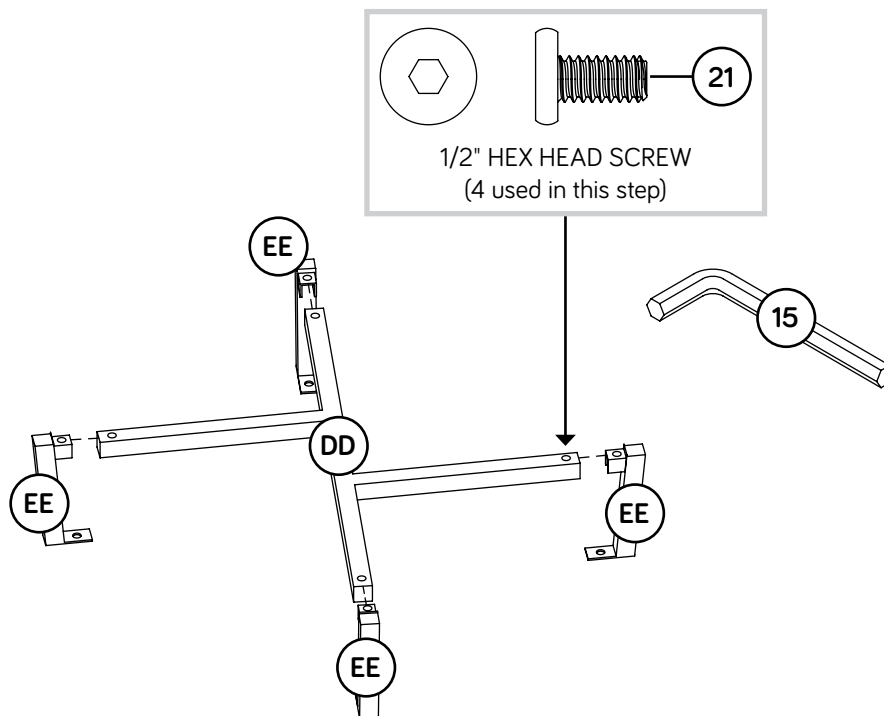

Step 24

✚ Fasten the FEET (EE) to the BOTTOM (L). Tighten four 1/2" HEX HEAD SCREWS (21) using the L-WRENCH (15).

✚ NOTE: Start each SCREW in this step a few turns before completely tightening any of them.

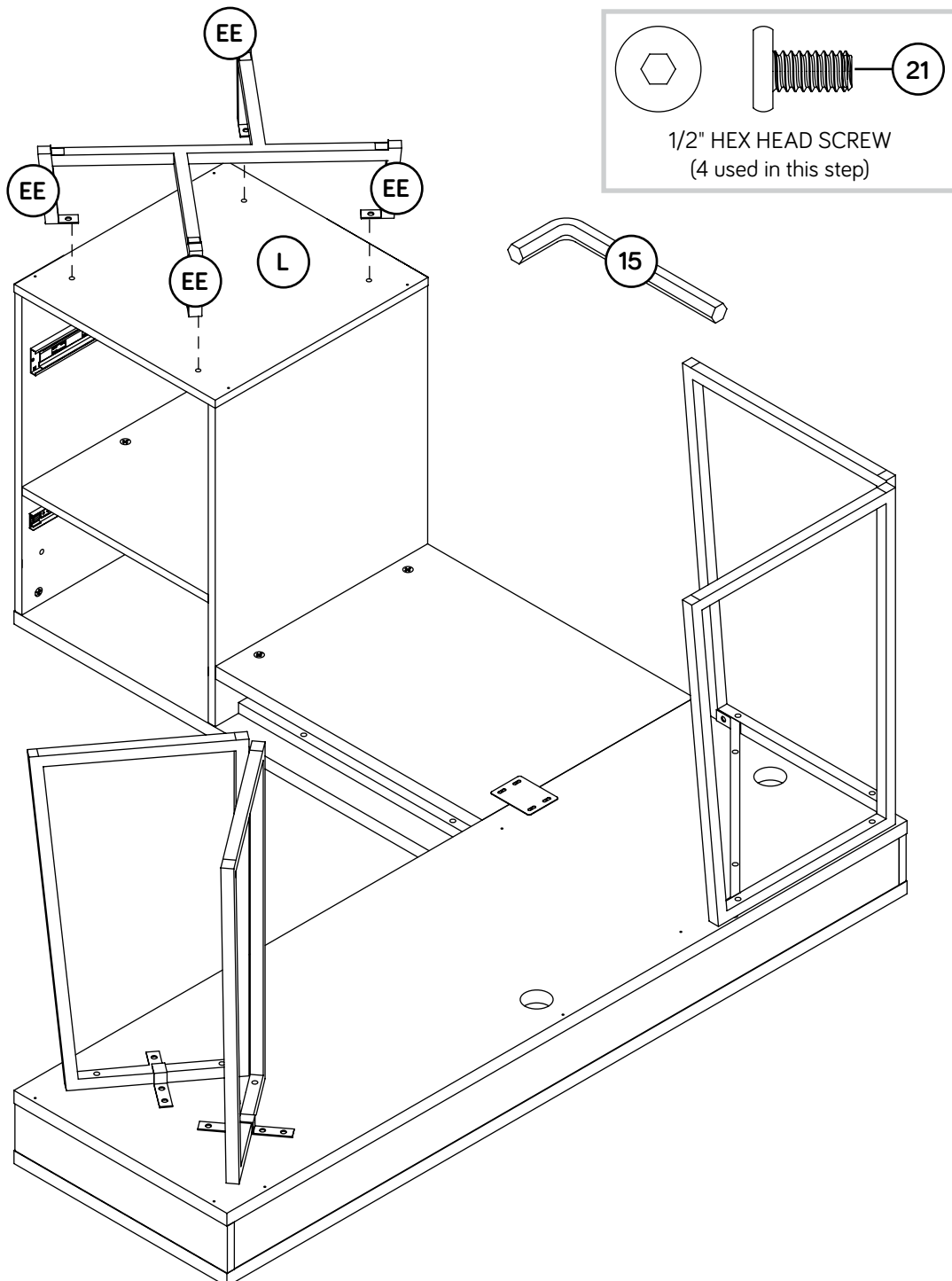

Step 25

- ✚ Turn four CAM SCREWS (6) into the DRAWER FRONT (W).
- ✚ Push four HIDDEN CAMS (5) into the DRAWER SIDES (Y and Z).
- ✚ Fasten the DRAWER SIDES (Y and Z) to the DRAWER BACK (X).
Use four 1-3/16" FLAT HEAD SCREWS (18).

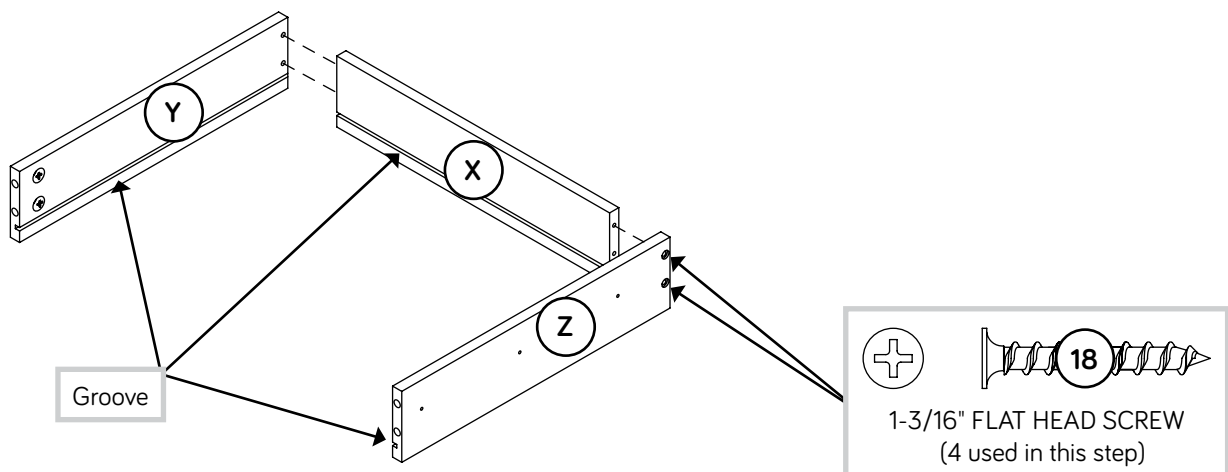
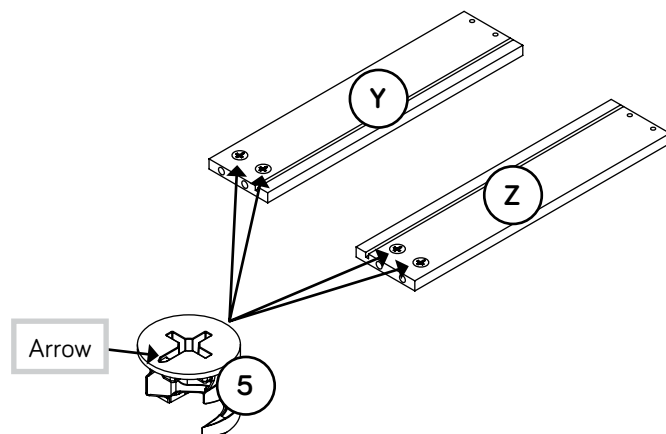
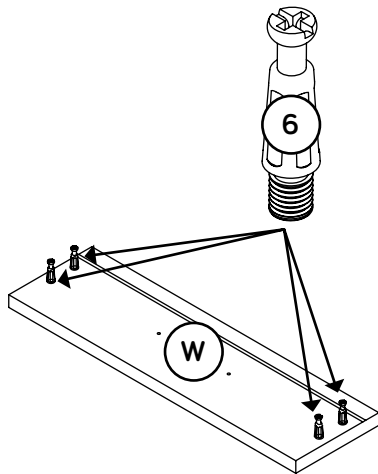

Step 26

- ✚ Slide the LARGE DRAWER BOTTOM (AA) into the grooves in the DRAWER BACK (X) and DRAWER SIDES (Y and Z).
- ✚ Fasten the DRAWER FRONT (W) to the DRAWER SIDES (Y and Z). Tighten four HIDDEN CAMS.

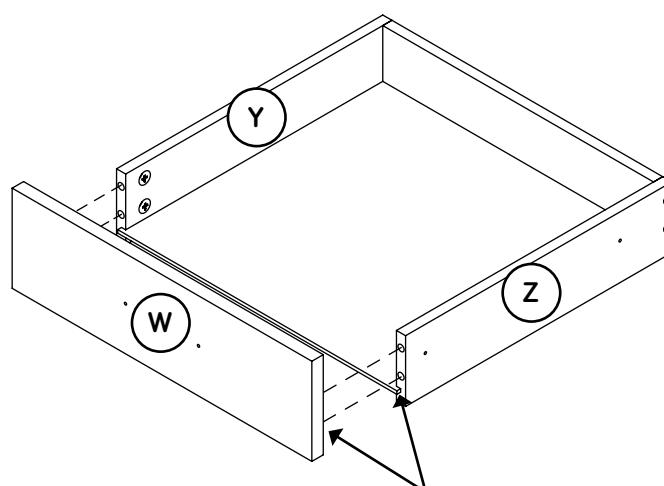
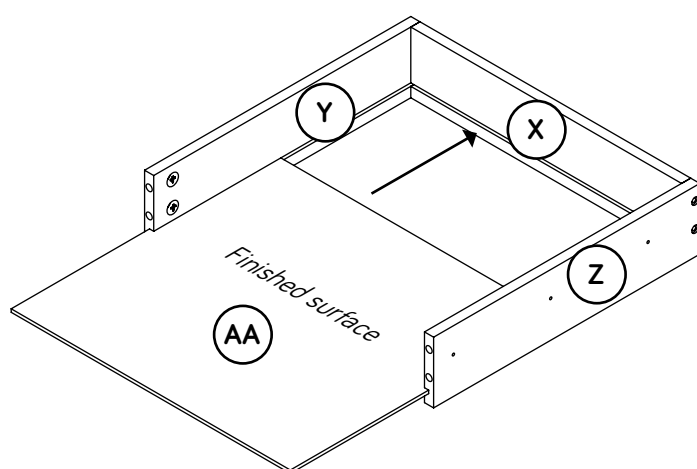

NOTE: Be sure the DRAWER BOTTOM inserts into the DRAWER FRONT groove.

Step 27

- Fasten two NARROW EXTENSION SLIDES (4) to the DRAWER SIDES (Y and Z). Use six 1/2" FLAT HEAD SCREWS (22).
- Fasten one PULL (11) to the DRAWER FRONT (W). Use two 13/16" MACHINE SCREWS (20).



Almost time to celebrate! With a nap.

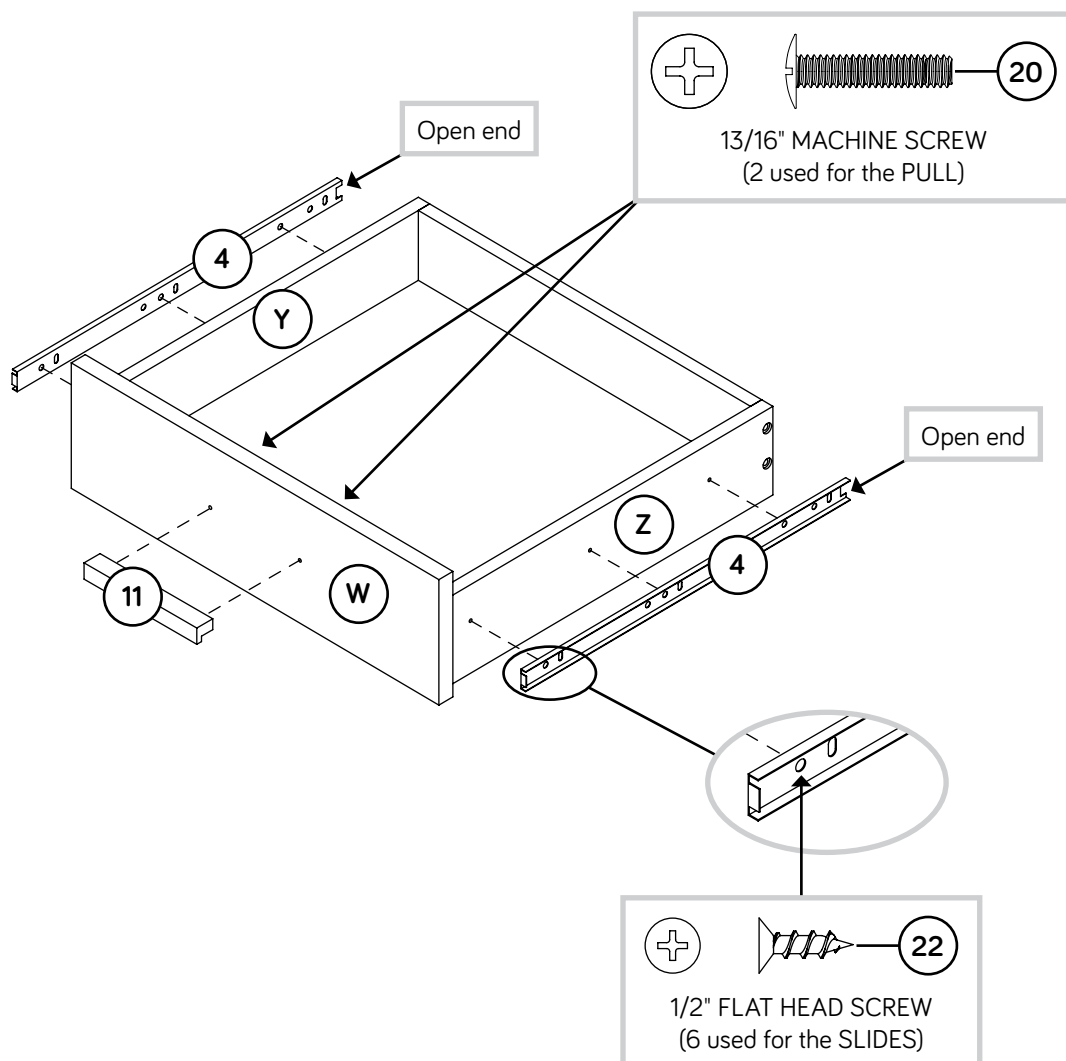

Step 28

- ✚ Insert two SMALL WOOD DOWELS (8) into the FILE LEFT DRAWER SIDE (Q).
- ✚ Fasten the FILE LEFT DRAWER SIDE (Q) to the FILE DRAWER BACK (P) and FILE DRAWER BOX FRONT (S). Use four 1-3/16" FLAT HEAD SCREWS (18).
- ✚ Insert two SMALL WOOD DOWELS (8) into the FILE RIGHT DRAWER SIDE (R).
- ✚ Fasten the FILE RIGHT DRAWER SIDE (R) to the FILE DRAWER BACK (P) and FILE DRAWER BOX FRONT (S). Use four 1-3/16" FLAT HEAD SCREWS (18).
- ✚ Slide the SMALL DRAWER BOTTOM (V) into the grooves in the FILE DRAWER BACK (P) and FILE DRAWER SIDES (Q and R).

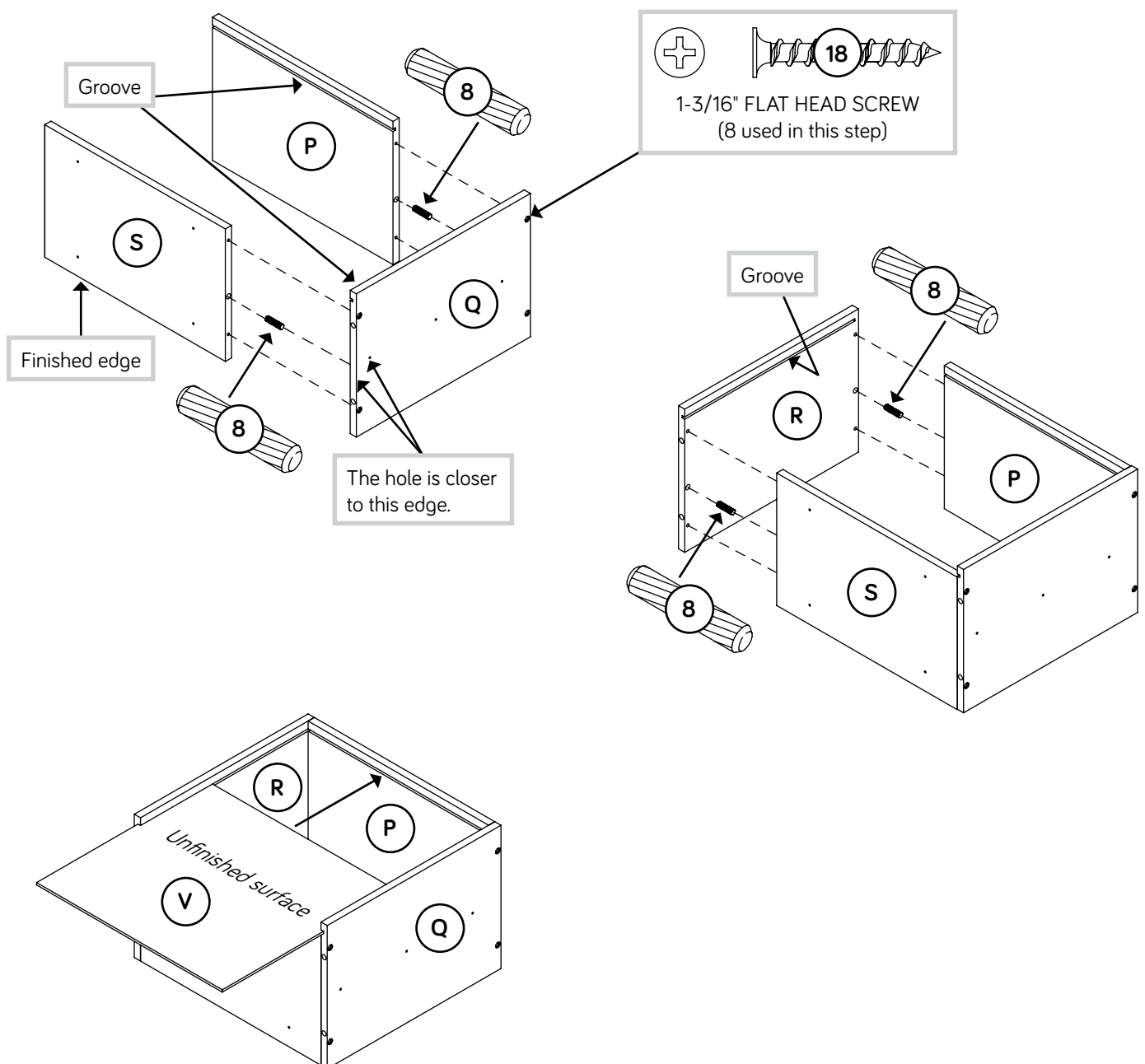

Step 29

- ✚ Carefully flip the FILE DRAWER over.
- ✚ Push two FILE GLIDES (9) onto the FILE DRAWER BACK (P) and FILE DRAWER BOX FRONT (S).
- ✚ Insert four SMALL WOOD DOWELS (8) into the FILE DRAWER FRONT (O).
- ✚ Fasten the FILE DRAWER BOX FRONT (S) to the FILE DRAWER FRONT (O). Use four 7/8" PAN HEAD SCREWS (19).
- ✚ **NOTE:** Be sure the WOOD DOWELS in the DRAWER FRONT insert into the DRAWER SIDES.

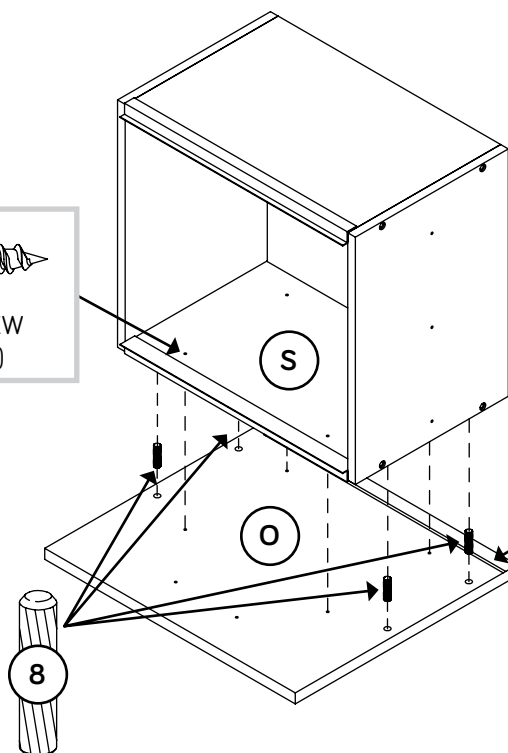
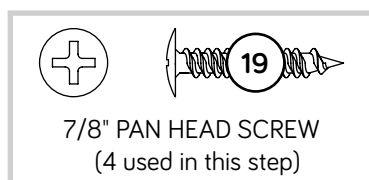
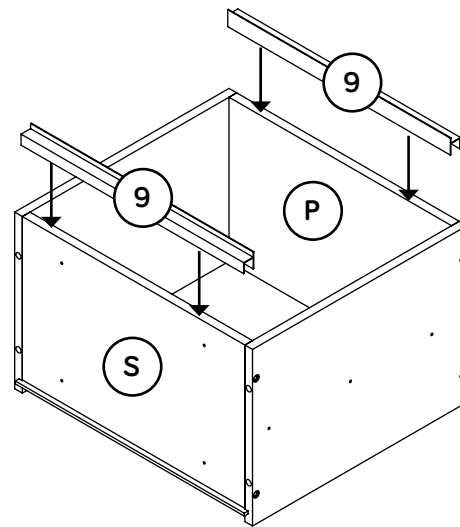

NOTE: Be sure the
DRAWER BOTTOM
inserts into the DRAWER
FRONT groove.

Step 30

- Fasten two WIDE EXTENSION SLIDES (2) to the FILE DRAWER SIDES (Q and R). Use six 1/2" FLAT HEAD SCREWS (22).

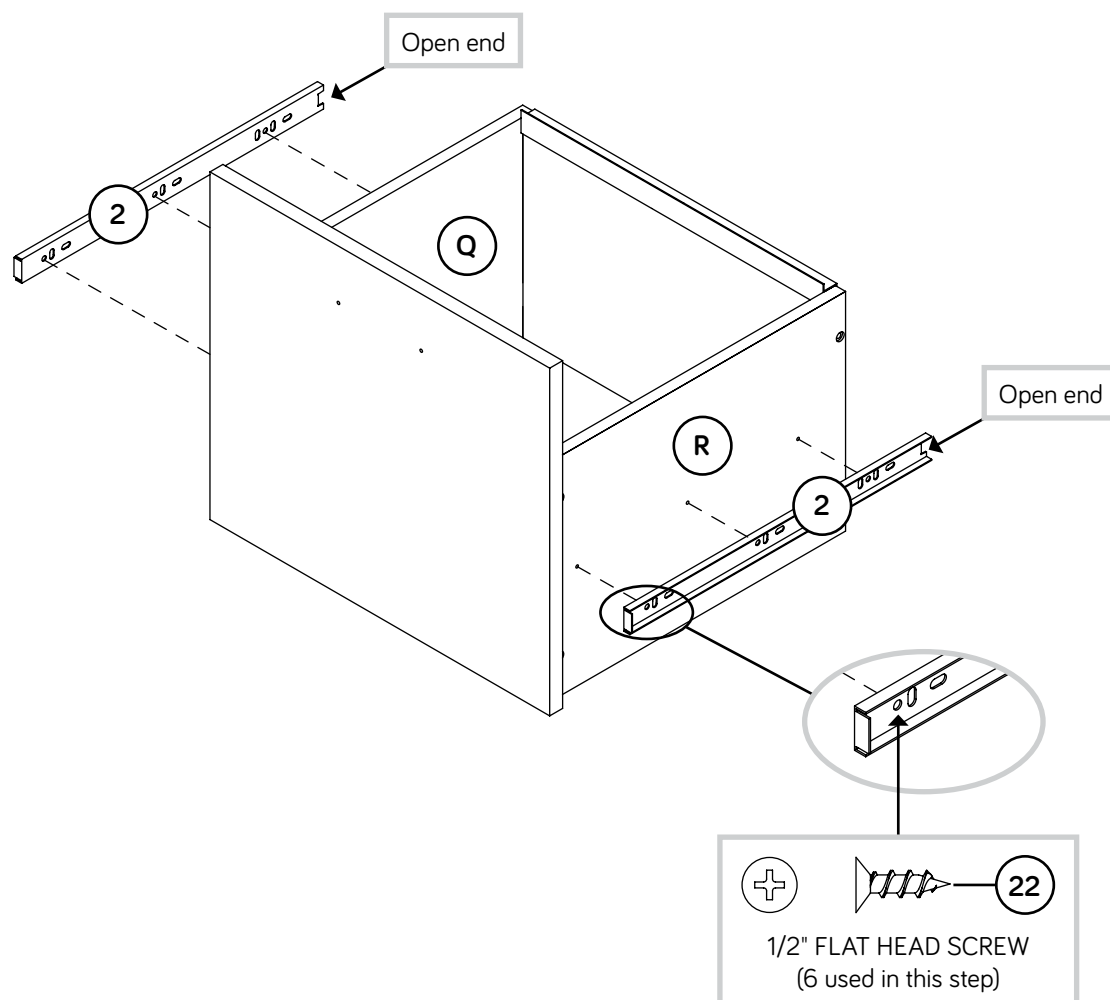

Step 31

- Fasten one PULL (11) to the FILE DRAWER FRONT (O).
Use two 13/16" MACHINE SCREWS (20).

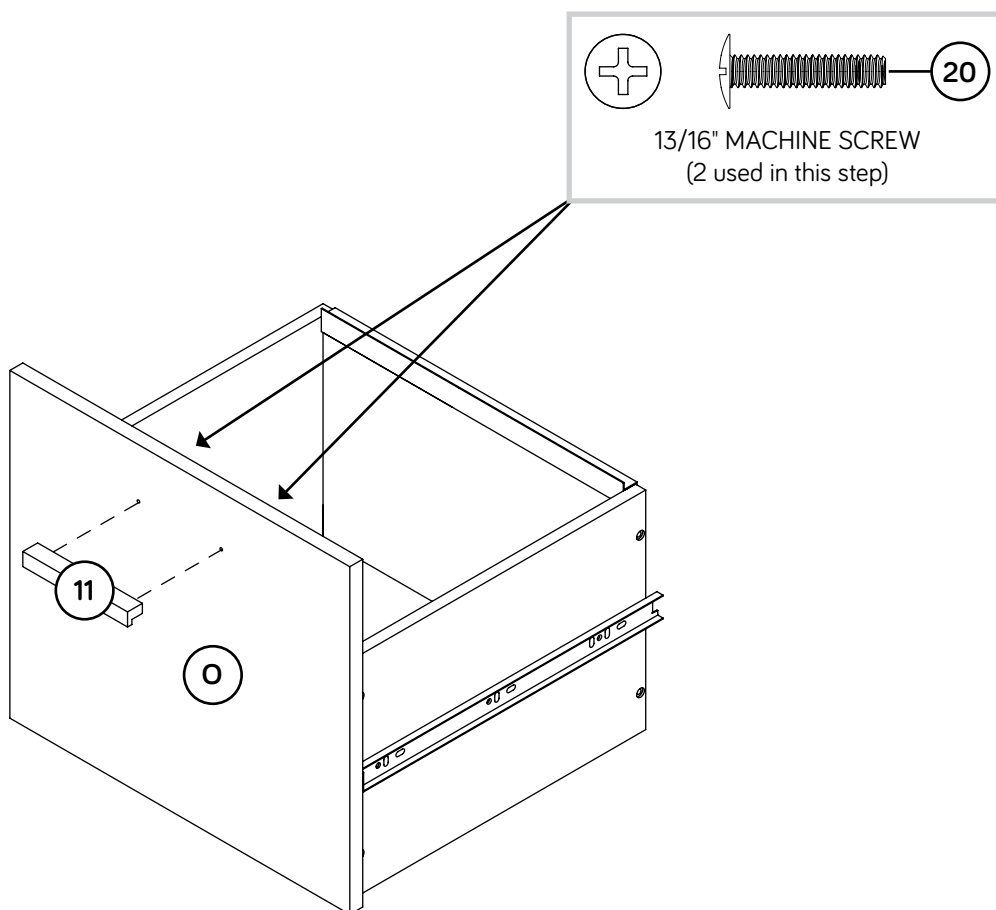

Step 32 Optional Hidden Wireless Qi Compatible Charger by Eggtronic (sold separately)

- ✚ With someone's help, carefully stand your unit upright.
- ✚ If you did not purchase the optional Hidden Wireless Qi Compatible Charger by Eggtronic, go to the next step.
- ✚ **IMPORTANT:** The WIRELESS CHARGING SPOT STICKER must be placed directly above the CHARGER.
- ✚ First, measure in from both edges of the TOP above your CHARGER as shown. Then, make a slight mark where the two measurements intersect. Next, center the STICKER over the mark and stick it to the TOP.

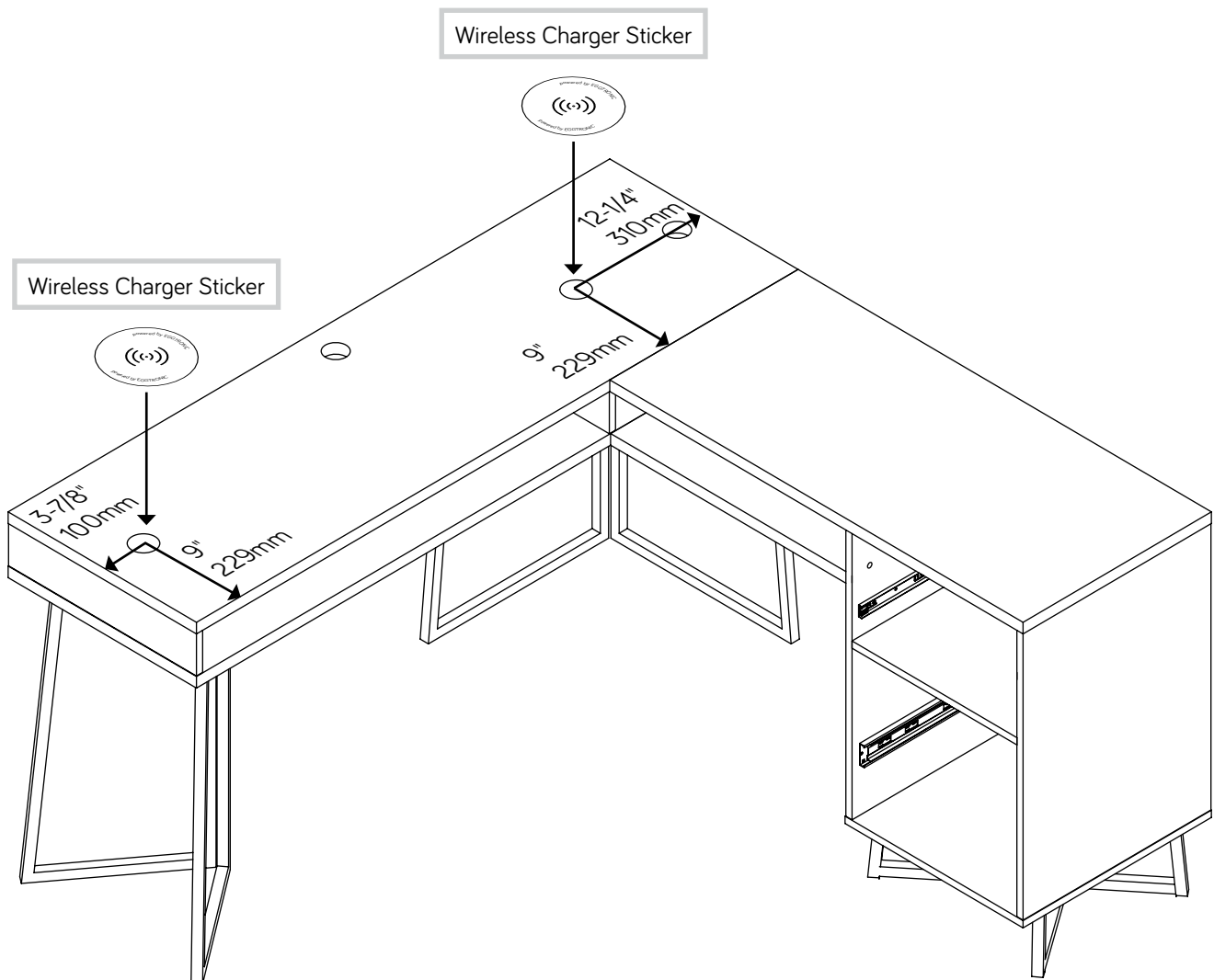

Step 33

- ✚ Insert a GROMMET (12) into each large hole in the LARGE TOP (A).
- ✚ Insert the SHELF PINS (24) into the hole locations of your choice in the ENDS (J and K). Set the SHELF (KK) onto the SHELF PINS.

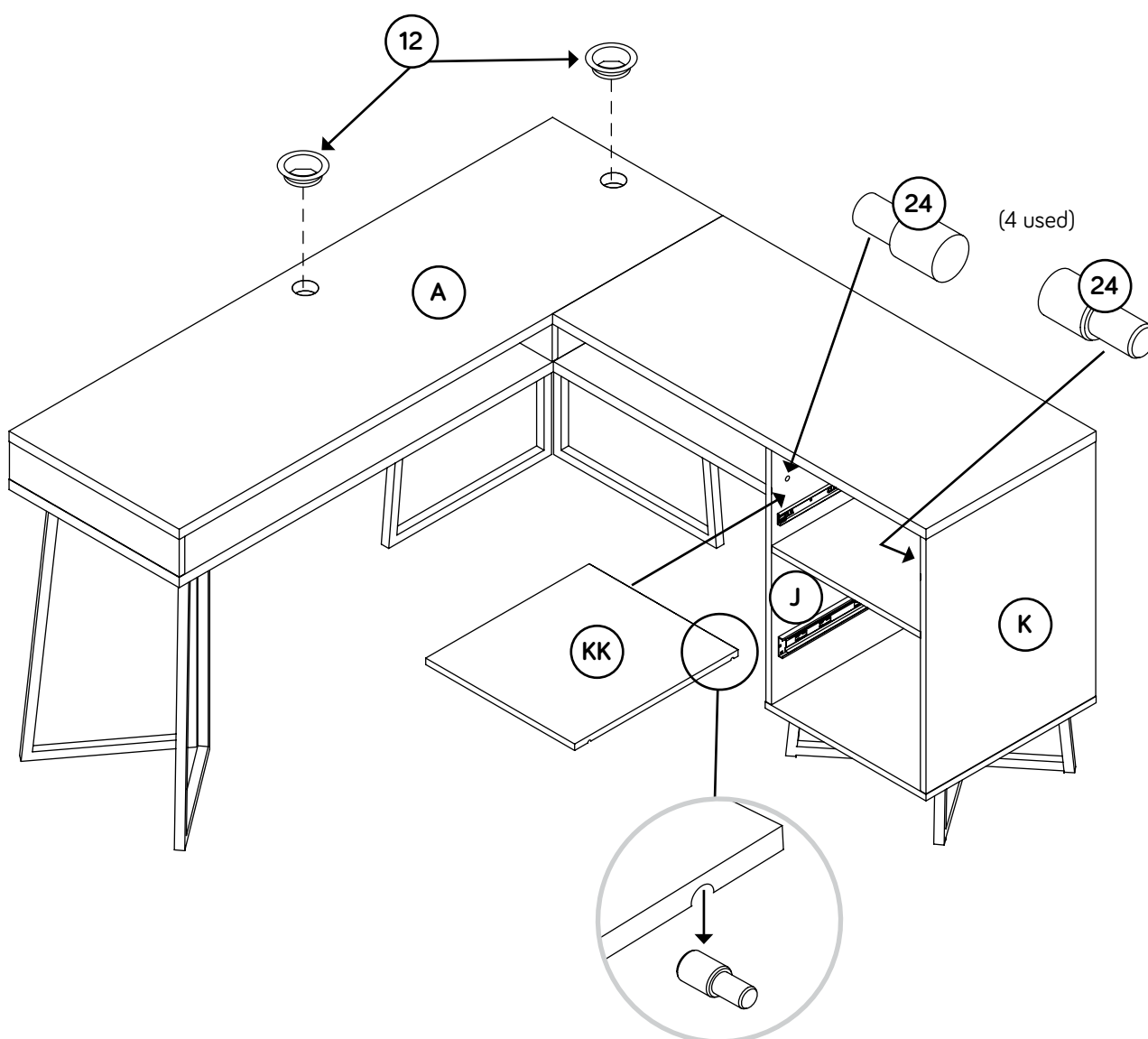

Step 34

- ✚ To insert a drawer into your unit, line up the EXTENSION SLIDES on the drawer with the EXTENSION RAILS on the unit and push the drawer into the unit until the drawer is fully inserted. The drawer will push in hard until it is all the way in, then it will slide in and out easier.

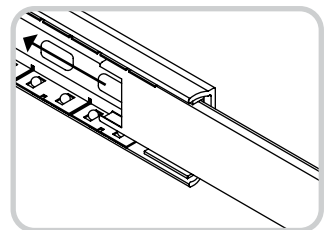
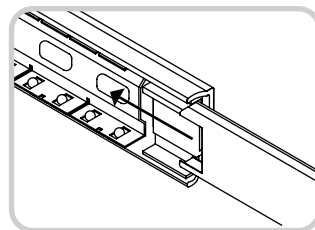
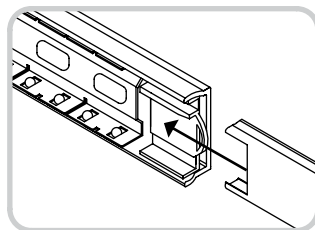
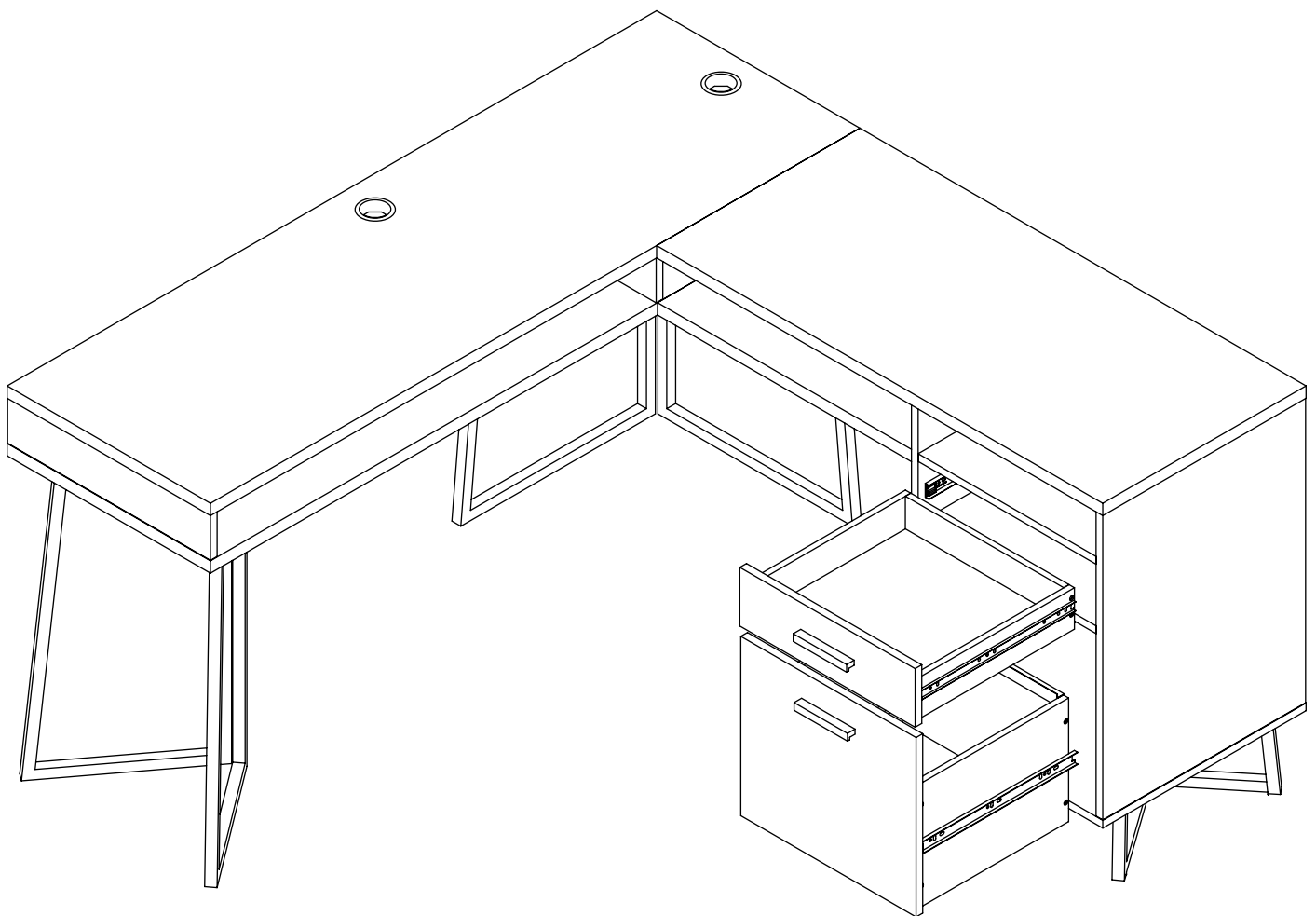

Step 35

- ✦ Peel APPLIQUES from the APPLIQUE CARDS (14) and stick them onto each visible HIDDEN CAM.
- ✦ If you purchased and installed the HIDDEN WIRELESS Qi COMPATIBLE CHARGER by EGGTRONIC, plug it into an outlet in your wall. To charge your phone, place it on the WIRELESS CHARGING SPOT STICKER. See the next page, if needed, for troubleshooting.
- ✦ NOTE: Please read the back pages of the instruction booklet for important safety information.
- ✦ This completes assembly. Clean with a damp cloth. Wipe dry.

