

## Credenza

Spiced Mahogany finish | **Model 542779I**

**NOTE:** THIS INSTRUCTION BOOKLET CONTAINS **IMPORTANT** SAFETY INFORMATION.

PLEASE READ AND KEEP FOR FUTURE REFERENCE.

English pg 1-20  
Français pg 21-24  
Español pg 25-28

Lot # **561292**  
Purchased: \_\_\_\_\_

03/09/21

# Table of Contents

# Assembly Tools Required

Part Identification	3
Hardware Identification	4-5
Optional Accessories	6
Hardware Usage Guide	7
Assembly Steps	7-20
Français	21-24
Español	25-28
Safety	29-30
Warranty	31

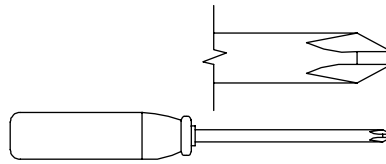

No. 2 Phillips Screwdriver  
Tip Shown Actual Size

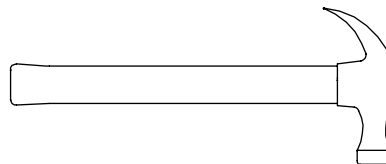

Hammer  
Not actual size 😊

# Part Identification

While not all parts are labeled, some of the parts will have a label or an inked letter on the edge to help distinguish similar parts from each other. Use this part identification to help identify similar parts.

B	SMALL DRAWER (2)	G	MODESTY PANEL (1)	N	PENCIL DRAWER BACK (1)
C	DRAWER (2)	H	TOP BRACE (2)	R	PENCIL FLIP-DOWN FRONT (1)
D	LARGE DRAWER (2)	L	PENCIL DRAWER BOTTOM (1)	YY	RIGHT PEDESTAL
F	TOP (1)	M	PENCIL DRAWER SIDE (2)	ZZ	LEFT PEDESTAL

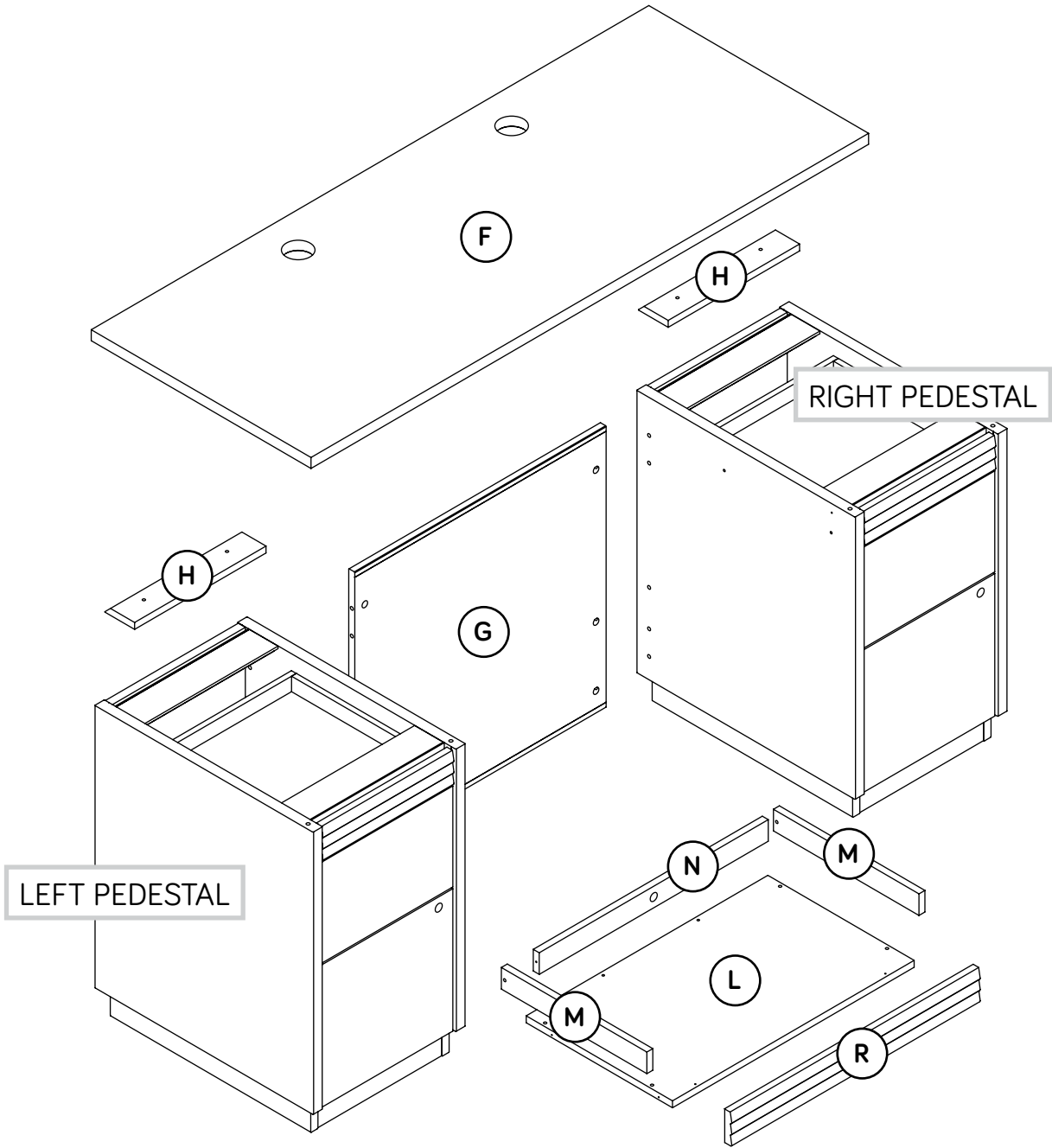

# Hardware Identification

↑ Screws are shown actual size. You may receive extra hardware with your unit.



# Hardware Identification

↑ Screws are shown actual size. You may receive extra hardware with your unit.

**1S** BLACK 9/16" LARGE HEAD SCREW - 16

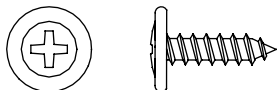

**3S** GOLD 5/16" FLAT HEAD SCREW - 4



**10S** SILVER 1-1/8" FLAT HEAD SCREW - 4

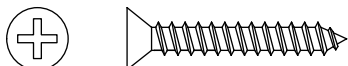

**18S** BROWN 1" FLAT HEAD SCREW - 4

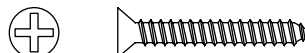

**23S** SILVER 5/8" FLAT HEAD SCREW - 4



**51S** BLACK 9/16" PAN HEAD SCREW - 2



**54S** SILVER 9/16" LARGE HEAD SCREW - 2

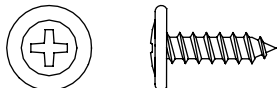

**133S** BLACK 1" FLAT HEAD SCREW - 2



**144S** BLACK 15/16" SHOULDER SCREW - 4

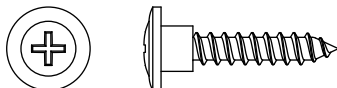

**152S** SILVER 1-5/8" FLAT HEAD SCREW - 6

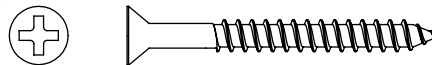

# Hardware Usage Guide

## HOW TO USE A HIDDEN CAM & LONG DOWEL

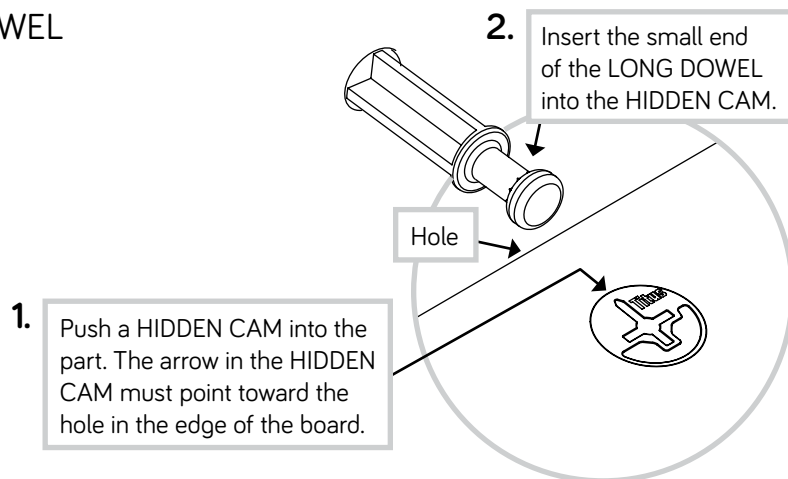
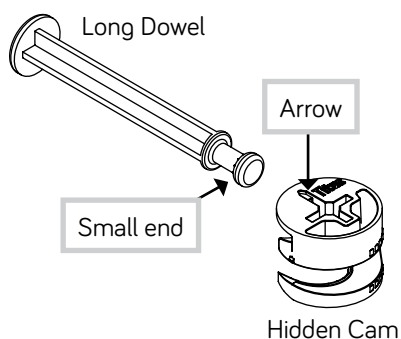

3.

### ⚠ Caution

Risk of damage or injury. HIDDEN CAMS must be completely tightened. HIDDEN CAMS that are not completely tightened may loosen, and parts may separate. To completely tighten:

Start

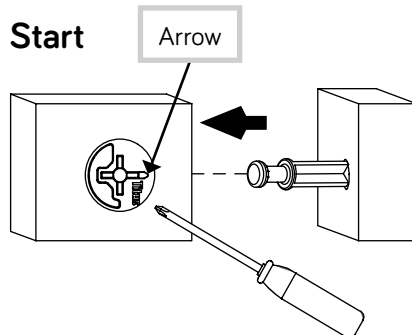

Tighten

Maximum 210 degrees

Minimum 190 degrees

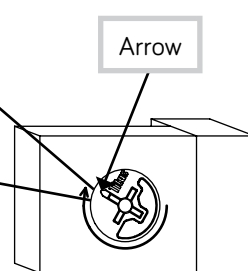

## Step 1

- ⚠ Assemble your unit on a carpeted floor or on the empty carton to avoid scratching your unit or the floor. Save some packing material for support to be used later in assembly.

- ⚠ Push six HIDDEN CAMS (1F) into the MODESTY PANEL (G).

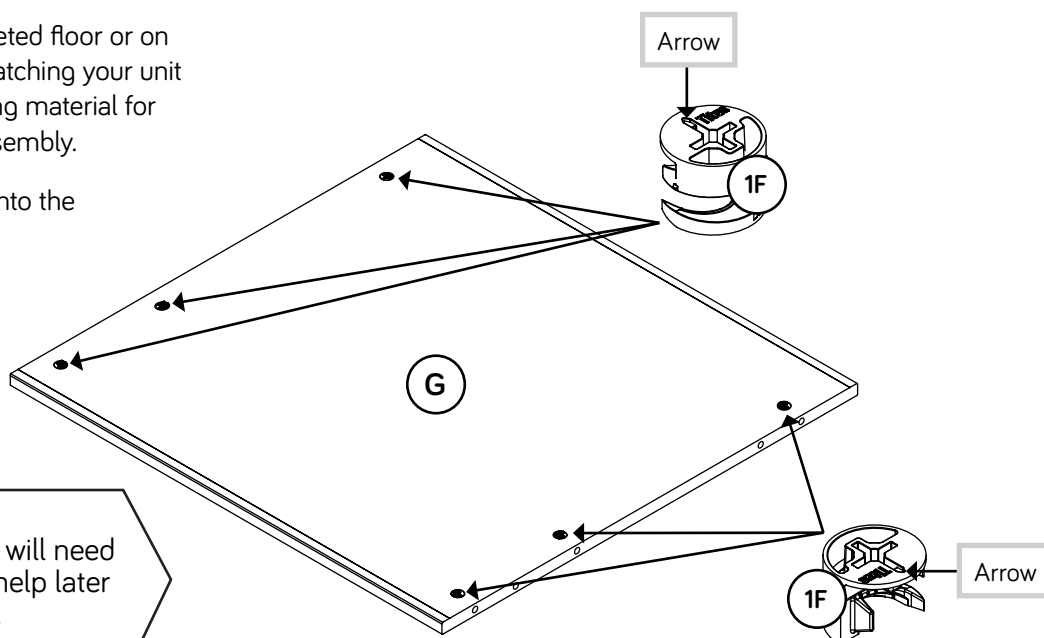

Pro Tip: You will need someone's help later in assembly.

## Step 2

✚ Insert three LONG DOWELS (40F) through the panel in the RIGHT PEDESTAL.

✚ Insert two WOOD DOWELS (15F) into the RIGHT PEDESTAL.

✚ NOTE: You may need someone's help to hold the MODESTY PANEL or use packing material for support as shown.

✚ Fasten the MODESTY PANEL (G) to the RIGHT PEDESTAL. Tighten three HIDDEN CAMS around the small ends of the LONG DOWELS.

✚ NOTE: Be sure the WOOD DOWELS in the RIGHT PEDESTAL insert into the MODESTY PANEL.

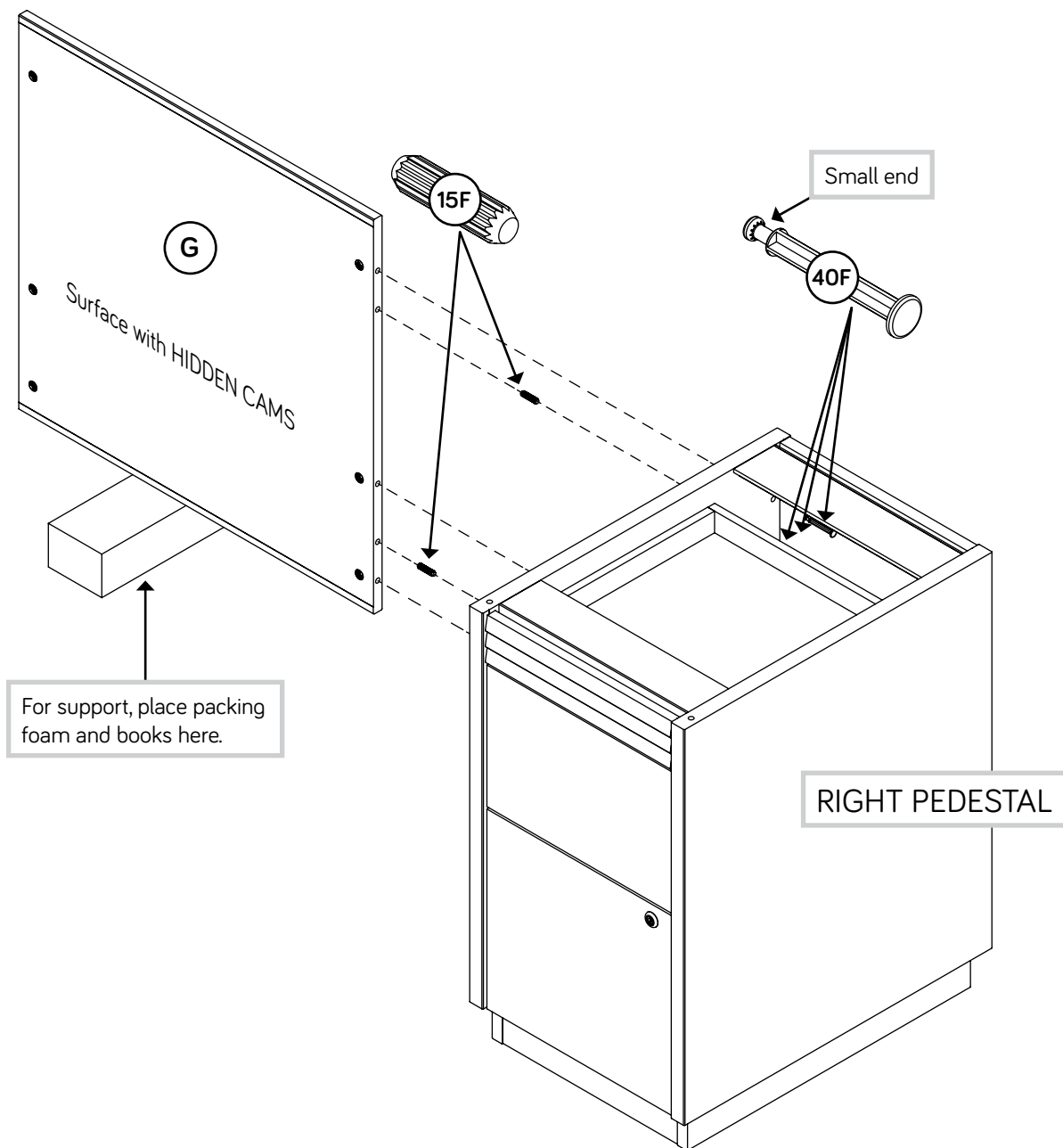

## Step 3

- ✚ Insert three LONG DOWELS (40F) through the panel in the LEFT PEDESTAL.
- ✚ Insert two WOOD DOWELS (15F) into the LEFT PEDESTAL.
- ✚ Fasten the LEFT PEDESTAL to the MODESTY PANEL (G). Tighten three HIDDEN CAMS around the small ends of the LONG DOWELS.
- ✚ NOTE: Be sure the WOOD DOWELS in the LEFT PEDESTAL insert into the MODESTY PANEL.
- ✚ Using your hammer, gently tap a CAM COVER (92P) onto each visible HIDDEN CAM.

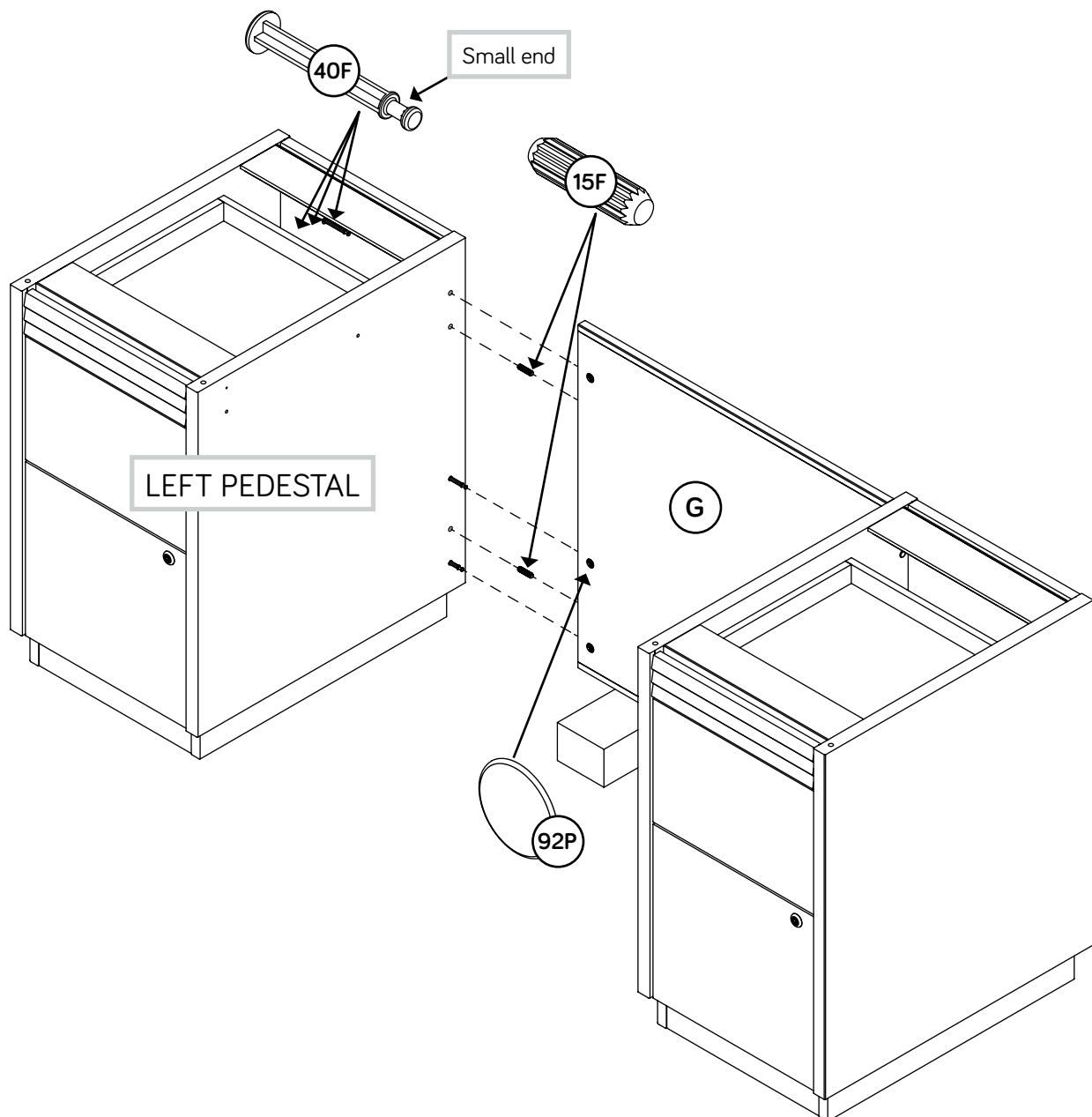



## Step 4

- Fasten the CABINET RIGHT (40AW) to the inner panel of the RIGHT PEDESTAL. Use two GOLD 5/16" FLAT HEAD SCREWS (3S).
- Fasten the CABINET LEFT (40AX) to the inner panel of the LEFT PEDESTAL. Use two GOLD 5/16" FLAT HEAD SCREWS (3S).
- Fasten the METAL BRACKETS (2G) to the panels of the RIGHT and LEFT PEDESTALS. Use two BLACK 9/16" LARGE HEAD SCREWS (1S).

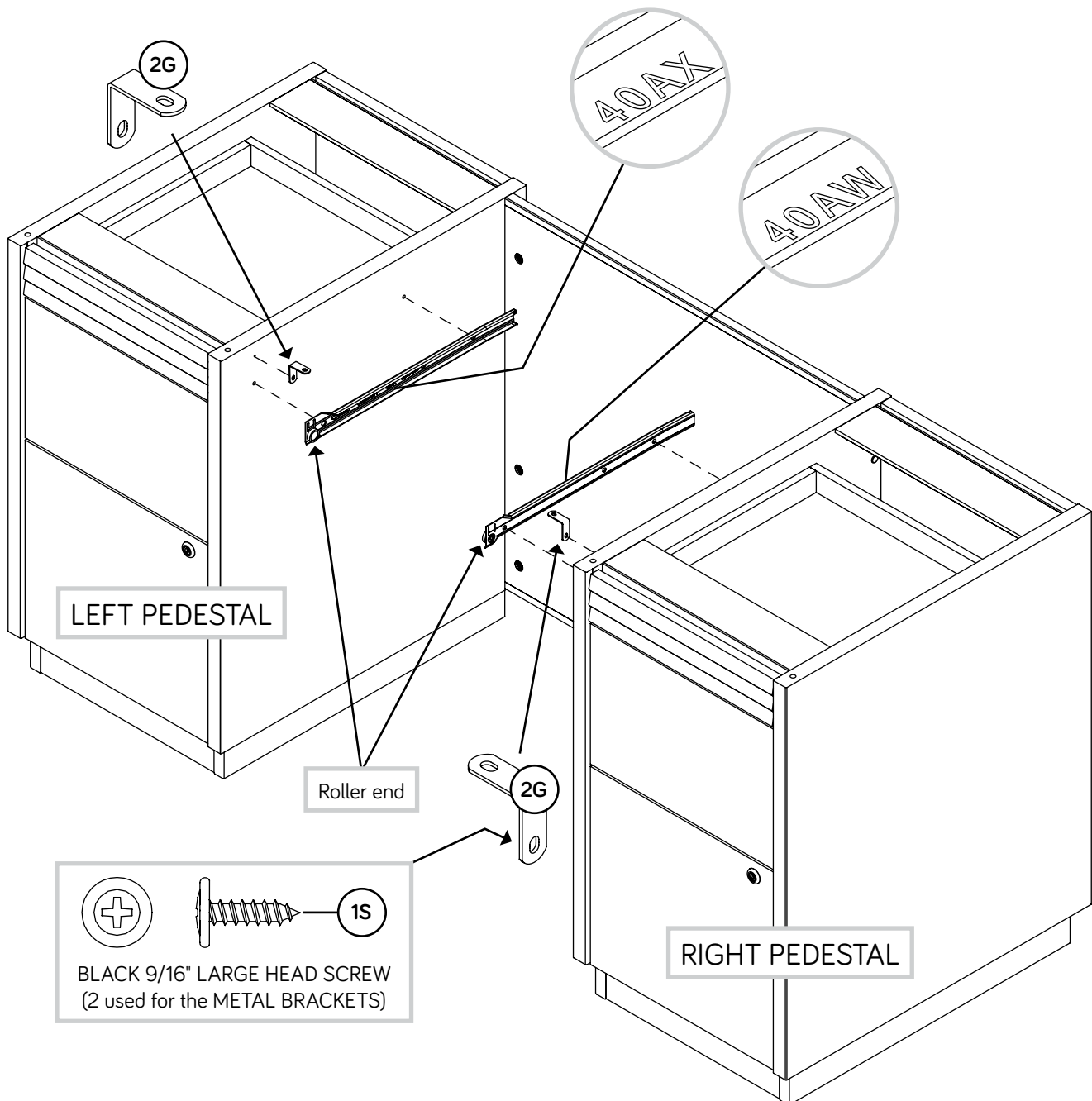
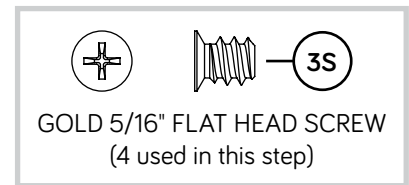

## Step 5

- Fasten the PULLS (189K) to the DRAWERS (B, C, and D). Use twelve BLACK 9/16" LARGE HEAD SCREWS (1S).
- Remove the SMALL DRAWERS (B) from your unit. Push in the black lever on each side of the drawer and pull the drawer completely out. Refer to the diagram at the bottom of the page.

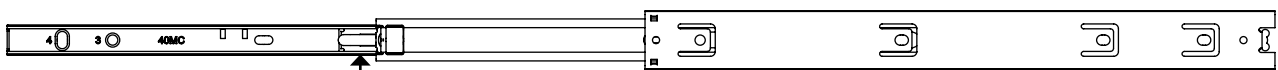
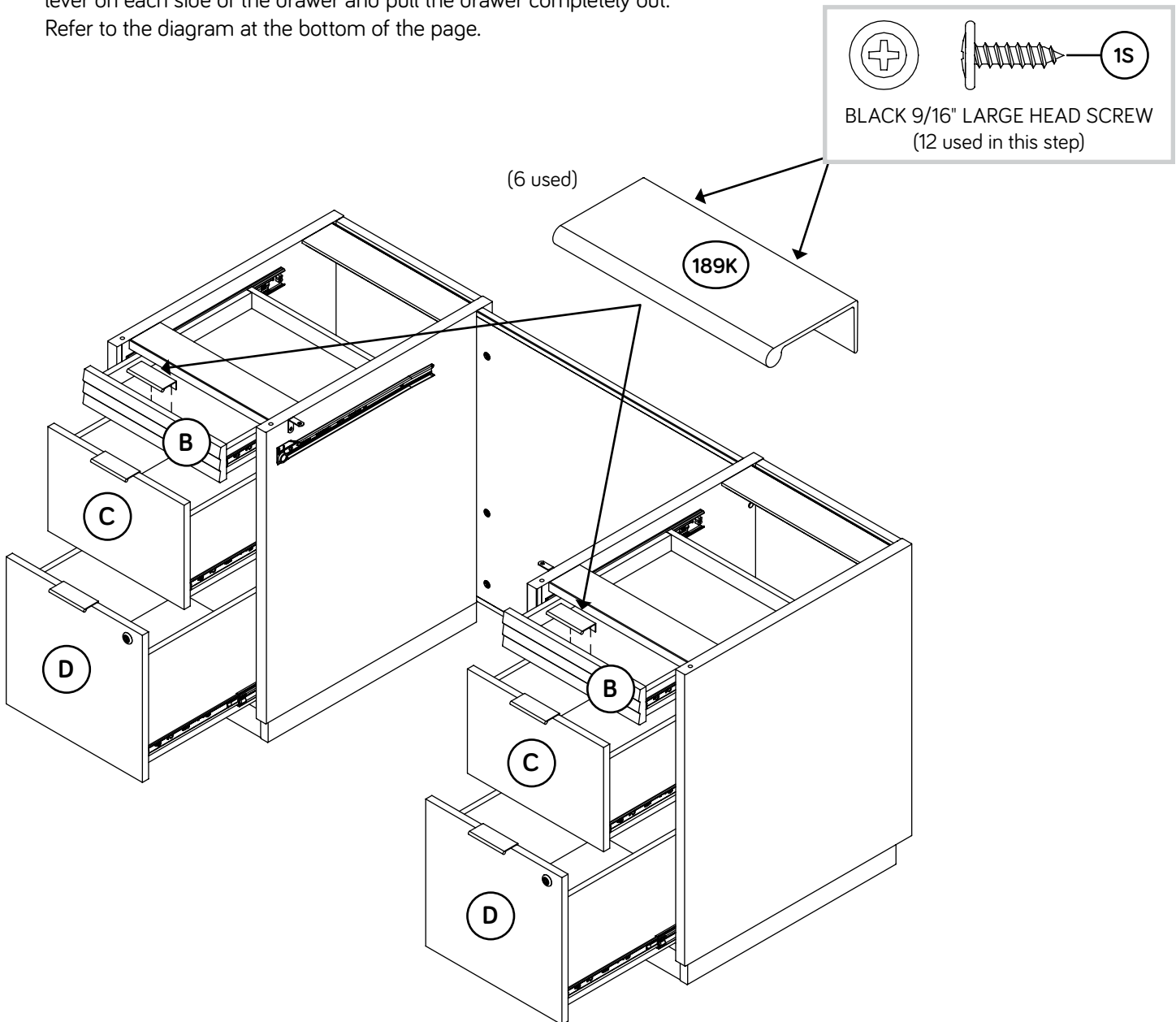

To remove the drawer, push the black lever in and pull the EXTENSION SLIDE on the drawer from the EXTENSION RAIL on the PEDESTAL.

## Step 6

- ✚ Fasten the TOP BRACES (H) to the TOP (F). Use four SILVER 1-1/8" FLAT HEAD SCREWS (10S).
- ✚ NOTE: You should start each SCREW a few turns before completely tightening any of them.
- ✚ NOTE: The angled edge of the BRACE should face down and toward the back edge of the TOP.



Just think. The sooner you do this, the sooner you do something else.

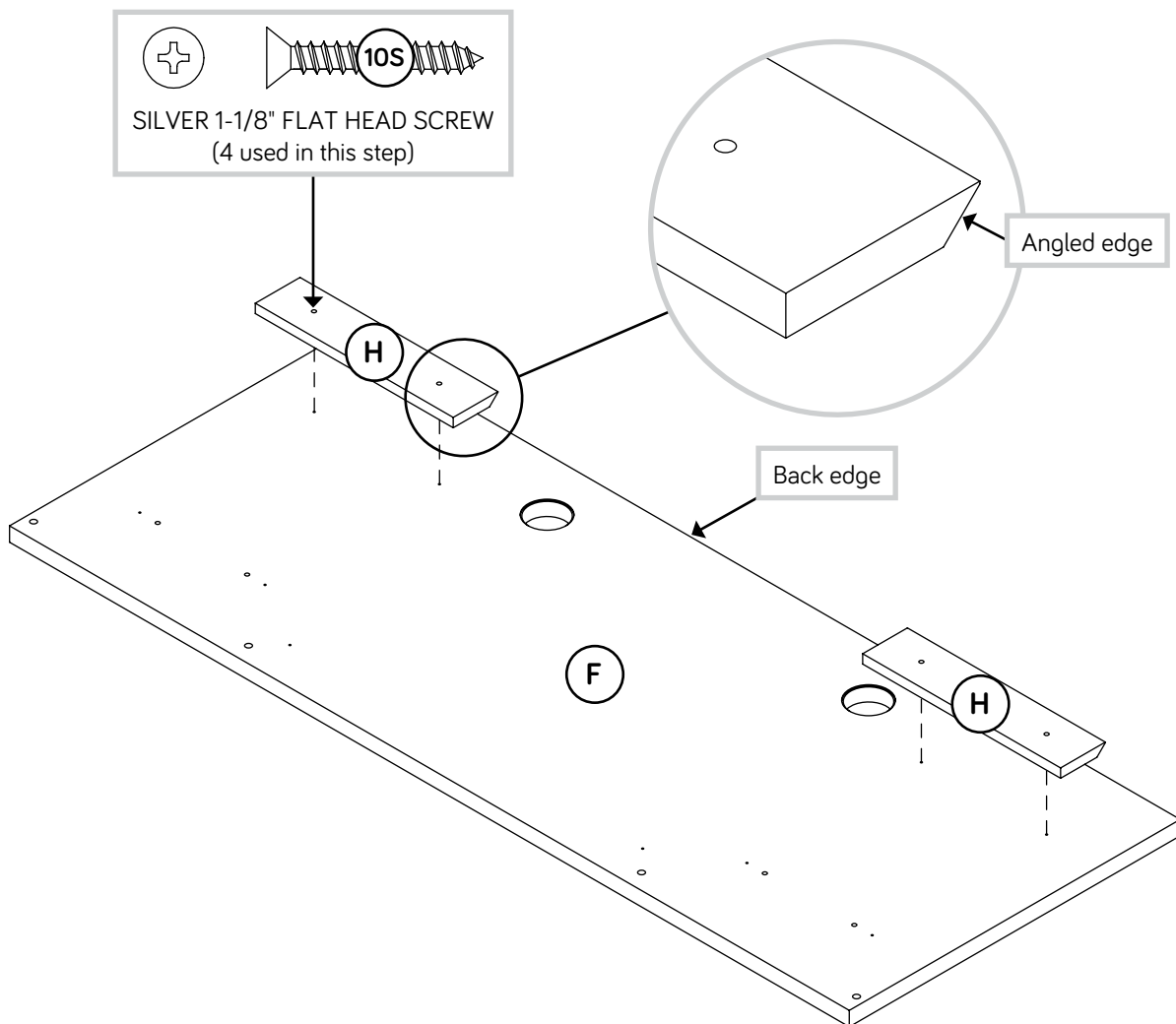

# Step 7

- ✚ With your hands, separate the LOCK MECHANISM SETS (193M). Be careful of any sharp edges after separating each set.
- ✚ Fasten the LOCK MECHANISM SETS (193M) to the TOP (F) exactly as shown. Use four BLACK 15/16" SHOULDER SCREWS (144S).
- ✚ NOTE: Be sure the post on the bottom surface of the LOCK MECHANISM SET inserts into the hole in the TOP.
- ✚ NOTE: The handle should face toward the back edge of the TOP.
- ✚ NOTE: The SHOULDER SCREW will allow the LOCK MECHANISM to swivel.

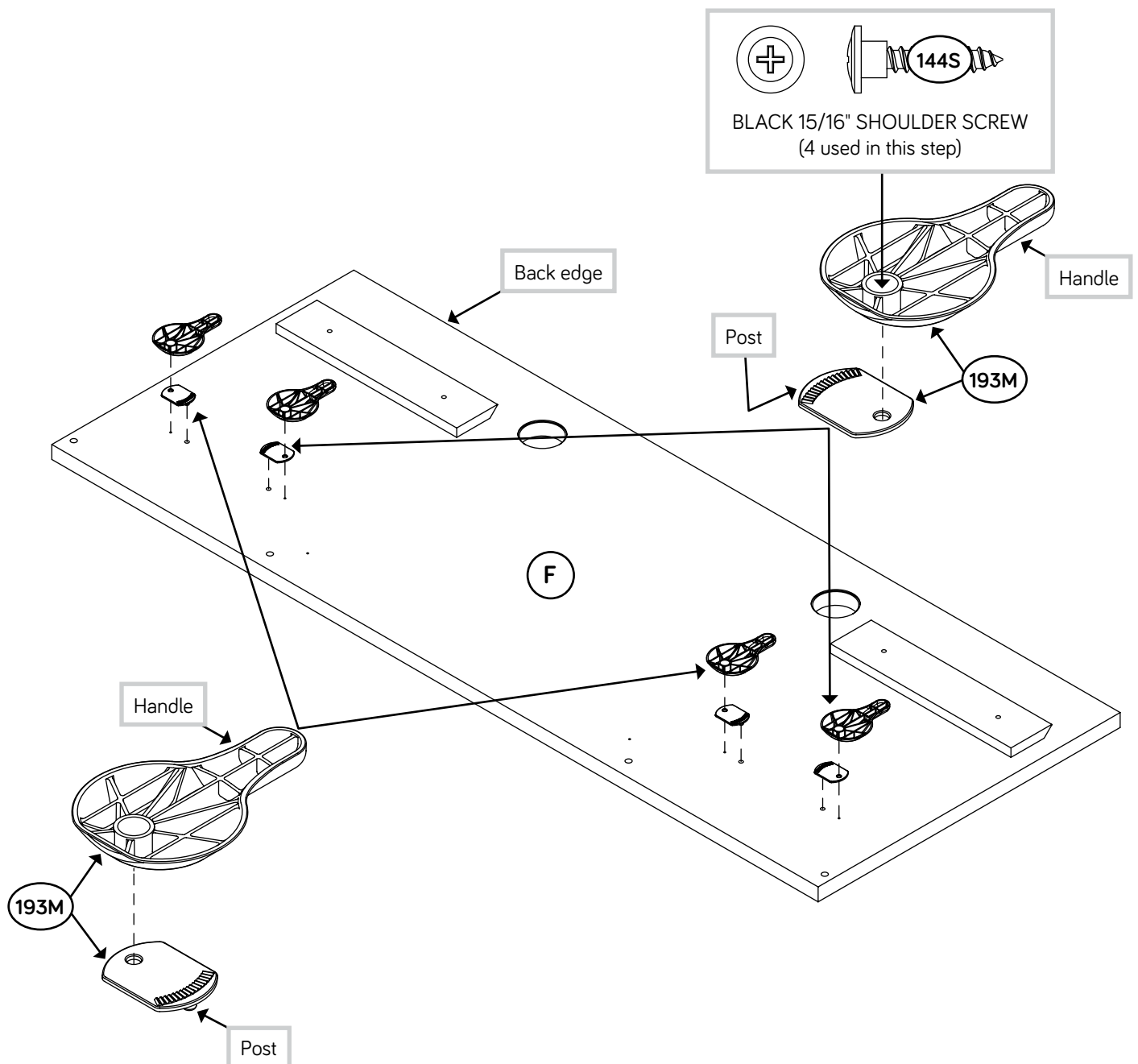

## Step 8

- ✚ Insert four WOOD DOWELS (15F) into the top edges of the panels of the RIGHT PEDESTAL and LEFT PEDESTAL as shown.
- ✚ With someone's help, carefully turn the TOP (F) over, and hook the angled edges of the BRACES on the TOP into the BRACES on the back edges of the RIGHT PEDESTAL and LEFT PEDESTAL.
- ✚ **NOTE:** Be sure the WOOD DOWELS insert into the TOP.
- ✚ Fasten the METAL BRACKETS on the PEDESTAL panels to the TOP (F). Use two BLACK 9/16" LARGE HEAD SCREWS (1S).
- ✚ Turn the LOCK MECHANISMS on the front edge of the TOP (F) toward each other until they stop moving.

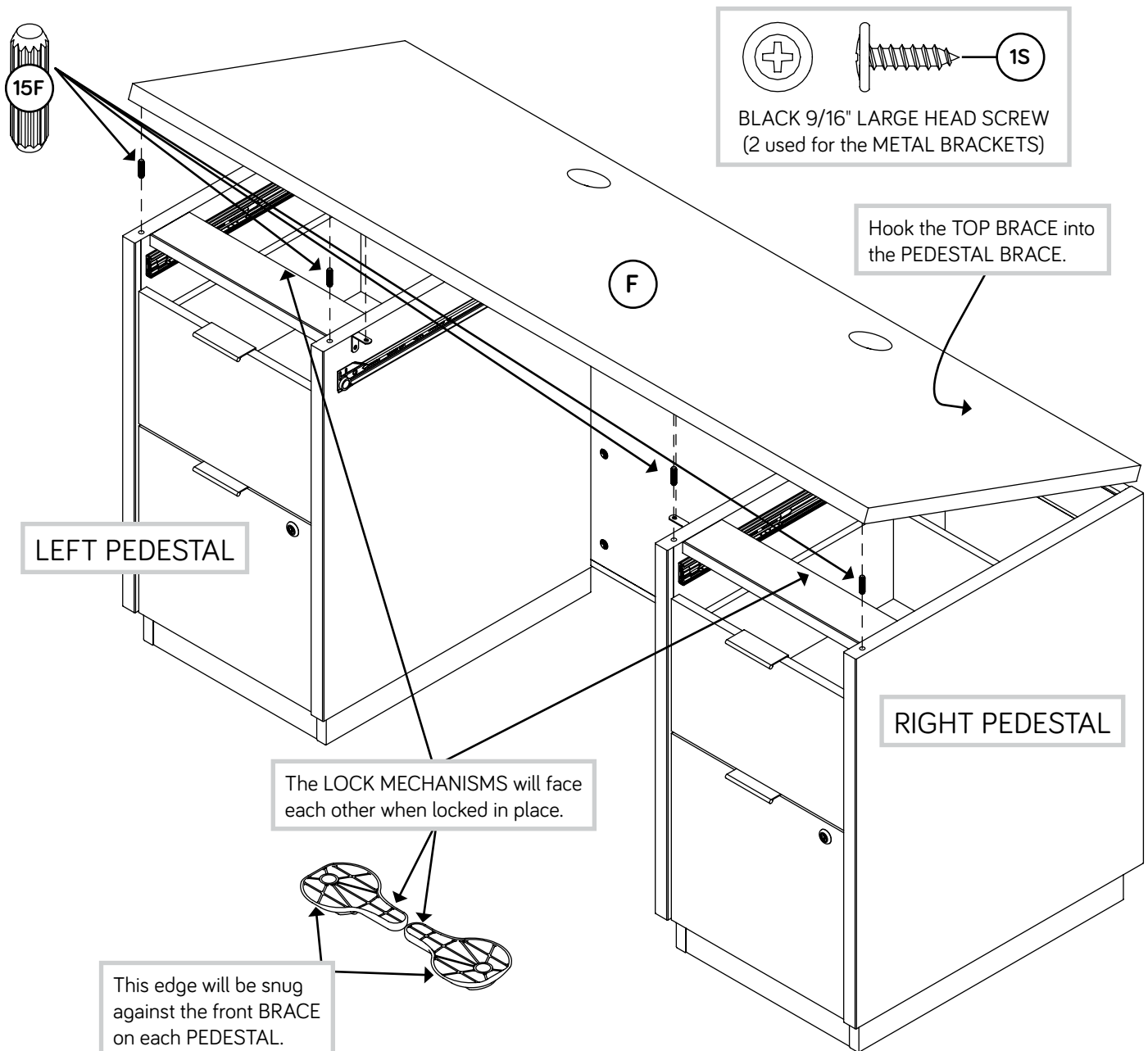

## Step 9

- ✚ To insert the SMALL DRAWER back into your unit, line up the EXTENSION SLIDES on the drawer with the EXTENSION RAILS on the unit and push the drawer into the unit until the drawer is fully inserted. The drawer will push in hard until it is all the way in, then it will slide in and out easier.
- ✚ Pull the LARGE LEFT DRAWER (D) completely open. If necessary, unlock the LARGE DRAWER with the KEY SET (23J).
- ✚ Push a FILE GLIDE (6B) onto the LARGE LEFT DRAWER SIDE.
- ✚ Slide the FILE RODS (8B) into the FILE GLIDE (6B) on the LARGE LEFT DRAWER SIDE.
- ✚ Slide another FILE GLIDE (6B) onto the other end of the FILE RODS (8B), then press this FILE GLIDE over the LARGE RIGHT DRAWER SIDE.
- ✚ Repeat this step for the other LARGE DRAWER (D).

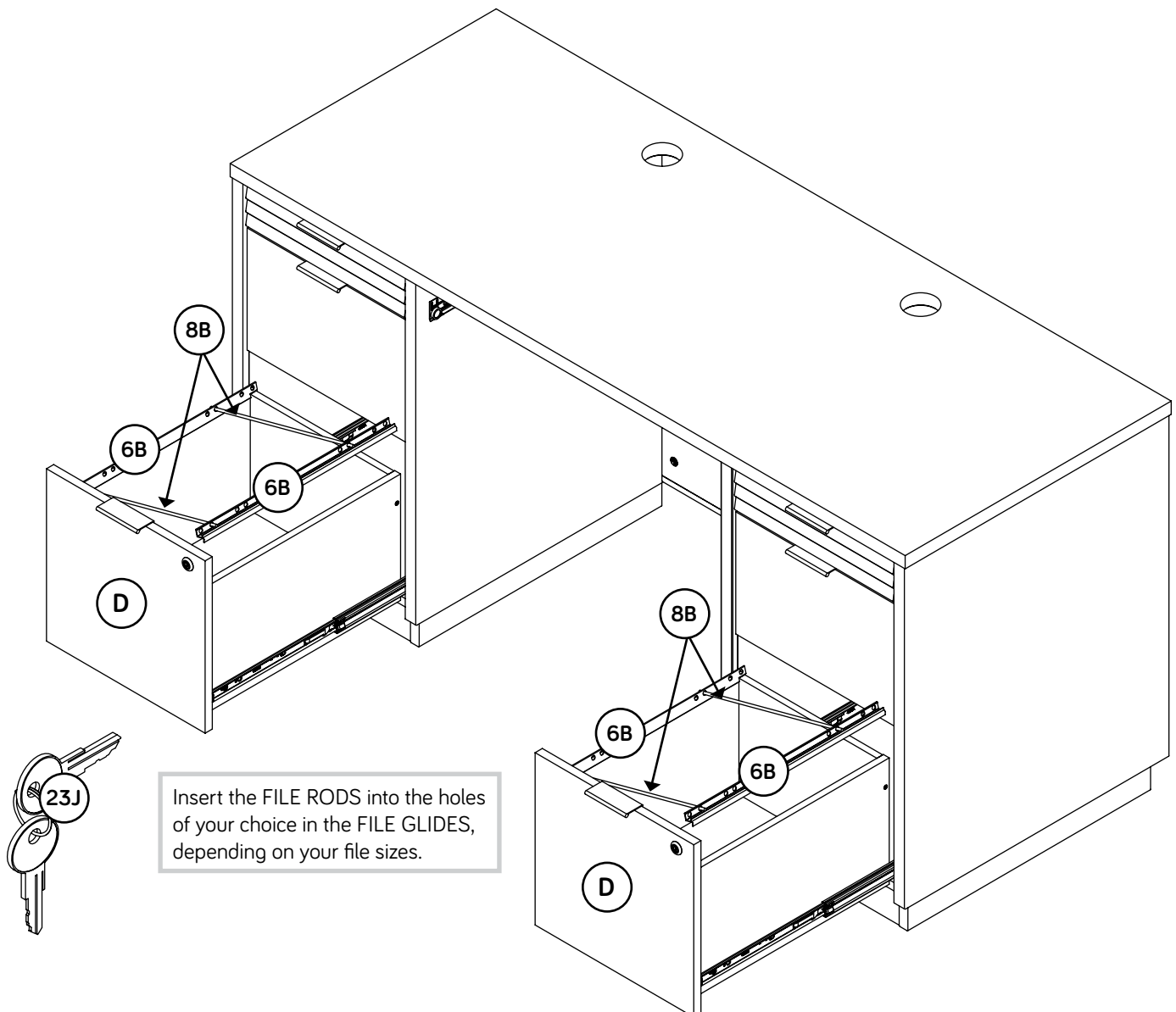

# Step 10

- Fasten the PENCIL DRAWER SIDES (M) to the PENCIL DRAWER BACK (N). Use two SILVER 1-5/8" FLAT HEAD SCREWS (152S).
- Fasten the PULL (21K) to the DRAWER BOTTOM (L). Use two BLACK 9/16" PAN HEAD SCREWS (51S).

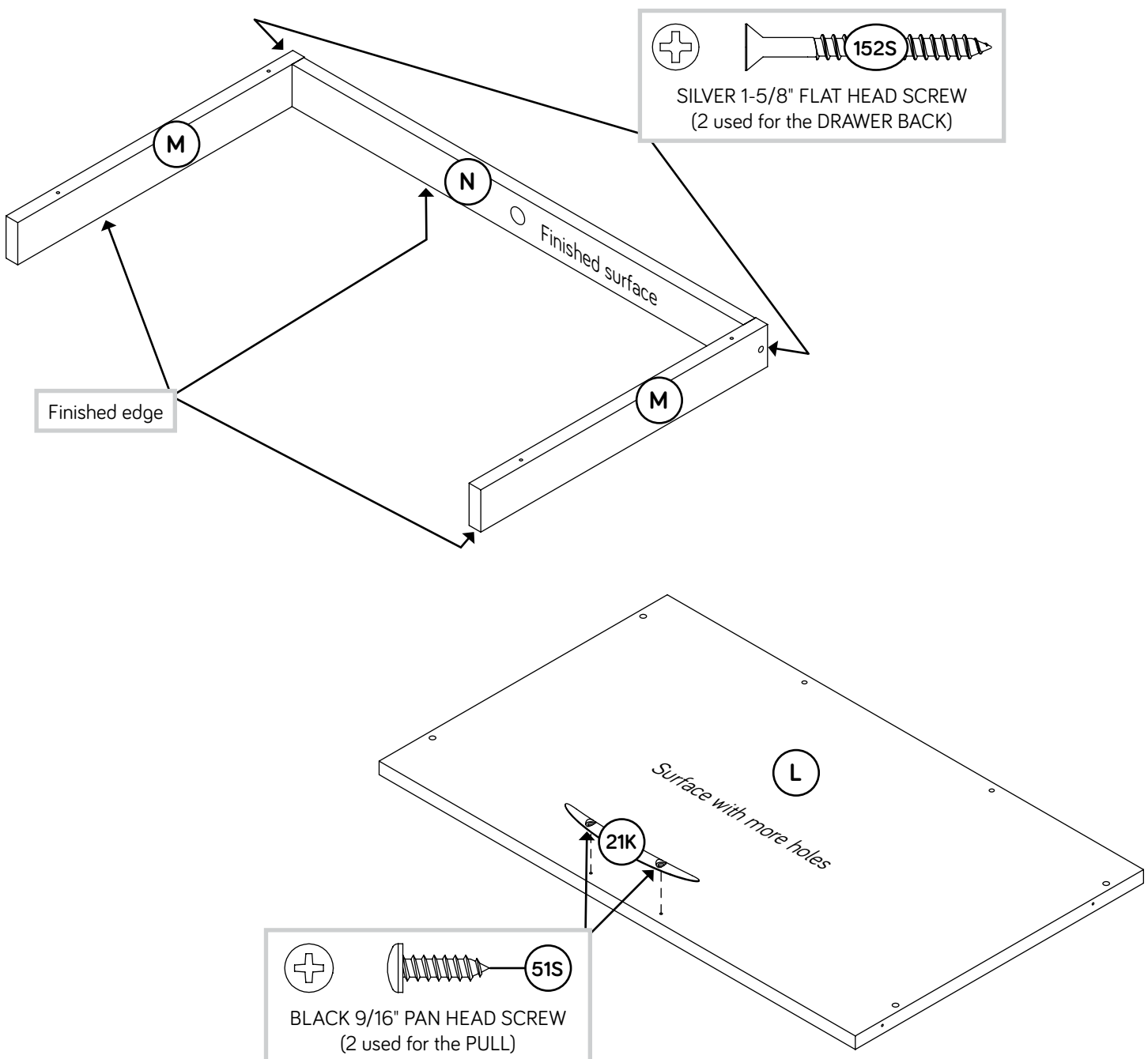

# Step 11

- ✚ Fasten the PENCIL DRAWER BOTTOM (L) to the DRAWER SIDES (M). Use four SILVER 1-5/8" FLAT HEAD SCREWS (152S).
- ✚ Fasten the DRAWER BOTTOM (L) to the DRAWER BACK (N). Use two BLACK 1" FLAT HEAD SCREWS (133S).
- ✚ NOTE: There are no pre-drilled holes in the long edge of the DRAWER BACK (N). Use firm pressure for the SCREWS (133S).

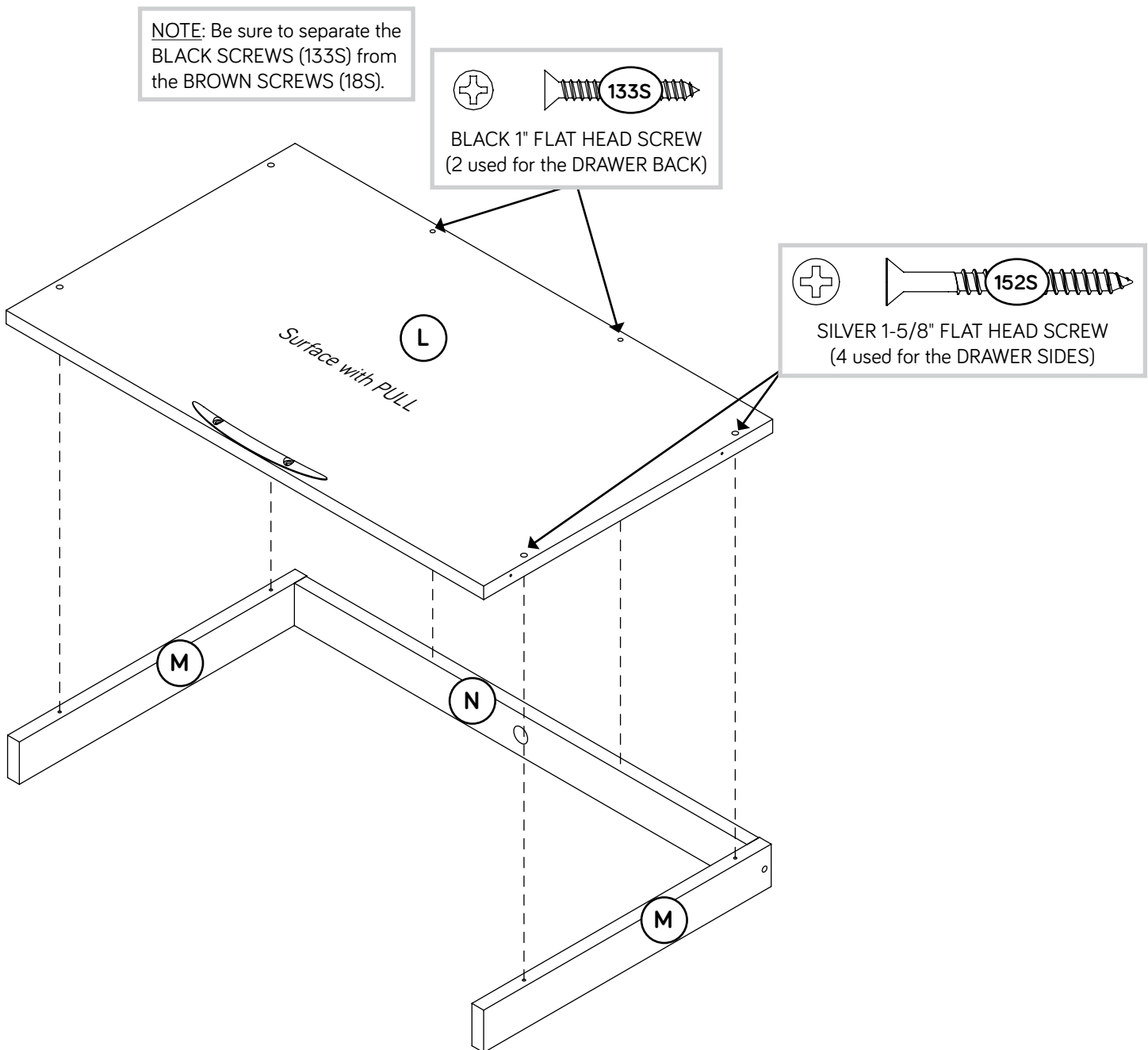



## Step 12

- Fasten the KEYBOARD HINGES (12H) to the PENCIL DRAWER BOTTOM (L). Use two SILVER 9/16" LARGE HEAD SCREWS (54S).
- Fasten the PENCIL FLIP-DOWN FRONT (R) to the HINGES (12H). Use four SILVER 5/8" FLAT HEAD SCREWS (23S).

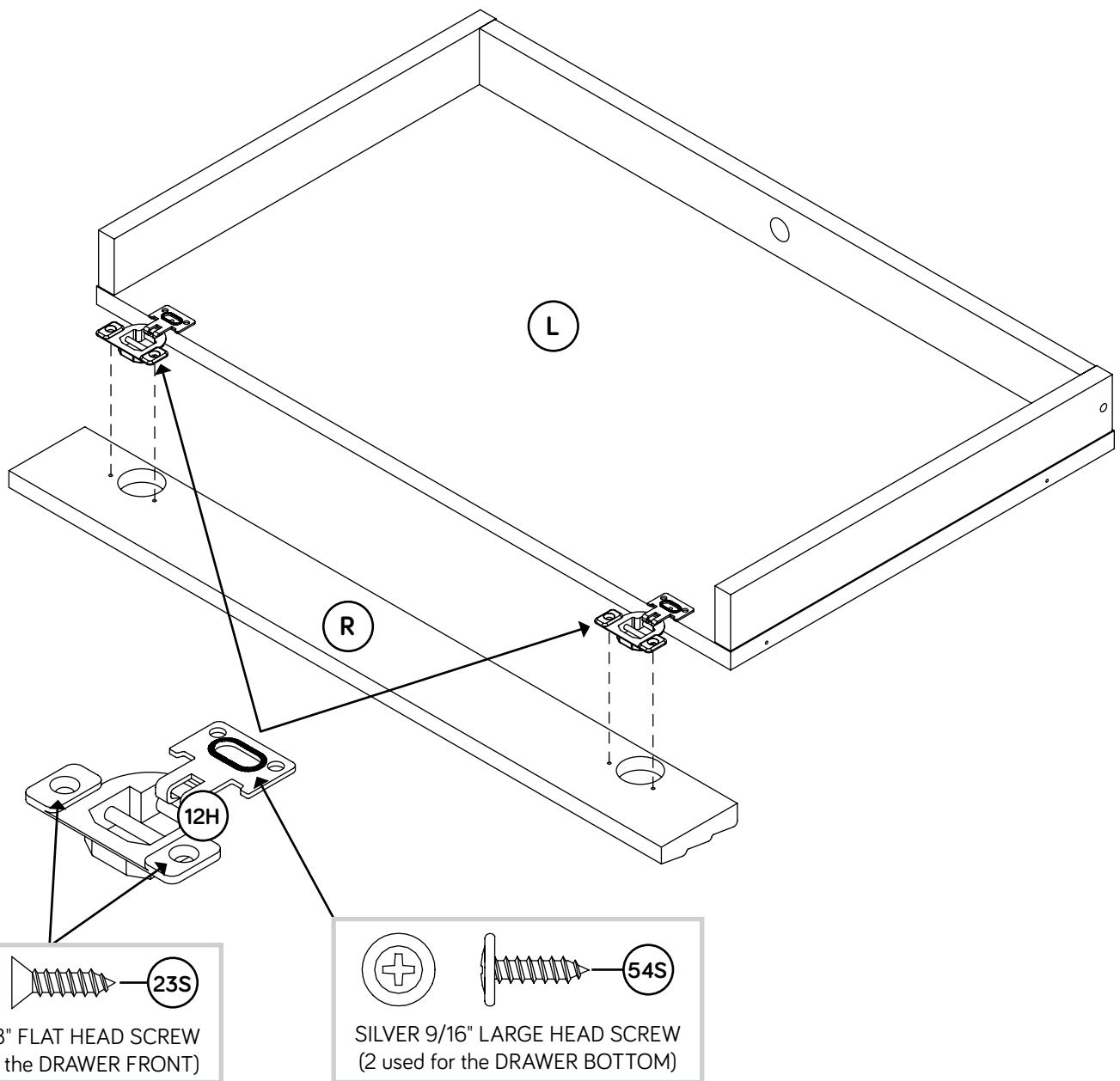

## Step 13

- ✚ Fasten the DRAWER RIGHT (40AY) and the DRAWER LEFT (40AZ) to the PENCIL DRAWER BOTTOM (L). Use four BROWN 1" FLAT HEAD SCREWS (18S).



If you're doing this to help a friend, don't leave without a bite.

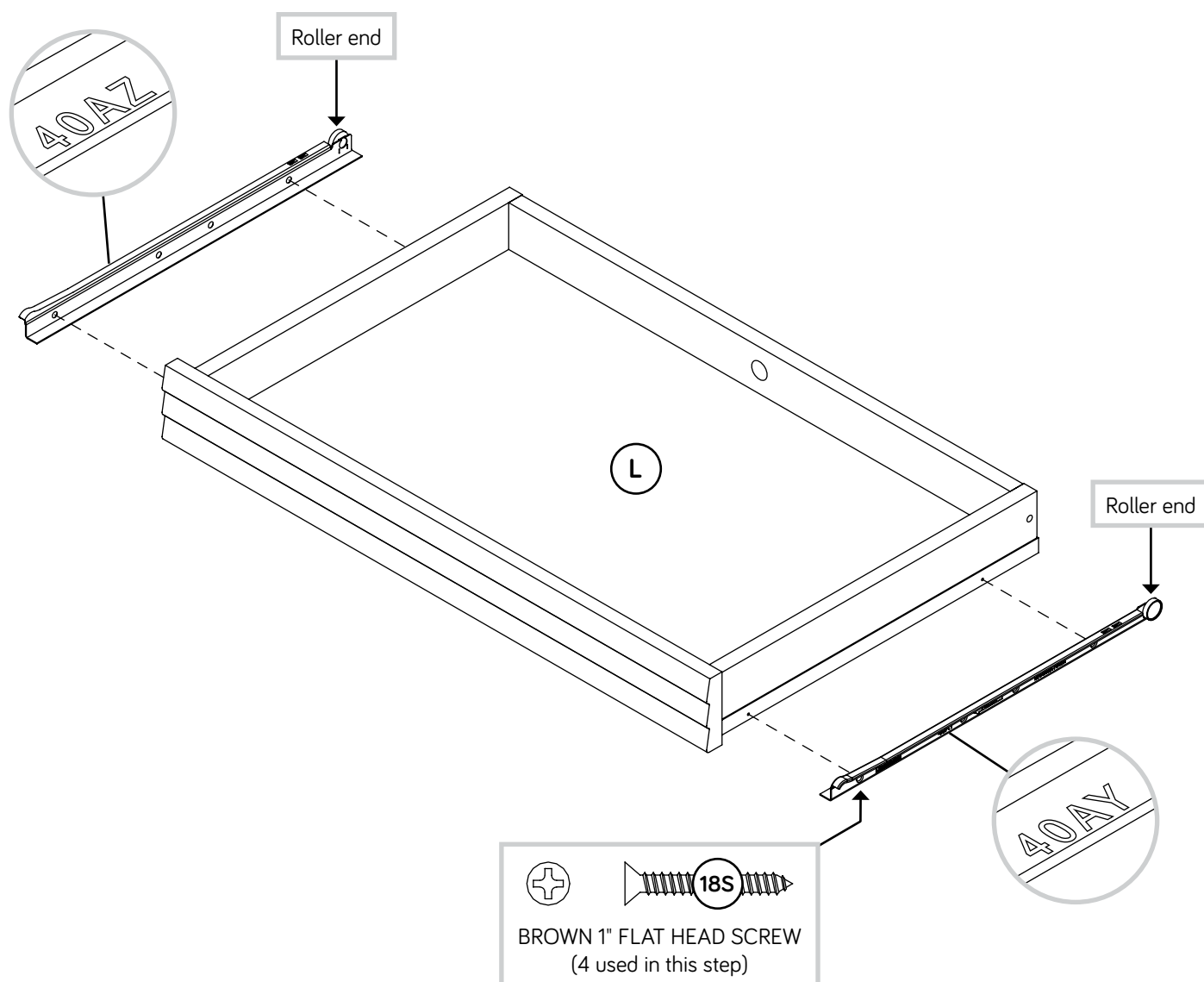

# Step 14

- ✚ To insert the PENCIL DRAWER into your unit, tip the front of the drawer down and drop the rollers on the drawer behind the rollers on the unit. Lift the front of the drawer up and slide it into the unit.
- ✚ Insert a GROMMET (2P) and GROMMET CAP (3P) into each large hole in the TOP (F).
- ✚ NOTE: Please read the back pages of the instruction booklet for important safety information.
- ✚ This completes assembly. Clean with a damp cloth. Wipe dry.

