

## Safety Information

- Keep the device away from water, fire, humidity or hot environments.
- Do not attempt to disassemble, repair, or modify the device.
- Do not use the device where wireless devices are not allowed.
- The socket-outlet shall be installed near the equipment and shall be easily accessible.
- The devices are not intended for use in locations where the temperature may be less than actual room conditions, such as unheated warehouses or garages.
- Plug the product into the wall outlets with earthing connection through the power supply cord.
- Do not cover the power strip while in use. / nicht abgedeckt betreiben.
- Risk of electric shock. Do not plug into another power strip or an extension cord. / nicht hintereinander stecken.
- Timer & Schedule could turn-on unexpectedly without the user being present.
- To Reduce the Hazardous Condition – Unplug the appliance from the socket-outlet before servicing. / spannungsfrei nur bei gezogenem Stecker.

### CAUTION



To fully de-energize the appliance before servicing, unplug it from the receptacle.

Please read and follow the above safety information when operating the device. We cannot guarantee that no accidents or damage will occur due to improper use of the device. Please use this product with care and operate at your own risk.

TP-Link hereby declares that the device is in compliance with the essential requirements and other relevant provisions of directives 2014/53/EU, 2009/125/EC, 2011 /65/EU and (EU) 2015/863.

The original EU declaration of conformity may be found at <https://www.tapo.com/en/support/ce/>

TP-Link hereby declares that the device is in compliance with the essential requirements and other relevant provisions of the Radio Equipment Regulations 2017.

The original UK declaration of conformity may be found at <https://www.tapo.com/support/ukca/>



## Need some help?

Visit <https://www.tapo.com/support/> for technical support, the user guide, FAQs, warranty & more



7106511100 REV1.0.0

©2024 TP-Link



## Quick Start Guide

## Getting Started

### 1. Download Tapo App

Get the **Tapo** app from the App Store or Google Play.



OR



### 2. Power Up & Set Up

Open the Tapo app and tap the + button. Select **Plugs** and then your model. Follow the instructions to complete the setup.

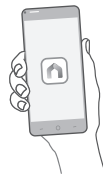



## How to Wall-Mount Your Device

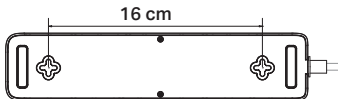

1. Mark the screw hole locations on the wall, with a **16 cm** spacing between the two screws.
2. Use a drill to insert the screws into the marked locations and securely attach the power strip.

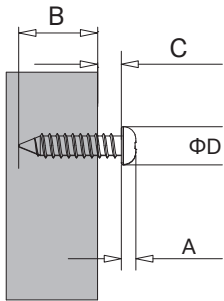

For a smooth installation, use screws with a diameter range of 4-8 mm for the screw cap (**Screw 4# or 6#** recommended).

Note:

- A < 3 mm
- B > 6 mm
- 1.8 mm < C < 2.8 mm
- 4 mm < D ≤ 8 mm

## How to Reset Your Device

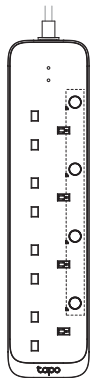

### Power Buttons

- **Reset Wi-Fi Settings Only:**  
Press and hold any power button for **5 seconds**.
- **Factory Reset:**  
Press and hold any power button for **10 seconds**.

### Rating:

250V~, 50/60Hz, 13A General Use;  
250V~, 50/60Hz, 2.0FLA/13LRA\*, Motor Load  
Construction of Switch:Micro-gap Switch(μ)  
\*FLA=Full Load Ampere; LRA=Lock Rotor Ampere

## Supported Load Types

Load Type	Max Current	Max Power (at 250V~)
Iron	13 A	3250 W
Kettle	13 A	3250 W
Heater	13 A	2500 W
Toaster	13 A	2500 W
Coffee Maker	13 A	2000 W
Desk Lamp	0.75 A	80 W
TV	2 A	350 W
PC	3.5 A	600 W
Fan	1.0 A	200 W
Water Pump	3.5 A	735 W(1HP)
Power Adapter/ USB Charger	1.2 A	200 W

### Note:

1. Avoid plugging your appliances with a motor/compressor higher than 1HP, such as an air conditioner. Frequent on/off switching may damage the compressor. You can check the motor/compressor value listed on your appliances or consult their customer support.
2. EV charging is not supported as it demands higher power and a charging current that surpasses the plug's rated capacity.