

NEXTBASE
Dash Cams



Accessories

User Manual

Nextbase Accessories

Your power, your way...

The Nextbase™ Accessories cover everything you might need for video storage, a second vehicle, or to protect your Dash Cam when not in use. The innovative Nextbase™ Module system also allows you to have a second view from your Dash Cam, capturing the road behind you or the interior of your vehicle for extra protection. These products are designed to enhance your recordings and help better cover you in the event of an incident, all with ease of use in mind.



Dash Cam Carry Case

p. 03



SD Cards & Go Packs

p. 03



Cabin View Camera

p. 04 / 05



Rear View Camera

p. 04 / 05



Rear Window Camera

p. 06 / 07



Polarising Filter

p. 08



Hardwire Kit

p. 09 / 10

Nextbase™ Carry Case

The Carry Case is a soft case to safely transport your Nextbase Dash Cam.

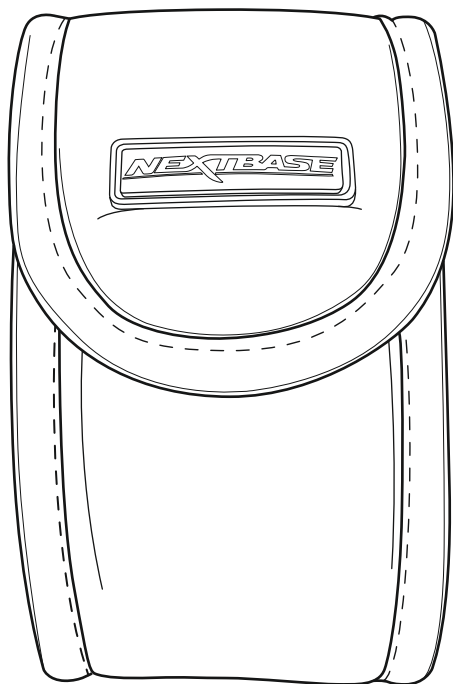

Nextbase™ SD Cards

For best results, we recommend using our Nextbase™ branded SD cards with your Dash Cam, available to purchase online from nextbase.com or your nearest retailer.

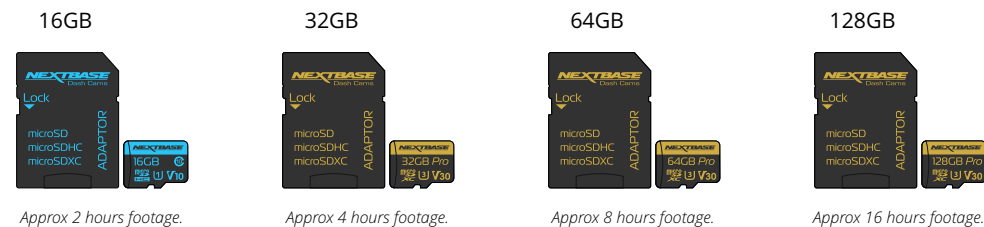

We recommend formatting your SD Card every 2 weeks to ensure that there is enough space to record and store new footage. When formatting, protected files WILL be deleted. If you wish to keep these protected files, you must back them up externally, most commonly by saving files to a desktop computer, or another secure storage point.

To clear your SD card, go to the 'Format SD Card' function in your Dash Cam's Setup settings Menu and follow the instructions on screen.

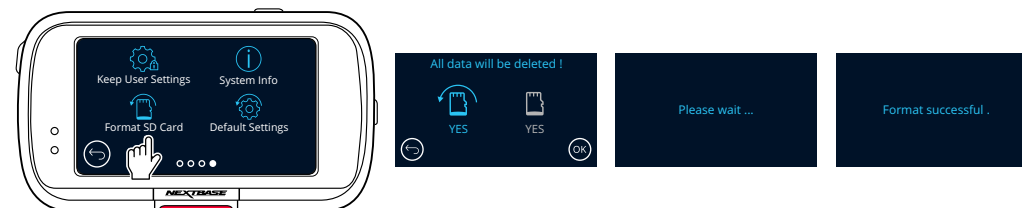

Nextbase™ Go Packs

You can purchase a Carry Case with an SD Card as part of the Nextbase™ Go Pack to get you up and running quickly and smoothly.



Rear View Cameras

Before attaching any Rear View Cameras, ensure that the Dash Cam is switched OFF. Do not turn the Dash Cam ON until the Rear View Camera is securely attached. When a Rear Cam is used with your Dash Cam, a U3 SD-Card is required.

Cabin View Camera

The Cabin View Camera is a compact accessory that neatly attaches to your Dash Cam. The wide 140° angle lens allows you to view and record the interior of your vehicle in addition to the road ahead, providing an extra level of security for you and your passengers.



Suitable for:

122	✗	422	✓
		GW	
222	✗	522	✓
		GW	
322	✓		
GW			



Rear View Camera

The Rear View Camera is a compact accessory that neatly attaches to your Dash Cam to allow you to view and record out of the rear of your vehicle in addition to the road ahead, making sure you're protected against tailgaters and rear-end impacts.



Suitable for:

122	✗	422	✓
		GW	
222	✗	522	✓
		GW	
322	✓		
GW			

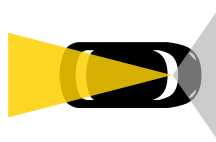

Installation and Positioning:

Simply plug the Rear View Camera into your Dash Cam using the socket on the right hand side, ensuring that the lens is facing backwards, into your vehicle.

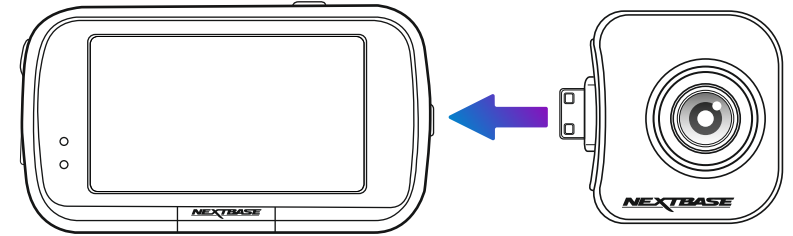

When adjusting the angle of the lens, to avoid damaging components in the cameras, use both hands to steady the Rear View Camera. Where possible, adjust the lens position on the Rear View Camera before attaching to your Dash Cam.

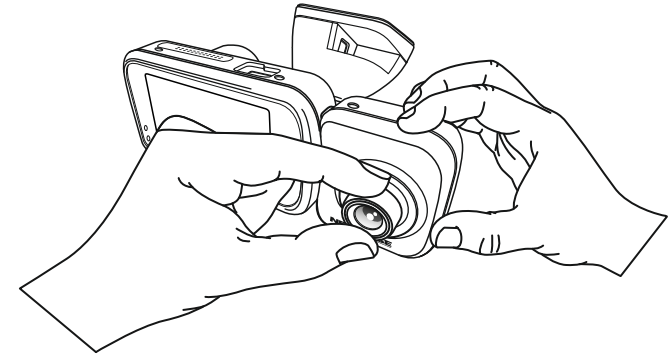

Below is a suggested position for your Dash Cam with Rear View Camera attachment. Ensure that both the Dash Cam and Rear Facing Camera's lines of sight are unobstructed by in-car objects, such as the rear view mirror.

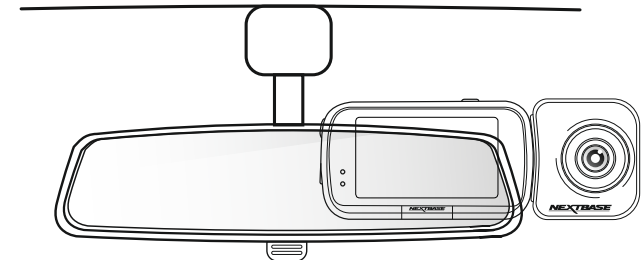

Rear View Display and Screenshots



When the Dash Cam is turned on with a Rear View Camera connected, you will see a Picture in Picture (PiP) to the centre left of the screen, showing the attached camera's view.



Tapping on the PiP window opens the Rear View in full screen. Tapping again minimises the Rear View back down to PiP.



When 'Reversing Camera' is turned ON in the menu system, the full screen Rear View is flipped to mimic the rear view mirror.



Screen Capture:
If a Rear Cam is attached, touch the centre of the Front Facing view (yellow dotted area, left) to take a photo. This will save 2 photos, one from the Front Facing camera, and one from the Rear Facing camera.

Resolutions:

The resolution of your Rear Cam is dependent on the resolution settings on your Dash Cam. These figures vary through the 322GW, 422GW, and 522GW; check the instruction manual of the relevant model for details regarding resolution settings.

Audio Recording:

With a Rear Camera attached the Dash Cam will record 2 separate video streams, one from the Front Facing camera, and one from the Rear Facing Camera; however, as the rear cameras do not have built-in microphones, audio is only recorded from the Dash Cam (i.e. Front Facing camera). This audio is applied to recordings from both the Front and Rear cameras.

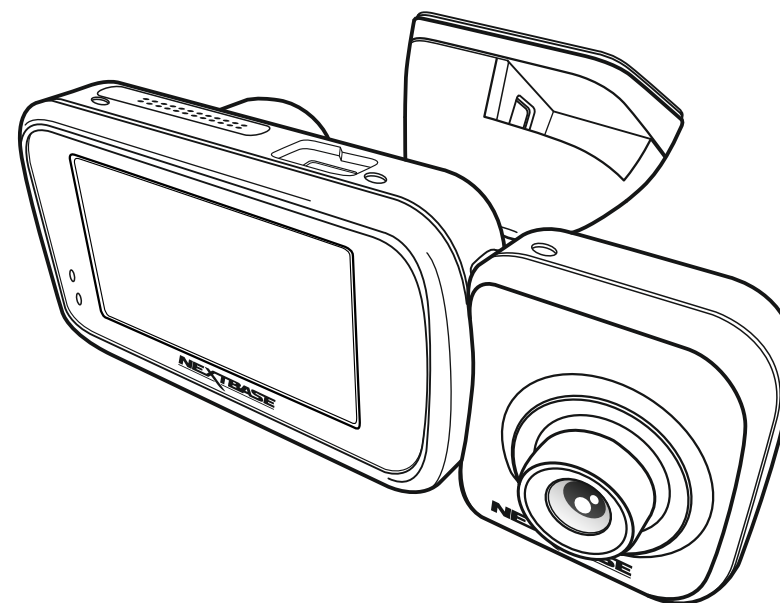

Rear Window Camera

Before attaching any Rear View Cameras, ensure that the Dash Cam is switched OFF. Do not turn the Dash Cam ON until the Rear View Camera is securely attached. When a Rear Cam is used with your Dash Cam, a U3 SD-Card is required.

The Rear Window Camera is an additional compact camera that affixes to the rear window of your vehicle, allowing you to record the road behind you as well as the road ahead, capturing everything from tailgaters to rear-end impacts.

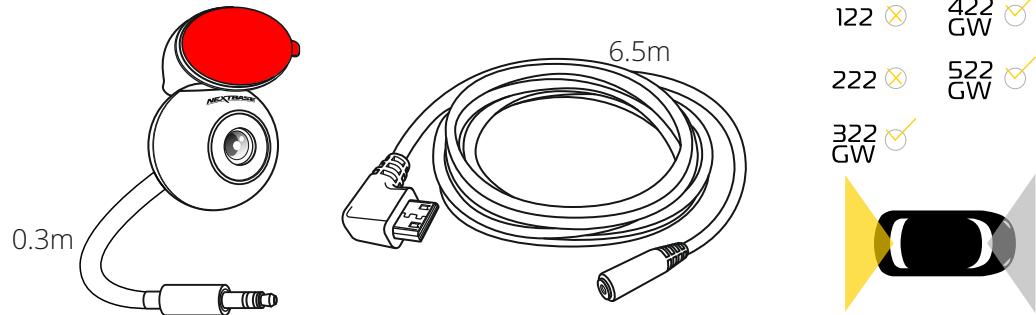

Connect the Rear Window Camera to the lead, and the lead to the Dash Cam.

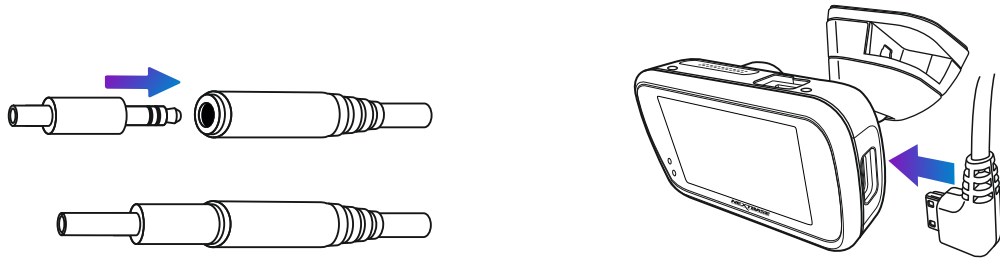

Place the magnetic, adjustable mounting fixture (1) on top of the camera. The changeable angle (2) allows for the Rear Window Camera to be mounted on both slanted car windows, and vertical van windows. See next page for installation notes and instructions.

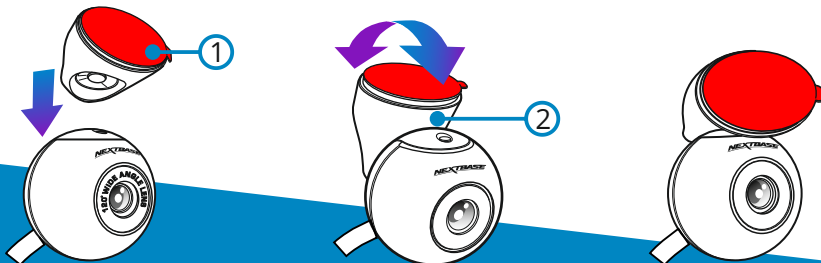

When the Dash Cam is turned on with a Rear View Camera connected, you will see a Picture in Picture (PiP) to the centre left of the screen, showing the attached camera's view.

Tapping on the PiP window opens the Rear View in full screen. Tapping again minimises the Rear View back down to PiP.

When 'Reversing Camera' is turned ON in the menu system, the full screen Rear View is flipped to mimic the rear view mirror.

When A Rear View Camera is attached, 4 files are produced per recording. As well as the standard High and Low Resolution Files (Forward Facing), there will also be High and Low Resolution Files (Rear Facing). The smaller file size of the low quality video means it is quicker to transfer and edit within the app.

Resolutions:

The resolution of your Rear Cam is dependent on the resolution settings on your Dash Cam. These figures vary through the 322GW, 422GW, and 522GW; check the instruction manual of the relevant model for details regarding resolution settings.

Audio Recording:

With a Rear Camera attached the Dash Cam will record 2 separate video streams, one from the Front Facing camera, and one from the Rear Facing Camera; however, as the rear cameras do not have built-in microphones, audio is only recorded from the Dash Cam (i.e. Front Facing camera). This audio is applied to recordings from both the Front and Rear cameras.

Rear Window Camera (continued)

Installation:

Make sure your Dash Cam is mounted securely on the windshield of your vehicle, in the position you use day-to-day. Connect the Rear Window Camera to the Dash Cam using the 6.5 m connecting cable, and run it through your vehicle to the rear window, stowing the cable within the headlining, using the Nextbase™ Cable Tidy Tool (included with your Dash Cam) if necessary. The end of the cable should emerge from the

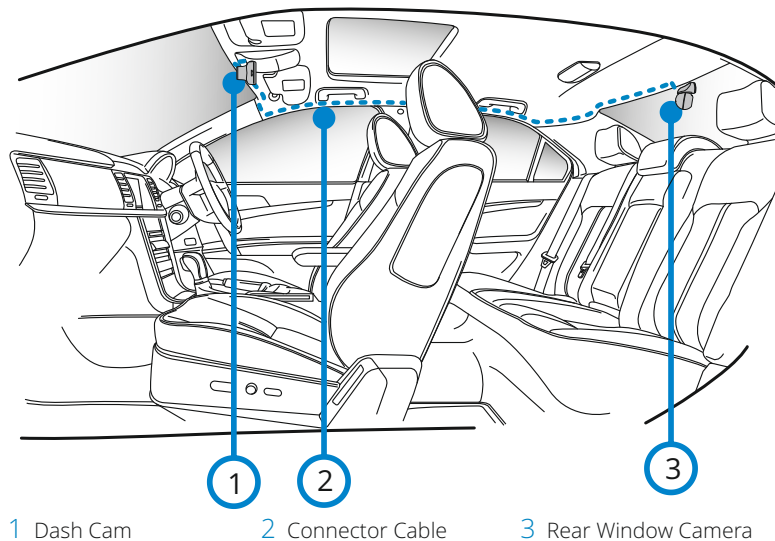

The above diagram is for illustration purposes only.

Hiding the Cable:

Make sure the hanging cable does not obstruct your view out of your rear window. Ensure that there are no kinks in the cable as you are stowing it. If necessary, use the cable tidy tool supplied with your Dash Cam; this can be used to help pry open the lining of your car (see illustration below, right).



Installation Notes:

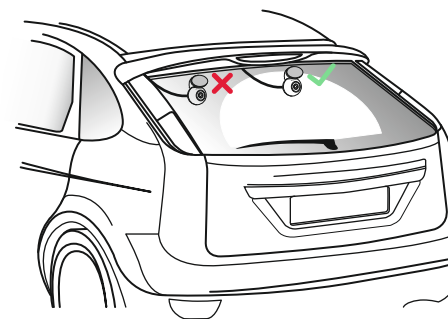

Camera Placement:

It is advisable to place the rear racing camera within the wiper zone towards the top of your rear window in order to record the clearest possible image. Ensure that the view is not obstructed by heating grid lines.

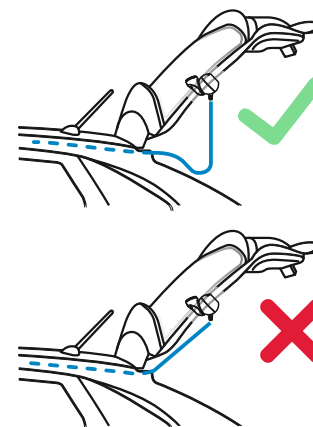

Opening the Boot:

Leave around 30-40cm of slack at the rear of the vehicle to ensure that there is enough cable to comfortably open the boot without dislodging the Rear Window Camera.

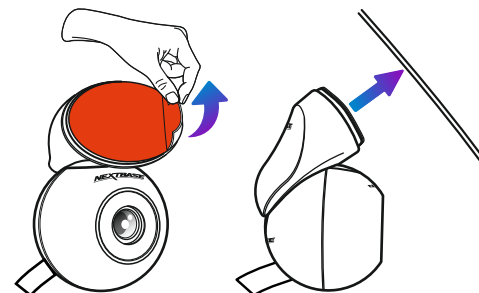

Apply to Rear Window:

When you have found a suitable area, with an unobstructed view and enough slack to allow the boot to open, remove the backing plastic from the magnetic mount fixture and carefully apply it to your rear window. When it is in place, you can adjust the positioning of the camera using the Dash Cam display to ensure you are capturing the intended area behind you. You may want to ask someone else to assist you in this part.

Polarising Filter/Reflection Free Lens

The Polarising Filter is designed to reduce the glare on your windscreen as seen through the Dash Cam, allowing you to record the road ahead clearly. In bright sunlight the filter will also enhance the colour and contrast levels to help capture important number plate details. The 522GW Dash Cam model already has a built-in polarising filter.

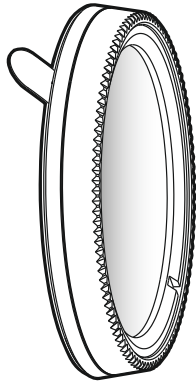

Suitable for:

122 ✓	422 GW ✓
222 ✓	522 GW ✗
322 GW ✓	

Remove the adhesive layer on the back of the Polarising Filter, and apply the filter to the front of the Dash Cam lens, making sure that the text ("140° Wide Angle Lens") is at the top of the lens. Also ensure that you remove the protective layer over the lens before using your Dash Cam.

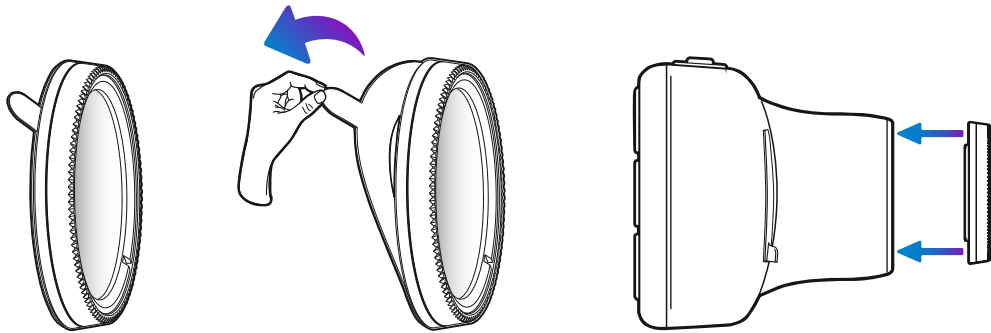

Adjusting the Polarising Filter:

The most effective way to set up your Polarising Filter (1) is to place a piece of plain white paper (2) on your dashboard (3) under the rear view mirror. With your camera turned ON you will see the reflection (4) of the paper in the LCD screen of the Dash Cam. Look at the reflection (4) on the windscreen through the Dash Cam display (5).

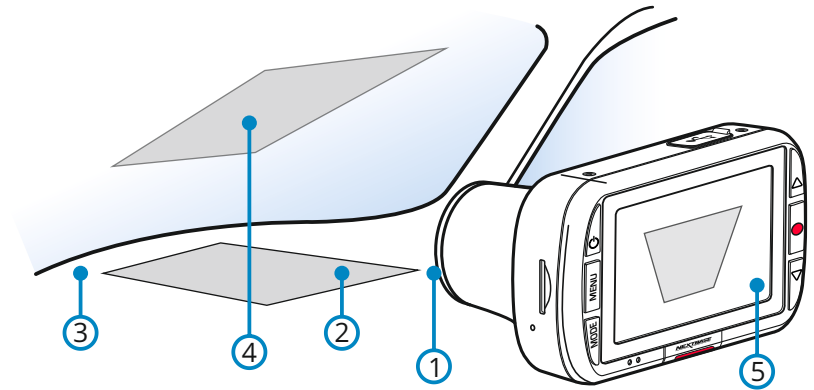

Gently rotate the front bezel to adjust the filter. Rotate the filter until the windscreen reflection is as hidden as possible on the Dash Cam display (see below).

Once the reflection can no longer be seen, operate the Dash Cam normally. Please note; it may not be possible to fully remove the reflection, but using the Polarising Filter will noticeably improve your video quality.

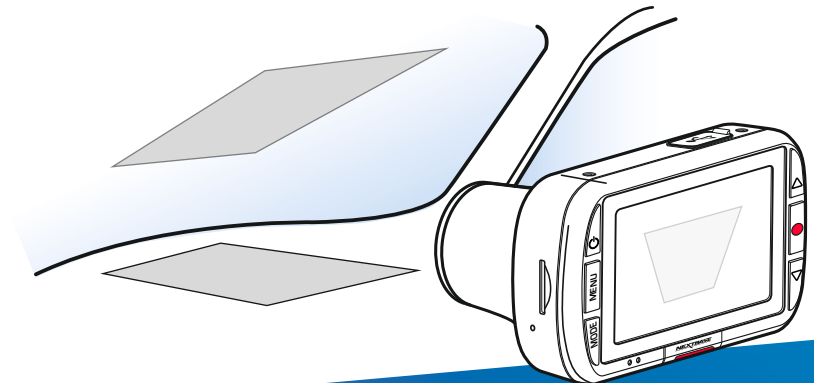

The above diagram is for illustration purposes only.

Hardwire Kit

For use with all Nextbase™ Dash Cam models. These instructions provide the necessary information to install the Dash Cam Hardwire Kit properly and safely within your vehicle. Before beginning the installation process, please read these instructions carefully. It is recommended for normal journey video recording, the Hardwire Kit is connected to a switched power supply. This means that power is supplied to the Dash Cam ONLY when the vehicle's ignition is turned on. A permanent live (un-switched) connection is only required when the Dash Cam is to be used when the vehicle is not in use, i.e. for surveillance purposes. The Dash Cam will operate normally until the vehicle's battery drops below the minimum voltage cut-off level; this minimum voltage cut-off is 11.0Vdc for a 12Vdc battery and 23.0Vdc for a 24Vdc battery. This protects the vehicle's battery.

If in any doubt, please consult a vehicle technician prior to starting installation.

Suitable for:

122 ✓	422 ✓
222 ✓	522 ✓
322 ✓	GW ✓

Safety Precautions:

- Perform the installation with the ignition in the OFF position.
- Do not strip any live wires.
- Correct electrical polarity and grounding is required for safe and proper installation.
- Only connect to a negative ground DC supply circuit.
- Not for installation to positive ground circuits.

Warnings:

- Failure to use the supplied installation parts and/or hardware will void the product warranty.
- Failure to connect the product as instructed may result in discharge of the vehicle battery.
- Failure to follow these safety precautions and instructions could result in damage to the product and/or vehicle, which will not be covered under the product warranty or the manufacturer's warranty.

Camera Power Cable

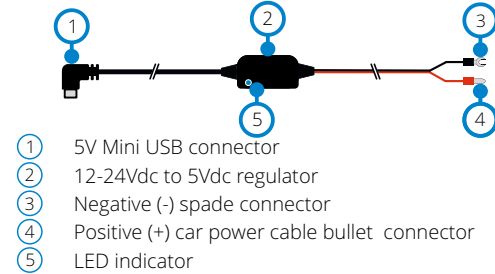

Fuse Tap Cables

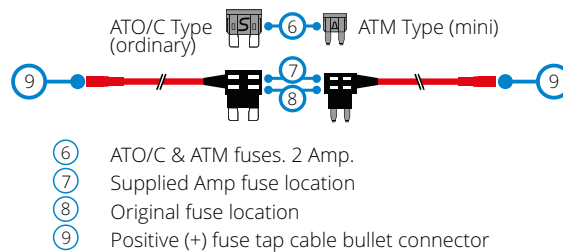

Note: For Micro (Low Profile Mini) Fuses, see item 1.3 overleaf.

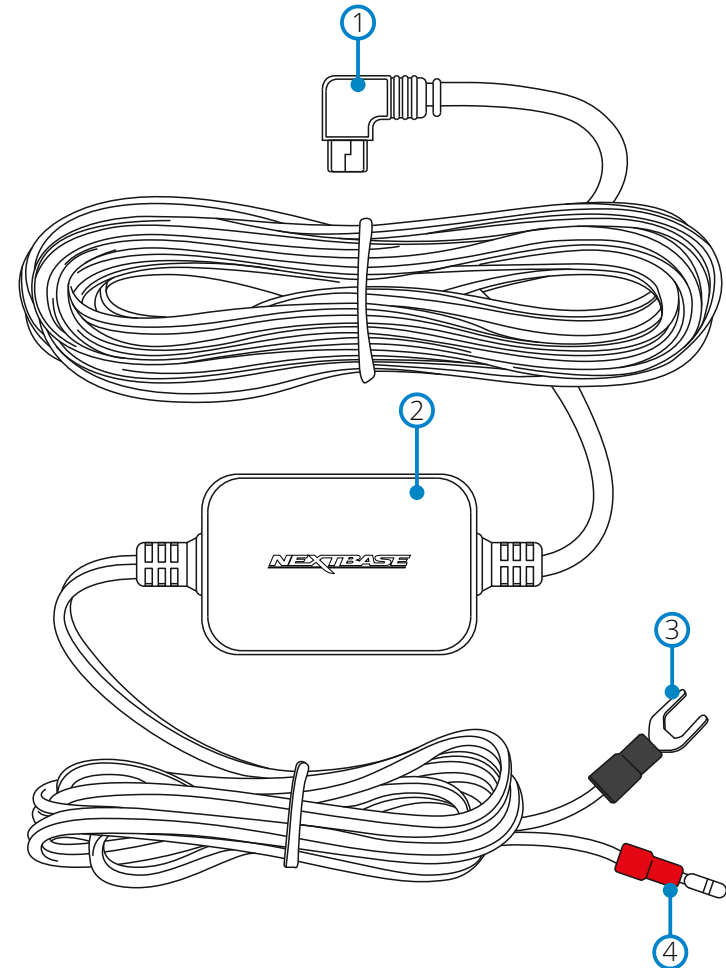

Hardwire Kit (cont.)

Installation

1 Connect the supplied 'Fuse Tap Cable' to the vehicle's fuse box.

1.1 Locate the fuse box within your vehicle. This is usually within the passenger compartment but it may be in the engine bay. Typically there will be a chart detailing the fuse layout within the fuse box, or this will be listed in the vehicle operating manual.

1.2 Select a fuse which is associated with a function within the vehicle which can only be used when the ignition is turned on, this is known as 'switched' power source. This could be the vehicles 'heated rear window', as an example. Mark down the position of this fuse carefully for future reference, remove the selected fuse from the fuse box.

Note: The rating of the 'original fuse' that is being removed is of no importance, however it is recommended that the maximum rating is no more than 20 Amps.

1.3 Select the required Fuse Tap Cable from the two supplied types. This depends on whether the original fuse was of the larger ATO/C or smaller ATM type. The 2 Amp fuse required to protect the Dash Cam is already installed within the Fuse Tap Cable and should NOT be changed. Insert the original fuse from the vehicle in to the available location upon the Fuse Tap Cable, this will be the 'original fuse location', as shown overleaf. Now insert the Fuse Tap Cable in to the fuse box, at the position where the original fuse was removed from, as noted in Item 1.2 above.

Note: If the fuse removed from your vehicle is a Micro (low profile mini) fuse type, then you can still use the ATM (Mini) fuse tap cable. You will however need to source yourself another ATM (Mini) fuse, of the same rating as the fuse that you removed originally. Place the new ATM (Mini) fuse into the 'original fuse location'. At this stage, if you have a multi-meter, you can check for 12-24Vdc at the end of the Fuse Tap Cable. A voltage should only be present when the vehicle's ignition is turned on (or connected to a permanent live). There is an LED on the regulator housing to indicate if the Fuse Tap Cable has been wired correctly (see below).

LED Indicator

If there is no power to the Hardwire Kit the LED will not be turned on.



No LED

No power OR
battery protected

Once power is flowing to the Hardwire Kit, the Led will turn on. If there is no Dash Cam connected, it will flash



Flashing LED

Power established, NO
Dash Cam connected

If there is a Dash Cam connected, the LED will remain on.



Solid LED

Power established,
Dash Cam connected

2 Installing the Camera Power Cable

2.1 Installation of the camera power cable needs careful planning for the cable run and the final position of the Dash Cam within the vehicle. See the Dash Cam manual for optimum camera position. Study the vehicle for the most appropriate cable run towards the fuse box, especially if this requires passing through the bulkhead in to the engine bay.

2.2 Starting from the Dash Cam end of the cable (with the mini USB plug) tuck the cable under the vehicle headlining, the 'A' post trim and side panel trim until the cable exits towards the footwell. Use a Cable Tidy Tool supplied with your Series 2 Dash Cam to loosen any trim and hide the cable as necessary. Make sure there is still sufficient cable available to connect to the Dash Cam, when installed correctly upon it's windscreen mount.

2.3 Continue to route the cable towards the fuse box. Once close to the fuse box, take the black wire (negative) from the Car Power Cable and find a suitable position to attach the spade connector to the vehicle bodywork. Normally a screw can be removed and refitted with the spade connector underneath. Take the red wire (positive) from the Car Power Cable and locate the red bullet connector at the end. This plugs directly in to the female bullet connector of the Fuse Tap Cable.

2.4 Tidy any excess cable using cable clips and secure the cable to a convenient location to prevent rattles. Replace any removed trim from the vehicle and the fuse box cover, as required.

2.5 A Ferrite Core is supplied with the Hardwire Kit. This can be used to suppress any interference which may be heard upon FM or DAB radio. Clip the Ferrite Core to the Camera Power Cable at a distance of approximately 20cm from the camera for best effect, if required.

Note: In the unlikely event that the installation of the Hardwire Kit should require drilling of holes, the installer MUST be sure that no vehicle components or other vital parts could be damaged by the drilling process. Check both sides of the area before drilling begins. De-burr any holes and remove any metal remnants. Install a rubber grommet into any cable passage holes, before passing cables through.

Should you experience any difficulties during installation please do not hesitate to contact our technical support team

support@nextbase.com

Accessory Model Compatibility



122



222



322GW



422GW



522GW



Carry Case

Yes

Yes

Yes

Yes

Yes



**Nextbase Module Cam Compatible
(Rear Cam, Rear Facing Cam)**

No

No

Yes-Front 1080p
Rear 720p

Yes-Front 1440p/1080p
Rear 720p/1080p

Yes-Front 1440p/1080p
Rear 720p/1080p



Rear Window Camera Bracket

No

No

Yes

Yes

Yes



Polarising Filter

Yes

Yes

Yes

Yes

Comes as standard



Hardwire Kit

Yes

Yes

Yes

Yes

Yes



SD Cards

Yes

Yes

Yes

Yes

Yes

*Our eyes on the road,
you mind on the journey.*



NEXTBASE

Dash Cams



www.nextbase.com

