

# MARTIN



CHARACTERISTICS

<p>MELAMINE PANELS</p>	<p><b>Standard melamine in White or Light oak</b>                  Melamine-covered particle board panels (19 mm thick) with an anti-reflective coating on both sides.                  Panel density 620 to 690 kg/m3.                  Flat edge banding (2 mm thick) made from a strip of glued ABS with rounded upper and lower edges. Edging in the same finish as the worktop.</p> <p><b>Soft-touch melamine in Black velvet</b>                  Melamine-covered particle board panels (19 mm thick) in a Black soft-touch matt finish with a high-quality multi-layer coating.                  Black flat edge banding (1 mm thick), made from a strip of glued ABS.</p> <p>Panels sourced from sustainably managed forests (PEFC).                  Panels have a fire-resistance rating of M3 (combustible, moderately flammable) as per standard NF EN 13501-1.                  Panels have a formaldehyde emissions rating of E1, emitting 6.5 mg HCNO/100 mg, and comply with standard NF EN 717-2.</p>
<p>METAL STRUCTURE</p>	<p>&gt; Square-section metal frame (30 x 30 mm, 2 mm thick), which can be used to move the unit.                  &gt; Fitted with:                  - 4 castors (Ø 75 mm), including 2 with brakes                  - 2 metal cable-tidy cleats (one on each side)</p>
<p>POWER &amp; CABLE MANAGEMENT</p>	<p>Power solution for the wall:                  &gt; With blank cable grommet, or optional connectivity solution through circular socket port in the front panel, plus 1.5 metre cable                  &gt; Cable port for routing cables</p>
<p>MONITOR BRACKET</p>	<p>Bracket for flatscreen monitors up to 55 inches                  VESA: 100 x 100 to 800 x 400                  Maximum load: 60 kg                  Finish: Black</p>



Made in France

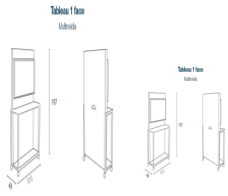
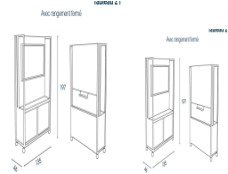

PRODUCT DETAILS

<p>Multimedia wall (Single-sided unit)</p> 	<p>&gt; <b>Front:</b></p> <ul style="list-style-type: none"> <li>- Melamine panel with 2 cable routing holes (Ø 80 mm) behind and below the flatscreen monitor</li> <li>- Flatscreen monitor bracket</li> <li>- Power socket or cable grommet</li> <li>- Shelf (depth 280 mm)</li> </ul> <p>&gt; <b>Back:</b></p> <ul style="list-style-type: none"> <li>- Melamine panel (attached by cleats to keyhole slots) that can be removed to access the cables and optional socket outlets installed within the structure</li> </ul>
<p>Wall + closed storage compartment (Double-sided unit)</p> 	<p>&gt; <b>Front:</b></p> <ul style="list-style-type: none"> <li>- Melamine panel with 2 cable routing holes (Ø 80 mm) behind and below the flatscreen monitor</li> <li>- Flatscreen monitor brackets</li> <li>- Power socket or cable grommet</li> <li>- Cupboard with sliding doors: key-operated lock, vertical partition</li> </ul> <p>&gt; <b>Back:</b></p> <ul style="list-style-type: none"> <li>- Melamine panel (attached by cleats to keyhole slots) that can be removed to access the cables and optional socket outlets installed within the structure</li> <li>- Dry-erase whiteboard with a magnetic metal strip at the top and a pen tray at the bottom</li> </ul>
<p>Wall + open storage compartment (Double-sided unit)</p> 	<p>&gt; <b>Front:</b></p> <ul style="list-style-type: none"> <li>- Melamine panel with 2 cable routing holes (Ø 80 mm) behind and below the flatscreen monitor</li> <li>- Flatscreen monitor bracket</li> <li>- Cable grommet or optional power socket</li> <li>- Open storage compartment with clip-on straps to secure 3 ZELIE footstools (with stabiliser feet or castors)</li> </ul> <p>&gt; <b>Back:</b></p> <ul style="list-style-type: none"> <li>- Melamine panel (attached by cleats to keyhole slots) that can be removed to access the cables and optional socket outlets installed within the structure</li> <li>- Dry-erase whiteboard with a magnetic metal strip at the top and a pen tray at the bottom</li> </ul>

DIMENSIONS

	Multimedia wall (single-sided unit)	Multimedia wall + closed storage compartment (double-sided unit)	Multimedia wall + open storage compartment (double-sided unit)
			
Height	1965	1965	1965
Depth	460	460	460
Width	1167	1350	1350
Height of shelf/ storage compartment top	897	735	735
Maximum monitor size	47 inches	55 inches	55 inches

Made in France



Multimedia wall (single-sided unit)

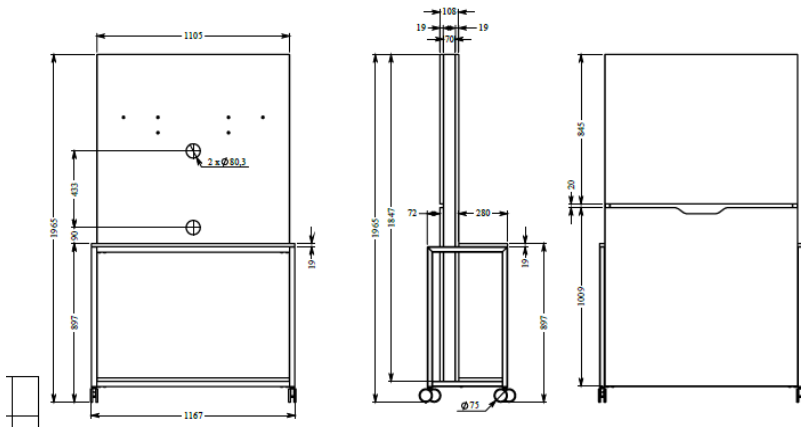

Multimedia wall + closed storage compartment (double-sided unit)

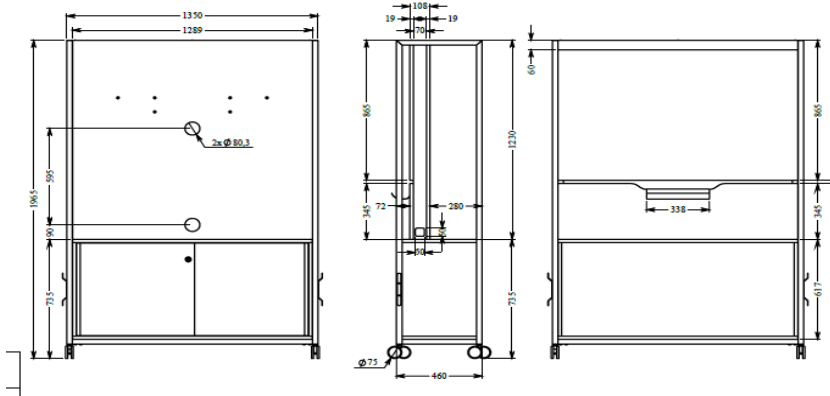

Multimedia wall + open storage compartment (double-sided unit)

